



Nuevo Road Widening (Evans Road to El Nido Avenue/Ravena Lane) Project

Post Date: 06/04/2019 15:47 PDT

Due Date: 07/10/2019 before 14:00 PDT

Estimated Value: \$1,700,000

Results / 6 total

#	Name	Company	Address	Phone	Amount	Submitted	Status
1	Carrillo, Erica	Hillcrest Contracting, Inc.	1467 Circle City Dr. Corona, CA 92879	951-273-9600	\$1,580,467.4	07/10/2019 13:58:37	Apparent Low Bidder
2	Chizhik, Gennady	GMC Engineering, Inc.	1401 Warner Ave. B Tustin, CA 92780	(714) 247-1040	\$1,591,044	07/10/2019 13:58:46	
3	Maness, Carolyn	Granite Construction Company	38000 Monroe Street Indio, California 92203	760775-7500	\$1,591,951	07/10/2019 13:58:10	
4	Lovetere, Katherine	Griffith Company	12200 Bloomfield Ave Santa Fe Springs, California 90670	5629291128	\$1,714,399.79	07/10/2019 13:52:05	
5	De longh, Jennifer	R.J. Noble Company	15505 E. LINCOLN AVENUE ORANGE, CA 92865	714-637-1550	\$1,722,366.1	07/10/2019 13:52:13	
6	Bird, Kim	All American Asphalt	400 E 6th St. Corona, CA 92878-2229	(951) 736-7600	\$1,777,000	07/10/2019 13:58:26	

NUEVO ROAD WIDENING

Item Description	Bid Schedule 1	Item Qty	Unit	Hillcrest Contracting		GMC		Granite	
				Unit Price	Total	Unit Price	Total	Unit Price	Total
1 Mobilization	Protect Improvements in Place. Adjust to grade, relocate and/or replace all existing improvements in conflict	1.00	LS	\$ 56,100.00	\$ 56,100.00	\$ 137,000.00	\$ 137,000.00	\$ 70,000.00	\$ 70,000.00
2 Excavation and earthwork, clearing & grubbing	Excavation and earthwork, clearing & grubbing	1.00	LS	\$ 4,500.00	\$ 4,500.00	\$ 19,365.00	\$ 19,365.00	\$ 500.00	\$ 500.00
3 Environmental compliance	Environmental compliance	1.00	LS	\$ 342,000.00	\$ 342,000.00	\$ 248,208.00	\$ 248,208.00	\$ 198,738.00	\$ 198,738.00
4 Traffic control	Traffic control	1.00	LS	\$ 9,000.00	\$ 9,000.00	\$ 13,000.00	\$ 13,000.00	\$ 7,500.00	\$ 7,500.00
5 Utility coordination, verification/potholing	Utility coordination, verification/potholing	1.00	LS	\$ 158,000.00	\$ 158,000.00	\$ 80,115.00	\$ 80,115.00	\$ 110,000.00	\$ 110,000.00
6 Water Pollution Control	Water Pollution Control	1.00	LS	\$ 17,300.00	\$ 17,300.00	\$ 8,250.00	\$ 8,250.00	\$ 5,000.00	\$ 5,000.00
7 Signing & striping per plans and specifications	Signing & striping per plans and specifications	1.00	LS	\$ 8,600.00	\$ 8,600.00	\$ 15,200.00	\$ 15,200.00	\$ 3,500.00	\$ 3,500.00
8 Sawcut existing AC pavement per plans and specifications	Sawcut existing AC pavement per plans and specifications	1.00	LS	\$ 27,000.00	\$ 27,000.00	\$ 41,235.00	\$ 41,235.00	\$ 30,661.00	\$ 30,661.00
9 Asphalt concrete	Asphalt concrete	321.00	LF	\$ 4.40	\$ 1,412.40	\$ 3.50	\$ 1,123.50	\$ 15.00	\$ 4,815.00
10 Aggregate Base Class II	Aggregate Base Class II	4700.00	TN	\$ 77.50	\$ 364,250.00	\$ 74.00	\$ 347,800.00	\$ 100.00	\$ 470,000.00
11 Construct Type A-8 curb & gutter per County Std. 201	Construct Type A-8 curb & gutter per County Std. 201	9900.00	TN	\$ 20.05	\$ 198,495.00	\$ 19.50	\$ 193,050.00	\$ 20.00	\$ 198,000.00
12 Construct Type A-8 curb & gutter per County Std. 204	Construct Type A-8 curb & gutter per County Std. 204	13675.00	SF	\$ 4.00	\$ 54,700.00	\$ 6.60	\$ 90,255.00	\$ 10.00	\$ 136,750.00
13 Adjust to grade manholes per EMWD Stds.	Adjust to grade manholes per EMWD Stds.	2844.00	LF	\$ 18.50	\$ 52,614.00	\$ 28.50	\$ 81,054.00	\$ 35.00	\$ 99,540.00
14 Adjust to grade manholes per EMWD Stds.	Adjust to grade manholes per EMWD Stds.	2573.00	LF	\$ 12.00	\$ 30,876.00	\$ 20.00	\$ 51,460.00	\$ 23.00	\$ 59,179.00
15 Construct 4" PCC landscape median per County Std. 113	Construct 4" PCC landscape median per County Std. 113	4.00	EA	\$ 1,580.00	\$ 6,320.00	\$ 750.00	\$ 3,000.00	\$ 1,300.00	\$ 5,200.00
16 Construct 4" PCC landscape median per County Std. 113	Construct 4" PCC landscape median per County Std. 113	2.00	EA	\$ 370.00	\$ 740.00	\$ 500.00	\$ 1,000.00	\$ 900.00	\$ 1,800.00
17 Construct access curb ramp per County Std. 403, Case A	Construct access curb ramp per County Std. 403, Case A	2262.00	SF	\$ 4.00	\$ 9,048.00	\$ 15.00	\$ 33,930.00	\$ 10.00	\$ 22,620.00
18 Construct 6" asphalt concrete dike per County Std. 212	Construct 6" asphalt concrete dike per County Std. 212	1670.00	SF	\$ 11.00	\$ 18,370.00	\$ 13.00	\$ 21,710.00	\$ 4.00	\$ 6,680.00
19 Construct 18" RCP Class II	Construct 18" RCP Class II	1.00	EA	\$ 5,100.00	\$ 5,100.00	\$ 2,515.00	\$ 2,515.00	\$ 6,000.00	\$ 6,000.00
20 Construct CB#1 per County Flood Control	Construct CB#1 per County Flood Control	18.00	LF	\$ 135.00	\$ 2,430.00	\$ 45.00	\$ 810.00	\$ 70.00	\$ 1,260.00
21 Install 1/4 Ton RipRap Stone with filter fabric	Install 1/4 Ton RipRap Stone with filter fabric	60.00	LF	\$ 220.00	\$ 13,200.00	\$ 100.00	\$ 6,000.00	\$ 370.00	\$ 22,200.00
22 Construct headwall per Caltrans Std. D89	Construct headwall per Caltrans Std. D89	4.00	EA	\$ 9,600.00	\$ 38,400.00	\$ 7,000.00	\$ 28,000.00	\$ 7,500.00	\$ 30,000.00
23 Grind/cold plane 0.12' existing asphalt	Grind/cold plane 0.12' existing asphalt	14.00	CY	\$ 1,770.00	\$ 24,780.00	\$ 500.00	\$ 7,000.00	\$ 220.00	\$ 3,080.00
24 Construct barricade per County Std. 810	Construct barricade per County Std. 810	2.00	EA	\$ 6,500.00	\$ 13,000.00	\$ 7,850.00	\$ 15,700.00	\$ 1,800.00	\$ 3,600.00
25		4420.00	SF	\$ 1.20	\$ 5,304.00	\$ 1.30	\$ 5,746.00	\$ 1.00	\$ 4,420.00
26		88.00	LF	\$ 73.00	\$ 6,424.00	\$ 80.00	\$ 7,040.00	\$ 95.00	\$ 8,360.00

27 Adjust to grade telephone manholes	2.00 EA	\$ 1,500.00	\$ 3,000.00	\$ 1,500.00	\$ 3,000.00	\$ 1,700.00	\$ 3,400.00
28 Install 3" conduit	175.00 LF	\$ 90.00	\$ 15,750.00	\$ 67.10	\$ 11,742.50	\$ 50.00	\$ 8,750.00
Provide & install handholes with traffic rated							
29 bolt down cover & ground rod	3.00 EA	\$ 1,050.00	\$ 3,150.00	\$ 475.00	\$ 1,425.00	\$ 2,133.00	\$ 6,399.00
Bid Schedule 1 (Subtotal)			\$ 1,489,863.40		\$ 1,475,734.00		\$ 1,527,952.00

Bid Schedule 2							
Provide & install district entry monument							
1 framing w/ concrete footing	2.00 EA	\$ 15,000.00	\$ 30,000.00	\$ 18,500.00	\$ 37,000.00	\$ 5,000.00	\$ 10,000.00
Provide & install district entry monument and finish all complete w/red used brick veneer,							
2 etc.	2.00 EA	\$ 12,600.00	\$ 25,200.00	\$ 24,000.00	\$ 48,000.00	\$ 10,000.00	\$ 20,000.00
Provide & install district entry monument cap w/textured Acrylic inserts by Storyland							
3 Studio	2.00 EA	\$ 5,600.00	\$ 11,200.00	\$ 8,800.00	\$ 17,600.00	\$ 6,000.00	\$ 12,000.00
Bid Schedule 2 (Subtotal)			\$ 66,400.00		\$ 102,600.00		\$ 42,000.00

Bid Schedule 3							
1 Provide & install circuit breakers	1.00 EA	\$ 210.00	\$ 210.00	\$ 25.00	\$ 25.00	\$ 940.00	\$ 940.00
2 Provide & install controls and relays	1.00 EA	\$ 530.00	\$ 530.00	\$ 250.00	\$ 250.00	\$ 2,140.00	\$ 2,140.00
3 Provide & install LED flood light	2.00 EA	\$ 3,700.00	\$ 7,400.00	\$ 2,000.00	\$ 4,000.00	\$ 2,381.00	\$ 4,762.00
4 Provide & install Unistrut supports	2.00 EA	\$ 530.00	\$ 1,060.00	\$ 165.00	\$ 330.00	\$ 760.00	\$ 1,520.00
5 Provide & install 1" rigid conduit	35.00 LF	\$ 105.00	\$ 3,675.00	\$ 45.00	\$ 1,575.00	\$ 65.00	\$ 2,275.00
6 Provide & install #10 copper wires	520.00 LF	\$ 1.90	\$ 988.00	\$ 1.00	\$ 520.00	\$ 3.00	\$ 1,560.00
7 Provide & install #12 copper wires	210.00 LF	\$ 2.10	\$ 441.00	\$ 1.00	\$ 210.00	\$ 4.00	\$ 840.00
8 Provide & install 24"x14.5" access door	2.00 EA	\$ 1,050.00	\$ 2,100.00	\$ 100.00	\$ 200.00	\$ 1,600.00	\$ 3,200.00
9 Fixture	2.00 EA	\$ 3,900.00	\$ 7,800.00	\$ 2,800.00	\$ 5,600.00	\$ 2,381.00	\$ 4,762.00
Bid Schedule 3 (Subtotal)			\$ 24,204.00		\$ 12,710.00		\$ 21,999.00
Total Bid Amounts			\$ 1,580,467.40		\$ 1,591,044.00		\$ 1,591,951.00

Item Description	Bid Schedule	Granite	
		Unit Price	Total
1 Mobilization		\$ 70,000.00	\$ 70,000.00
Protect Improvements in Place, Adjust grade, relocate and/or replace all existing improvements in conflict			
2 Excavation and earthwork, clearing & grubbing		\$ 500.00	\$ 500.00
3 Environmental compliance		\$ 198,738.00	\$ 198,738.00
4 Traffic control		\$ 7,500.00	\$ 7,500.00
5 Utility coordination, verification/potholes		\$ 110,000.00	\$ 110,000.00
6 Water Pollution Control		\$ 5,000.00	\$ 5,000.00
7 Signing & striping per plans and specifications		\$ 3,500.00	\$ 3,500.00
8 Sawcut existing AC pavement per plans and specifications		\$ 30,661.00	\$ 30,661.00
9 Asphalt concrete		\$ 15.00	\$ 4,815.00
10 Aggregate Base Class II		\$ 100.00	\$ 470,000.00
11 Construct sidewalk per County Std. 4		\$ 20.00	\$ 198,000.00
Construct Type A-8 curb & gutter per County Std. 201		\$ 10.00	\$ 136,750.00
13 Construct 8" Type D curb per County Std. 204		\$ 35.00	\$ 99,540.00
14 Adjust to grade manholes per EMWD		\$ 23.00	\$ 59,179.00
15 Adjust to grade water valves per EMWD		\$ 1,300.00	\$ 5,200.00
16 Construct 4" PCC landscape median per County Std. 113		\$ 900.00	\$ 1,800.00
17 Install rock cobble landscape		\$ 10.00	\$ 22,620.00
Construct access curb ramp per County Std. 403, Case A		\$ 4.00	\$ 6,680.00
19 Construct 6" asphalt concrete dike per County Std. 212		\$ 6,000.00	\$ 6,000.00
20 Construct 18" RCP Class II		\$ 70.00	\$ 1,260.00
Construct CB#1 per County Flood Control Std. CB100		\$ 370.00	\$ 22,200.00
22 Install 1/4 Ton RipRap Stone with filter fabric		\$ 7,500.00	\$ 30,000.00
23 Construct headwall per Caltrans Std. 204		\$ 220.00	\$ 3,080.00
Grind/cold plane 0.12' existing asphalt pavement		\$ 1,800.00	\$ 3,600.00
25 Construct barricade per County Std. 204		\$ 1.00	\$ 4,420.00
26		\$ 95.00	\$ 8,360.00

27 Adjust to grade telephone manholes	\$ 1,700.00	\$ 3,400.00
28 Install 3" conduit Provide & install handholes with traffic	\$ 50.00	\$ 8,750.00
29 bolt down cover & ground rod	\$ 2,133.00	\$ 6,399.00

Bid Schedule 1 (Subtotal)	\$ 1,527,952.00
---------------------------	-----------------

Bid Schedule 2

Provide & install district entry monument 1 framing w/concrete footing	\$ 5,000.00	\$ 10,000.00
Provide & install district entry monument finish all complete w/red used brick w/	\$ 10,000.00	\$ 20,000.00
2 etc.	\$ 10,000.00	\$ 20,000.00
Provide & install district entry monument w/textured Acrylite inserts by Storyline	\$ 6,000.00	\$ 12,000.00
3 Studio	\$ 6,000.00	\$ 12,000.00

Bid Schedule 2 (Subtotal)	\$ 42,000.00
---------------------------	--------------

Bid Schedule 3

1 Provide & install circuit breakers	\$ 940.00	\$ 940.00
2 Provide & install controls and relays	\$ 2,140.00	\$ 2,140.00
3 Provide & install LED flood light	\$ 2,381.00	\$ 4,762.00
4 Provide & install Unistrut supports	\$ 760.00	\$ 1,520.00
5 Provide & install 1" rigid conduit	\$ 65.00	\$ 2,275.00
6 Provide & install #10 copper wires	\$ 3.00	\$ 1,560.00
7 Provide & install #12 copper wires	\$ 4.00	\$ 840.00
8 Provide & install 24"x14.5" access door Provide & install additive LED Wall Wash	\$ 1,600.00	\$ 3,200.00
9 Fixture	\$ 2,381.00	\$ 4,762.00

Bid Schedule 3 (Subtotal)	\$ 21,999.00
---------------------------	--------------

Total Bid Amounts	\$ 1,591,951.00
--------------------------	------------------------

**CITY COUNCIL
AGENDA SUBMITTAL**

Meeting Date: February 13, 2018

SUBJECT: Second Reading of Amendment No. 1 to ParkWest Development Agreement – Consideration of a request to adopt an amendment to the Development Agreement for the ParkWest Specific Plan and Tentative Tract Map 31157. Applicant: Palin Enterprises

REQUESTED ACTION: Adopt Second Reading of Ordinance No. 1360 to provide findings and approve Amendment No. 1 to the Development Agreement for the ParkWest Specific Plan and Tentative Tract Map 31157.



CONTACT: Dr. Grace Williams, Director of Planning and Economic Development 

BACKGROUND/DISCUSSION:

On January 30, 2018, the City Council voted unanimously to extend the life of the Development Agreement (DA) between the City of Perris and ParkWest Associates (aka ParkWest Specific Plan) by an additional ten years from the date that was previously approved by the City Council in early 2007. The ParkWest Specific Plan is located south of Nuevo Road and generally between Dunlap Road and the Perris Valley Storm Drain Channel, that will provide for development of 534 acres of vacant land into 1,533 single family dwellings and 474 townhome units, along with other facilities and open space amenities. As a provision for the extension, the developer will dedicate right of way and contribute a \$2,000,000 Public Benefit Fee which the City may use toward improvements to Nuevo Road and the Nuevo Crossing over the Perris Valley Storm Drain Channel. Upon adoption, Ordinance No. 1360 will become effective on March 16, 2018.

BUDGET (or FISCAL) IMPACT: Costs for staff preparation of this item are borne by the applicant.

Prepared by: Kenneth Phung, Planning Manager 

City Attorney: N/A
Assistant City Manager: Darren Madkin 
Assistant City Manager: Clara Miramontes
Director of Finance: Jennifer Erwin 

Consent: February 13, 2018

Attachments:

1. Ordinance No. (Next in Order) to approved Amendment No. 1 to the ParkWest Specific Plan
2. Proposed Development Agreement
3. Approved 2007 Development Agreement
4. City Council submittal dated January 30, 2018

TRILAKE
 CONSULTANTS, INC.
 2177 HERRICK
 P.O. BOX 100
 PERRIS, CA 92404
 PHONE: (951) 221-1000
 FAX: (951) 221-1001
 DATE: NOV 2010

APPROVED BY: *[Signature]* DATE: *[Date]*
 PREPARED BY: *[Signature]* DATE: *[Date]*
 CHECKED BY: *[Signature]* DATE: *[Date]*
 SCALE: AS SHOWN



NO.	DESCRIPTION	DATE
1	ISSUED FOR PERMIT	11/10/10
2	ISSUED FOR BIDDING	11/10/10
3	ISSUED FOR CONSTRUCTION	11/10/10
4	ISSUED FOR AS-BUILT	11/10/10

DIG ALERT
 CALL TOLL FREE
 1-800-221-5820
 TO REPORT A
 POTENTIAL
 UNLAWFUL
 EXCAVATION
 OR
 DAMAGE TO
 UNDERGROUND
 UTILITIES

SCALE: 1" = 40'
 NORTH
 0 10 20 30 40 50 60 70 80 90 100

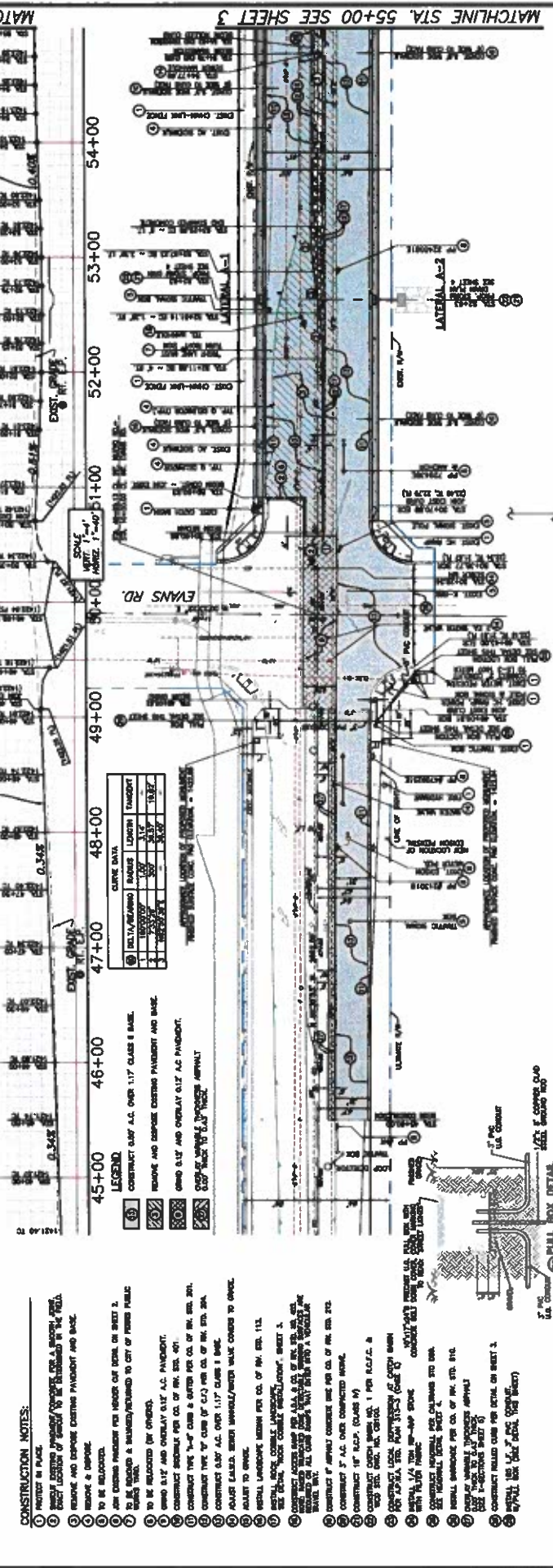

CURVE DATA
 SCALE: 1" = 40'
 HORIZ. 1" = 100'

STATION	PC	PT	PI	END
45+00	45+00	45+00	45+00	45+00
46+00	46+00	46+00	46+00	46+00
47+00	47+00	47+00	47+00	47+00
48+00	48+00	48+00	48+00	48+00
49+00	49+00	49+00	49+00	49+00
50+00	50+00	50+00	50+00	50+00
51+00	51+00	51+00	51+00	51+00
52+00	52+00	52+00	52+00	52+00
53+00	53+00	53+00	53+00	53+00
54+00	54+00	54+00	54+00	54+00

- LEGEND**
 ① CONSTRUCT CLASS A.C. OVER 117 CLASS B BASE.
 ② REMOVE AND REPOSE EXISTING PAVEMENT AND BASE.
 ③ GRAD 0.1% AND OVERLAY 0.1% A.C. PAVEMENT.
 ④ 0.5% SLOPE 1/4" PER FOOT.

- CONSTRUCTION NOTES:**
 1. PROVIDE IN PLACE.
 2. VERIFY LOCATION OF EXISTING UTILITIES FOR A RECORD, AND
 3. VERIFY LOCATION OF UTILITIES TO BE REMOVED IN THE FIELD.
 4. REMOVE AND REPOSE EXISTING PAVEMENT AND BASE.
 5. REMOVE & REPOSE.
 6. TO BE RELOCATED.
 7. SEE EXISTING PAVEMENT FOR NUMBER OF FEET ON SHEET 2.
 8. TO BE RELOCATED & BURNED/RETURNED TO CITY OF PERRIS PUBLIC
 UTILITIES DEPT.
 9. REMOVE 0.1% AND OVERLAY 0.1% A.C. PAVEMENT.
 10. CONSTRUCT 1/4" PER FOOT SLOPE & GRAD PER CO. OF SHEET 201.
 11. CONSTRUCT 1/4" PER FOOT SLOPE OF 0.1% PER CO. OF SHEET 201.
 12. CONSTRUCT 0.5% A.C. OVER 117 CLASS B BASE.
 13. ADJUST ELEVATION, VERIFY MANHOLE/WATER VALUE CORRECT TO CENTER.
 14. ADJUST TO CENTER.
 15. VERIFY LAYOUT, MARK PER CO. OF SHEET 113.
 16. VERIFY LAYOUT, MARK PER CO. OF SHEET 113.
 17. VERIFY LAYOUT, MARK PER CO. OF SHEET 113.
 18. VERIFY LAYOUT, MARK PER CO. OF SHEET 113.
 19. VERIFY LAYOUT, MARK PER CO. OF SHEET 113.
 20. VERIFY LAYOUT, MARK PER CO. OF SHEET 113.
 21. VERIFY LAYOUT, MARK PER CO. OF SHEET 113.
 22. VERIFY LAYOUT, MARK PER CO. OF SHEET 113.
 23. VERIFY LAYOUT, MARK PER CO. OF SHEET 113.
 24. VERIFY LAYOUT, MARK PER CO. OF SHEET 113.
 25. VERIFY LAYOUT, MARK PER CO. OF SHEET 113.
 26. VERIFY LAYOUT, MARK PER CO. OF SHEET 113.
 27. VERIFY LAYOUT, MARK PER CO. OF SHEET 113.
 28. VERIFY LAYOUT, MARK PER CO. OF SHEET 113.
 29. VERIFY LAYOUT, MARK PER CO. OF SHEET 113.
 30. VERIFY LAYOUT, MARK PER CO. OF SHEET 113.
 31. VERIFY LAYOUT, MARK PER CO. OF SHEET 113.
 32. VERIFY LAYOUT, MARK PER CO. OF SHEET 113.
 33. VERIFY LAYOUT, MARK PER CO. OF SHEET 113.
 34. VERIFY LAYOUT, MARK PER CO. OF SHEET 113.
 35. VERIFY LAYOUT, MARK PER CO. OF SHEET 113.
 36. VERIFY LAYOUT, MARK PER CO. OF SHEET 113.
 37. VERIFY LAYOUT, MARK PER CO. OF SHEET 113.
 38. VERIFY LAYOUT, MARK PER CO. OF SHEET 113.
 39. VERIFY LAYOUT, MARK PER CO. OF SHEET 113.
 40. VERIFY LAYOUT, MARK PER CO. OF SHEET 113.
 41. VERIFY LAYOUT, MARK PER CO. OF SHEET 113.
 42. VERIFY LAYOUT, MARK PER CO. OF SHEET 113.
 43. VERIFY LAYOUT, MARK PER CO. OF SHEET 113.
 44. VERIFY LAYOUT, MARK PER CO. OF SHEET 113.
 45. VERIFY LAYOUT, MARK PER CO. OF SHEET 113.
 46. VERIFY LAYOUT, MARK PER CO. OF SHEET 113.
 47. VERIFY LAYOUT, MARK PER CO. OF SHEET 113.
 48. VERIFY LAYOUT, MARK PER CO. OF SHEET 113.
 49. VERIFY LAYOUT, MARK PER CO. OF SHEET 113.
 50. VERIFY LAYOUT, MARK PER CO. OF SHEET 113.
 51. VERIFY LAYOUT, MARK PER CO. OF SHEET 113.
 52. VERIFY LAYOUT, MARK PER CO. OF SHEET 113.
 53. VERIFY LAYOUT, MARK PER CO. OF SHEET 113.
 54. VERIFY LAYOUT, MARK PER CO. OF SHEET 113.
 55. VERIFY LAYOUT, MARK PER CO. OF SHEET 113.
 56. VERIFY LAYOUT, MARK PER CO. OF SHEET 113.
 57. VERIFY LAYOUT, MARK PER CO. OF SHEET 113.
 58. VERIFY LAYOUT, MARK PER CO. OF SHEET 113.
 59. VERIFY LAYOUT, MARK PER CO. OF SHEET 113.
 60. VERIFY LAYOUT, MARK PER CO. OF SHEET 113.
 61. VERIFY LAYOUT, MARK PER CO. OF SHEET 113.
 62. VERIFY LAYOUT, MARK PER CO. OF SHEET 113.
 63. VERIFY LAYOUT, MARK PER CO. OF SHEET 113.
 64. VERIFY LAYOUT, MARK PER CO. OF SHEET 113.
 65. VERIFY LAYOUT, MARK PER CO. OF SHEET 113.
 66. VERIFY LAYOUT, MARK PER CO. OF SHEET 113.
 67. VERIFY LAYOUT, MARK PER CO. OF SHEET 113.
 68. VERIFY LAYOUT, MARK PER CO. OF SHEET 113.
 69. VERIFY LAYOUT, MARK PER CO. OF SHEET 113.
 70. VERIFY LAYOUT, MARK PER CO. OF SHEET 113.
 71. VERIFY LAYOUT, MARK PER CO. OF SHEET 113.
 72. VERIFY LAYOUT, MARK PER CO. OF SHEET 113.
 73. VERIFY LAYOUT, MARK PER CO. OF SHEET 113.
 74. VERIFY LAYOUT, MARK PER CO. OF SHEET 113.
 75. VERIFY LAYOUT, MARK PER CO. OF SHEET 113.
 76. VERIFY LAYOUT, MARK PER CO. OF SHEET 113.
 77. VERIFY LAYOUT, MARK PER CO. OF SHEET 113.
 78. VERIFY LAYOUT, MARK PER CO. OF SHEET 113.
 79. VERIFY LAYOUT, MARK PER CO. OF SHEET 113.
 80. VERIFY LAYOUT, MARK PER CO. OF SHEET 113.
 81. VERIFY LAYOUT, MARK PER CO. OF SHEET 113.
 82. VERIFY LAYOUT, MARK PER CO. OF SHEET 113.
 83. VERIFY LAYOUT, MARK PER CO. OF SHEET 113.
 84. VERIFY LAYOUT, MARK PER CO. OF SHEET 113.
 85. VERIFY LAYOUT, MARK PER CO. OF SHEET 113.
 86. VERIFY LAYOUT, MARK PER CO. OF SHEET 113.
 87. VERIFY LAYOUT, MARK PER CO. OF SHEET 113.
 88. VERIFY LAYOUT, MARK PER CO. OF SHEET 113.
 89. VERIFY LAYOUT, MARK PER CO. OF SHEET 113.
 90. VERIFY LAYOUT, MARK PER CO. OF SHEET 113.
 91. VERIFY LAYOUT, MARK PER CO. OF SHEET 113.
 92. VERIFY LAYOUT, MARK PER CO. OF SHEET 113.
 93. VERIFY LAYOUT, MARK PER CO. OF SHEET 113.
 94. VERIFY LAYOUT, MARK PER CO. OF SHEET 113.
 95. VERIFY LAYOUT, MARK PER CO. OF SHEET 113.
 96. VERIFY LAYOUT, MARK PER CO. OF SHEET 113.
 97. VERIFY LAYOUT, MARK PER CO. OF SHEET 113.
 98. VERIFY LAYOUT, MARK PER CO. OF SHEET 113.
 99. VERIFY LAYOUT, MARK PER CO. OF SHEET 113.
 100. VERIFY LAYOUT, MARK PER CO. OF SHEET 113.

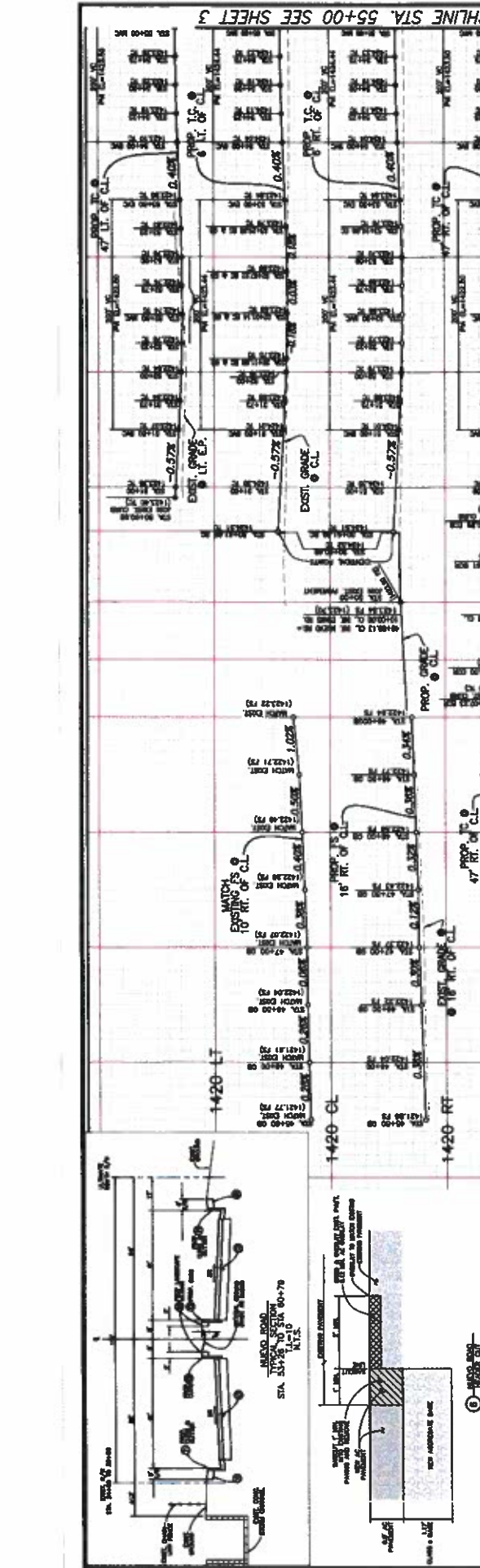

MATCHLINE STA. 55+00 SEE SHEET 3
 MATCHLINE STA. 55+00 SEE SHEET 3

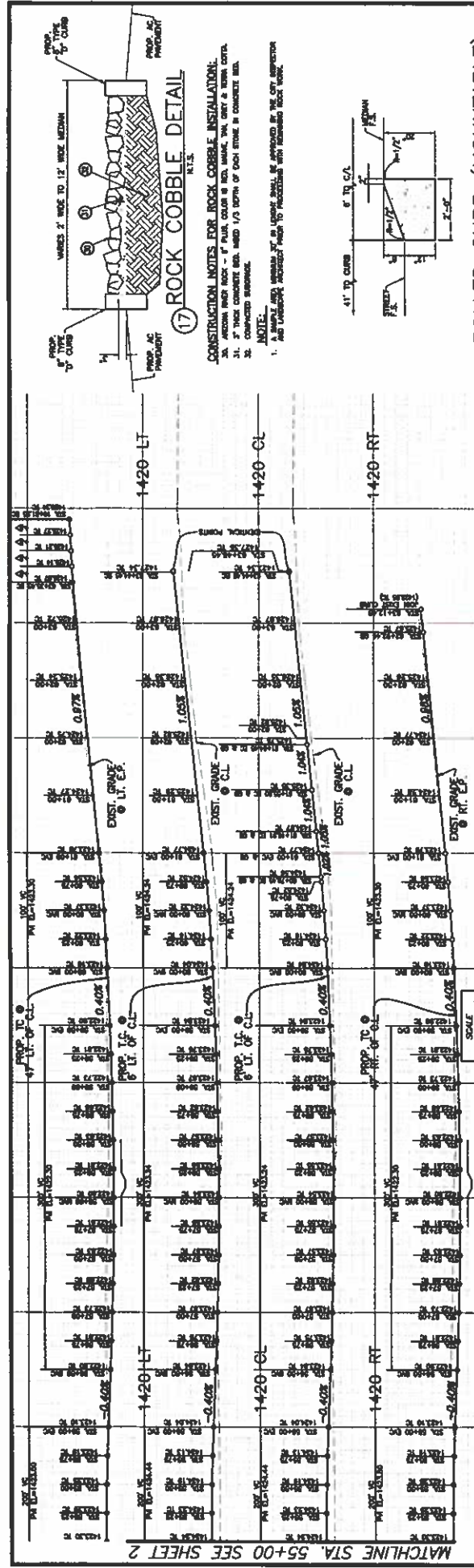

28 ROLLED CURB (MOUNTABLE)
N.T.S.

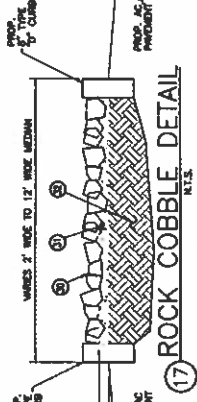
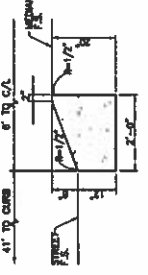

CONSTRUCTION NOTES FOR ROCK COBBLE INSTALLATION:
 1. ALL WORK SHALL BE DONE IN ACCORDANCE WITH THE CITY SPECIFICATIONS FOR ROADWAY CONSTRUCTION.
 2. THE COBBLES SHALL BE WASHED AND SCREENED TO REMOVAL OF ALL FINE MATERIAL.
 3. THE COBBLES SHALL BE PLACED IN A SINGLE LAYER WITH A MINIMUM OF 1/2\"/>

CONSTRUCTION NOTES:

1. PROTECT IN PLACE.
2. REMOVE AND REGRADE EXISTING PAVEMENT AND BASE.
3. REGRADE AND REGRADE EXISTING PAVEMENT AND BASE.
4. REGRADE & COMPACT.
5. ADD EXISTING PAVEMENT FOR WIDTH OF SIDE OF ROAD TO BE RECONSTRUCTED.
6. ADD EXISTING PAVEMENT TO MATCH EXISTING PAVEMENT TO BE RECONSTRUCTED BY OTHERS.
7. REGRADE & COMPACT.
8. REGRADE & COMPACT.
9. REGRADE & COMPACT.
10. REGRADE & COMPACT.
11. REGRADE & COMPACT.
12. REGRADE & COMPACT.
13. REGRADE & COMPACT.
14. REGRADE & COMPACT.
15. REGRADE & COMPACT.
16. REGRADE & COMPACT.
17. REGRADE & COMPACT.
18. REGRADE & COMPACT.
19. REGRADE & COMPACT.
20. REGRADE & COMPACT.
21. REGRADE & COMPACT.
22. REGRADE & COMPACT.
23. REGRADE & COMPACT.
24. REGRADE & COMPACT.
25. REGRADE & COMPACT.
26. REGRADE & COMPACT.
27. REGRADE & COMPACT.
28. REGRADE & COMPACT.
29. REGRADE & COMPACT.
30. REGRADE & COMPACT.
31. REGRADE & COMPACT.
32. REGRADE & COMPACT.
33. REGRADE & COMPACT.
34. REGRADE & COMPACT.
35. REGRADE & COMPACT.
36. REGRADE & COMPACT.
37. REGRADE & COMPACT.
38. REGRADE & COMPACT.
39. REGRADE & COMPACT.
40. REGRADE & COMPACT.
41. REGRADE & COMPACT.
42. REGRADE & COMPACT.
43. REGRADE & COMPACT.
44. REGRADE & COMPACT.
45. REGRADE & COMPACT.
46. REGRADE & COMPACT.
47. REGRADE & COMPACT.
48. REGRADE & COMPACT.
49. REGRADE & COMPACT.
50. REGRADE & COMPACT.
51. REGRADE & COMPACT.
52. REGRADE & COMPACT.
53. REGRADE & COMPACT.
54. REGRADE & COMPACT.
55. REGRADE & COMPACT.
56. REGRADE & COMPACT.
57. REGRADE & COMPACT.
58. REGRADE & COMPACT.
59. REGRADE & COMPACT.
60. REGRADE & COMPACT.
61. REGRADE & COMPACT.
62. REGRADE & COMPACT.
63. REGRADE & COMPACT.
64. REGRADE & COMPACT.
65. REGRADE & COMPACT.

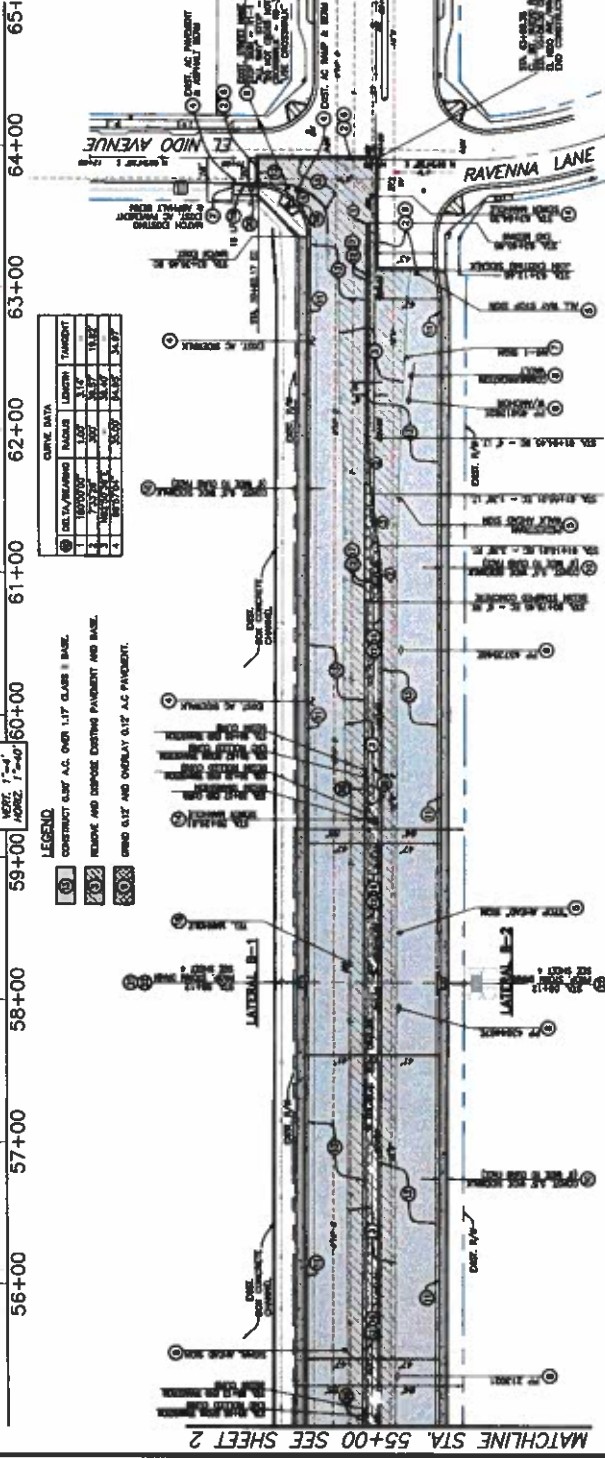

TRILAKE CONSULTANTS, INC.
 CITY ENGINEER
 SCALE: AS SHOWN
 DATE: 08/19/2019

DIG ALERT
 DIAL TOLL FREE
 1-800-227-2000
 4 HOURS PER DAY
 7 DAYS PER WEEK
 GUARANTEEING SERVICE ALERT OF BURIED UTILITIES

SCALE
 1" = 40'

APPROVED BY: [Signature]
 DATE: 08/19/2019
 PREPARED BY: [Signature]
 DATE: 08/19/2019

CHECKED BY: [Signature]
 DATE: 08/19/2019

CITY OF PERRIS, CALIFORNIA
NEW ROAD BRIDGE PROJECT
STREET IMPROVEMENTS
STA. 56+00 TO STA. 64+00

SHEET NO. 3
OF 8 SHEETS

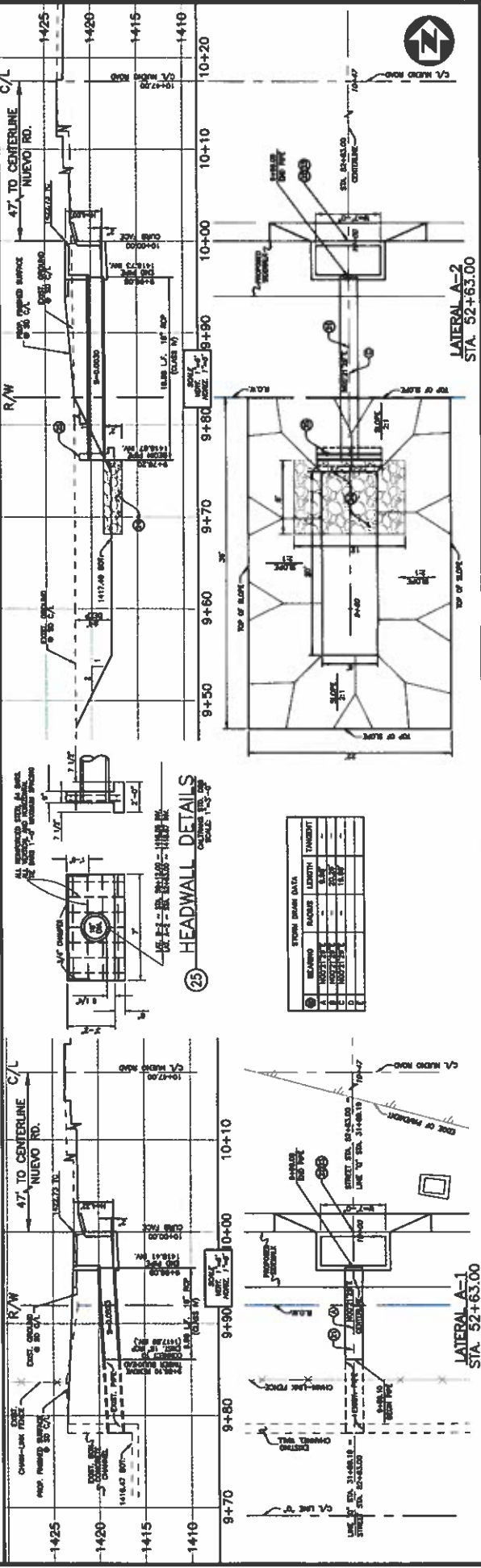
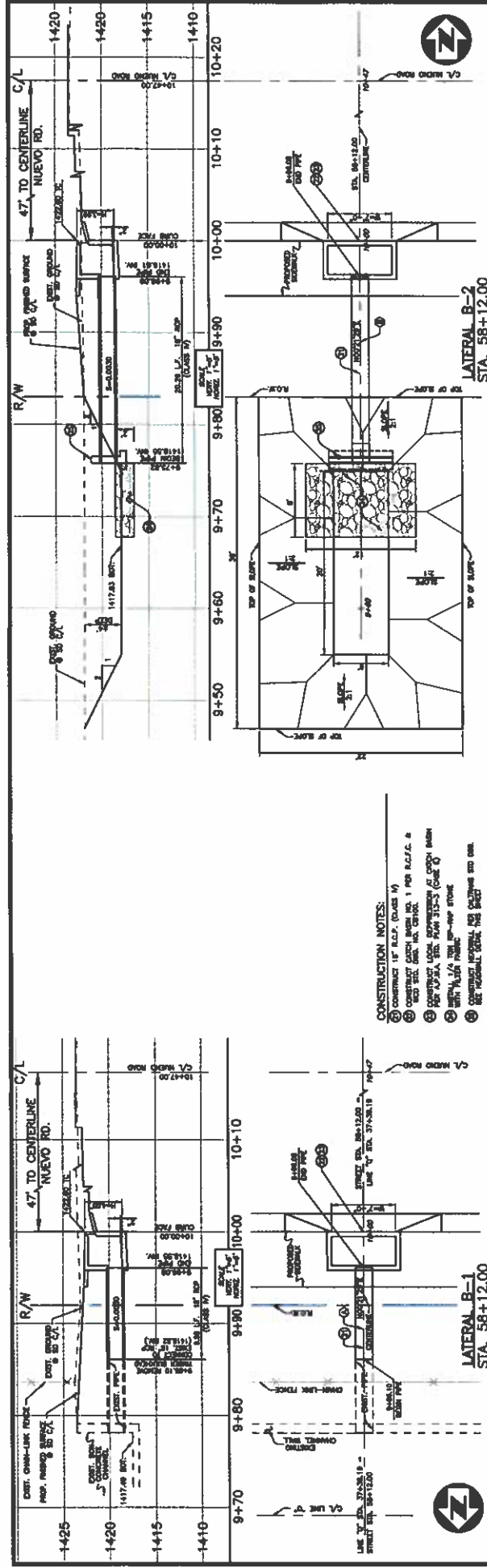

CONSTRUCTION NOTES:

- CONSTRUCT IF SLOPE (GRADE) IS
- CONSTRUCT LOCAL DRAINAGE AT EACH MANHOLE
- CONSTRUCT LOCAL DRAINAGE AT EACH MANHOLE
- CONSTRUCT LOCAL DRAINAGE AT EACH MANHOLE
- CONSTRUCT LOCAL DRAINAGE AT EACH MANHOLE
- CONSTRUCT LOCAL DRAINAGE AT EACH MANHOLE

HEADWALL DETAILS
SCALE 1/8" = 1'-0"

STATION	MANHOLE	LENGTH	TRANSIT
9+50	1	10.00	10.00
9+60	2	10.00	10.00
9+70	3	10.00	10.00
9+80	4	10.00	10.00
9+90	5	10.00	10.00
9+100	6	10.00	10.00
9+110	7	10.00	10.00
9+120	8	10.00	10.00
9+130	9	10.00	10.00
9+140	10	10.00	10.00
9+150	11	10.00	10.00
9+160	12	10.00	10.00
9+170	13	10.00	10.00
9+180	14	10.00	10.00
9+190	15	10.00	10.00
9+200	16	10.00	10.00
9+210	17	10.00	10.00
9+220	18	10.00	10.00
9+230	19	10.00	10.00
9+240	20	10.00	10.00
9+250	21	10.00	10.00
9+260	22	10.00	10.00
9+270	23	10.00	10.00
9+280	24	10.00	10.00
9+290	25	10.00	10.00
9+300	26	10.00	10.00
9+310	27	10.00	10.00
9+320	28	10.00	10.00
9+330	29	10.00	10.00
9+340	30	10.00	10.00
9+350	31	10.00	10.00
9+360	32	10.00	10.00
9+370	33	10.00	10.00
9+380	34	10.00	10.00
9+390	35	10.00	10.00
9+400	36	10.00	10.00
9+410	37	10.00	10.00
9+420	38	10.00	10.00
9+430	39	10.00	10.00
9+440	40	10.00	10.00
9+450	41	10.00	10.00
9+460	42	10.00	10.00
9+470	43	10.00	10.00
9+480	44	10.00	10.00
9+490	45	10.00	10.00
9+500	46	10.00	10.00
9+510	47	10.00	10.00
9+520	48	10.00	10.00
9+530	49	10.00	10.00
9+540	50	10.00	10.00
9+550	51	10.00	10.00
9+560	52	10.00	10.00
9+570	53	10.00	10.00
9+580	54	10.00	10.00
9+590	55	10.00	10.00
9+600	56	10.00	10.00
9+610	57	10.00	10.00
9+620	58	10.00	10.00
9+630	59	10.00	10.00
9+640	60	10.00	10.00
9+650	61	10.00	10.00
9+660	62	10.00	10.00
9+670	63	10.00	10.00
9+680	64	10.00	10.00
9+690	65	10.00	10.00
9+700	66	10.00	10.00
9+710	67	10.00	10.00
9+720	68	10.00	10.00
9+730	69	10.00	10.00
9+740	70	10.00	10.00
9+750	71	10.00	10.00
9+760	72	10.00	10.00
9+770	73	10.00	10.00
9+780	74	10.00	10.00
9+790	75	10.00	10.00
9+800	76	10.00	10.00
9+810	77	10.00	10.00
9+820	78	10.00	10.00
9+830	79	10.00	10.00
9+840	80	10.00	10.00
9+850	81	10.00	10.00
9+860	82	10.00	10.00
9+870	83	10.00	10.00
9+880	84	10.00	10.00
9+890	85	10.00	10.00
9+900	86	10.00	10.00
9+910	87	10.00	10.00
9+920	88	10.00	10.00
9+930	89	10.00	10.00
9+940	90	10.00	10.00
9+950	91	10.00	10.00
9+960	92	10.00	10.00
9+970	93	10.00	10.00
9+980	94	10.00	10.00
9+990	95	10.00	10.00
10+000	96	10.00	10.00
10+010	97	10.00	10.00
10+020	98	10.00	10.00
10+030	99	10.00	10.00
10+040	100	10.00	10.00
10+050	101	10.00	10.00
10+060	102	10.00	10.00
10+070	103	10.00	10.00
10+080	104	10.00	10.00
10+090	105	10.00	10.00
10+100	106	10.00	10.00
10+110	107	10.00	10.00
10+120	108	10.00	10.00
10+130	109	10.00	10.00
10+140	110	10.00	10.00
10+150	111	10.00	10.00
10+160	112	10.00	10.00
10+170	113	10.00	10.00
10+180	114	10.00	10.00
10+190	115	10.00	10.00
10+200	116	10.00	10.00

5
 OF 1 SHEET
 PROJECT NO. 14-0000
 SHEET NO. 5
 DATE: 07/15/14

CITY OF PERRIS, CALIFORNIA
MEVO ROAD BRIDGE PROJECT
 CROSS SECTIONS
 STA. 34+00 TO STA. 34+80

SCALE: AS SHOWN
 DATE: 07/15/14
 PREPARED BY: [Name]
 CHECKED BY: [Name]
 DATE: [Date]
 SCALE: 1"=40'
 VERT: 1"=4'

TRI LAKE
 CONSULTANTS, INC.
 CIVIL ENGINEERS

DIG ALERT
 DIAL TOLL FREE
 1-800-287-3800
 "CALL BEFORE YOU DIG"
 REGISTERED SERVICE MARK OF REGISTERED COMPANY

SCALE: HORIZ 1"=40'
 VERT 1"=4'

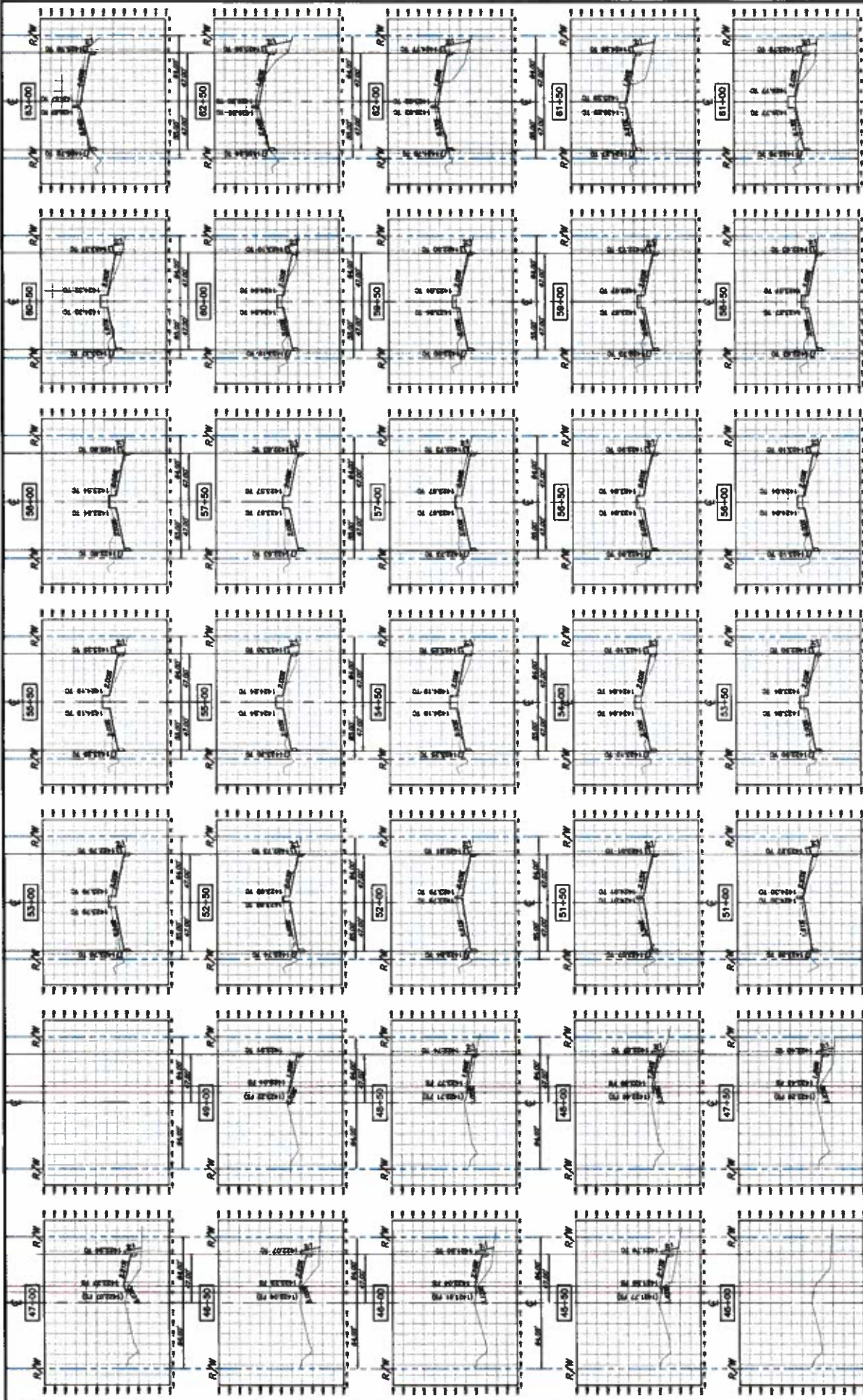

MATCHLINE STA. 57+00 SEE BELOW LEFT

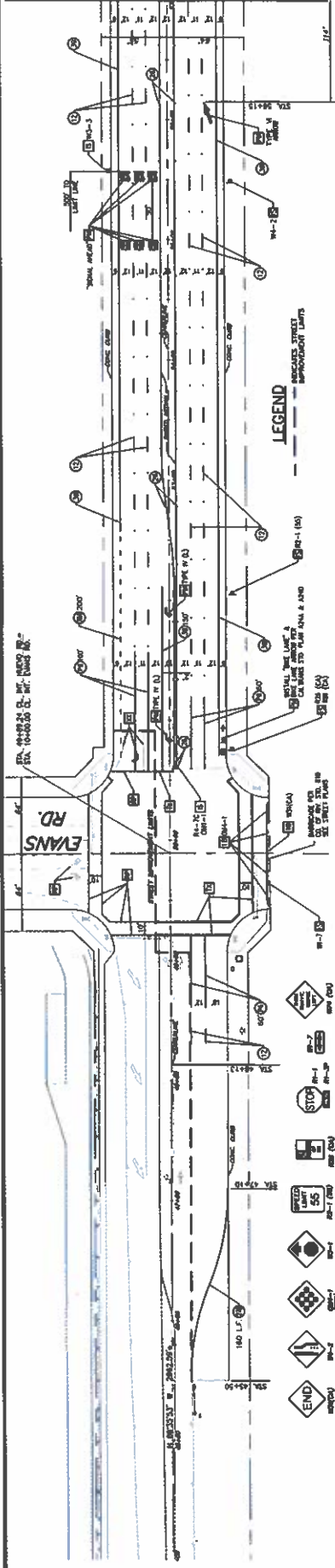

MATCHLINE STA. 69+50 SEE BELOW LEFT

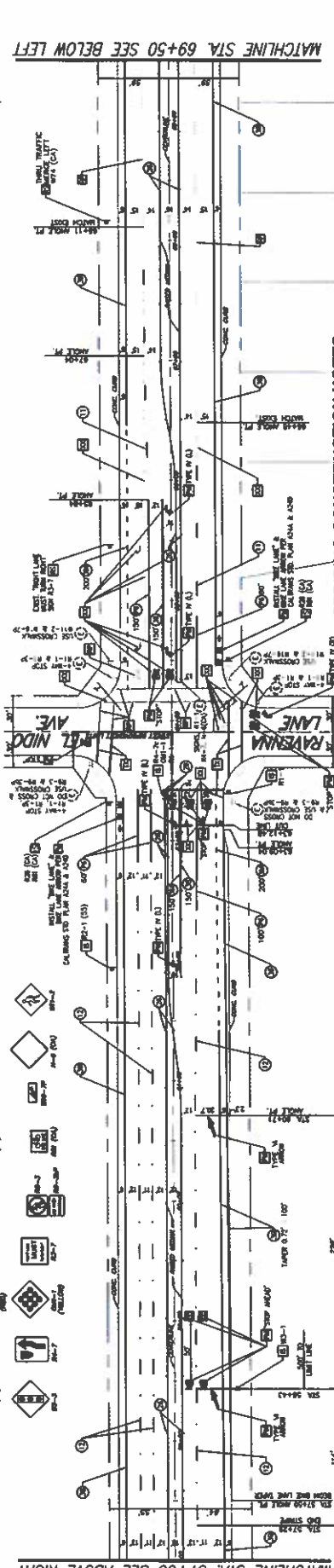

MATCHLINE STA. 69+50 SEE ABOVE RIGHT

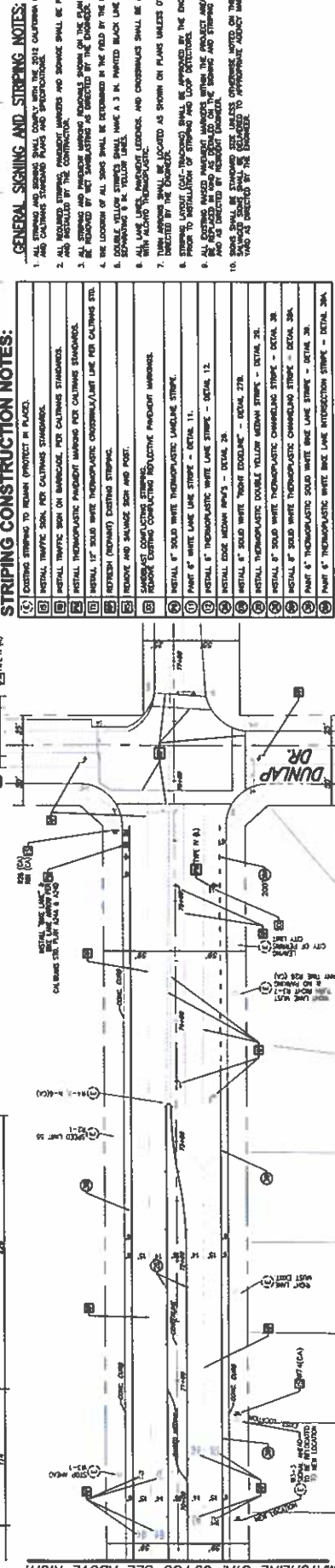

MATCHLINE STA. 57+00 SEE ABOVE RIGHT

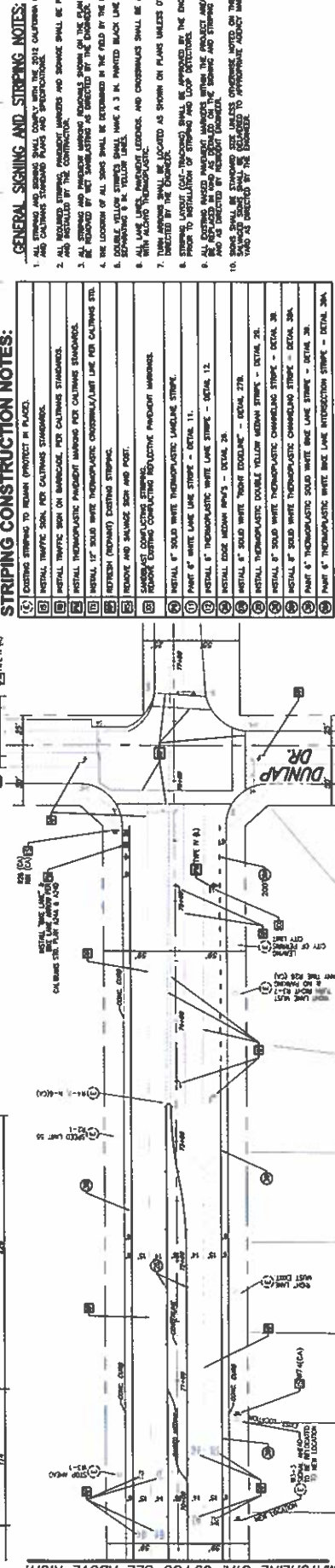

- GENERAL SIGNING AND STRIPING NOTES:**
1. ALL STRIPING AND SIGNING SHALL COMPLY WITH THE 2012 CALIFORNIA MUTCD AND CURRENT STATEWIDE PLANS AND SPECIFICATIONS.
 2. ALL ROADWORK STRIPING, PREVIOUS SIGNING AND SIGNAGE SHALL BE PROVIDED BY THE CONTRACTOR.
 3. ALL STRIPING AND SIGNAGE MARKINGS SHALL BE PROVIDED BY THE CONTRACTOR AND SHALL BE REMOVED BY THE CONTRACTOR AS DIRECTED BY THE ENGINEER.
 4. THE LOCATION OF ALL SIGNS SHALL BE DETERMINED BY THE FIELD BY THE ENGINEER.
 5. DOUBLE YELLOW STRIPES SHALL HAVE A 3 IN. PAINTED BLACK LINE AND SPANNING 1/4 IN. YELLOW LINES.
 6. ALL SIGNING AND SIGNAGE SHALL BE PROVIDED BY THE CONTRACTOR AND SHALL BE REMOVED BY THE CONTRACTOR AS DIRECTED BY THE ENGINEER.
 7. TURN ARROWS SHALL BE LOCATED AS SHOWN ON PLANS UNLESS OTHERWISE INDICATED BY THE ENGINEER.
 8. STRIPING LAYOUT (POST-TENSION) SHALL BE APPROVED BY THE ENGINEER BEFORE CONSTRUCTION.
 9. ALL ROADWORK MARKINGS SHALL BE PROVIDED BY THE CONTRACTOR AND SHALL BE REMOVED BY THE CONTRACTOR AS DIRECTED BY THE ENGINEER.
 10. SIGNING AND SIGNAGE SHALL BE RELIABLE TO APPROPRIATE MAINTENANCE VEHICLES AS DIRECTED BY THE ENGINEER.

- STRIPING CONSTRUCTION NOTES:**
- (1) EXISTING STRIPING TO REMAIN (PROTECT IN PLACE).
 - (2) METAL TRAFFIC SIGN, POST CALIFORNIA STANDARDS.
 - (3) METAL TRAFFIC SIGN ON BARRICADE, PER CALIFORNIA STANDARDS.
 - (4) INSTALL THERMOPLASTIC PAVEMENT MARKING FOR CALIFORNIA STANDARDS.
 - (5) INSTALL 1/2" SOLID WHITE THERMOPLASTIC CROSSWALK/LANE USE PER CALIFORNIA STA.
 - (6) RETURN (REMAIN) EXISTING STRIPING.
 - (7) REMOVE AND SAVE SIGN AND POST.
 - (8) SANDWICH CONDUCTIVE STRIPING.
 - (9) REMOVE EXISTING CONDUCTIVE REFLECTIVE PAVEMENT MARKING.
 - (10) INSTALL 8" SOLID WHITE THERMOPLASTIC LANE/LANE STRIKE.
 - (11) PART 8" WHITE LANE LANE STRIKE - DETAIL 11.
 - (12) INSTALL 8" THERMOPLASTIC WHITE LANE STRIKE - DETAIL 12.
 - (13) INSTALL EDGE MEDIUM RW'S - DETAIL 28.
 - (14) INSTALL 6" SOLID WHITE TRUCK STOPPING - DETAIL 27B.
 - (15) INSTALL THERMOPLASTIC DOUBLE YELLOW MEDIUM STRIKE - DETAIL 26.
 - (16) INSTALL 8" SOLID WHITE THERMOPLASTIC CHANGELANE STRIKE - DETAIL 30.
 - (17) INSTALL 8" SOLID WHITE THERMOPLASTIC WHITE LANE STRIKE - DETAIL 30A.
 - (18) INSTALL 8" THERMOPLASTIC SOLID WHITE LANE STRIKE - DETAIL 30.
 - (19) PART 8" THERMOPLASTIC WHITE SIDE LANE INTERSECTION STRIKE - DETAIL 30A.

CITY OF RIVERS, CALIFORNIA
NEW RIVER ROAD BRIDGE PROJECT
STRIPING & SIGNING

PROJECT NO. 14-1234
 SHEET NO. 6

TRILAKE CONSULTANTS, INC.
 24 S. 70th ST.
 RIVERS, CA 92507
 (951) 843-6000

SCALE: AS SHOWN
 DATE: NOV 2014

APPROVED BY: [Signature]
 DATE: 11-10-14

DESIGNED BY: [Signature]
 DATE: 11-10-14

CHECKED BY: [Signature]
 DATE: 11-10-14

DIG ALERT
 DAN TOLL FREE
 1-800-271-7000
 "CALL BEFORE YOU DIG"

UNDERGROUND SIGNAL ALERT
 OF SUBURBAN CALIFORNIA

SCALE: 1" = 100'

DATE: 11-10-14

CITY OF PERRIS

TEMPORARY TRAFFIC CONTROL PLANS FOR NUEVO ROAD from EVANS ROAD to EL NIDO AVENUE

SHEET INDEX:

No.	Description
1.	TITLE SHEET TRAFFIC CONTROL PLANS
2.	EVANS ROAD FROM STA. 44+30 TO STA. 67+00
3.	MARKHAM ST. FROM STA. 44+30 TO STA. 67+00
4.	PERISS VALLEY CHANNEL FROM STA. 44+30 TO STA. 67+00
5.	RAMONA EXWY FROM STA. 45+00 TO STA. 70+00
6.	DAWES ST. FROM STA. 70+00 TO STA. 76+00
7.	MORGAN AVE FROM STA. 76+00 TO STA. 81+00
8.	EL NIDO AVENUE FROM STA. 76+00 TO STA. 81+00

THESE TRAFFIC CONTROL PLANS SHOW THE MINIMUM TRAFFIC CONTROL FOR THE PROJECT. ANY VARIATION TO THE APPROVED TRAFFIC CONTROL PLAN MUST BE REVIEWED BY THE CITY ENGINEER PRIOR TO IMPLEMENTATION AND BE DESIGNED AND IMPLEMENTED AT THE CONTRACTOR'S EXPENSE.

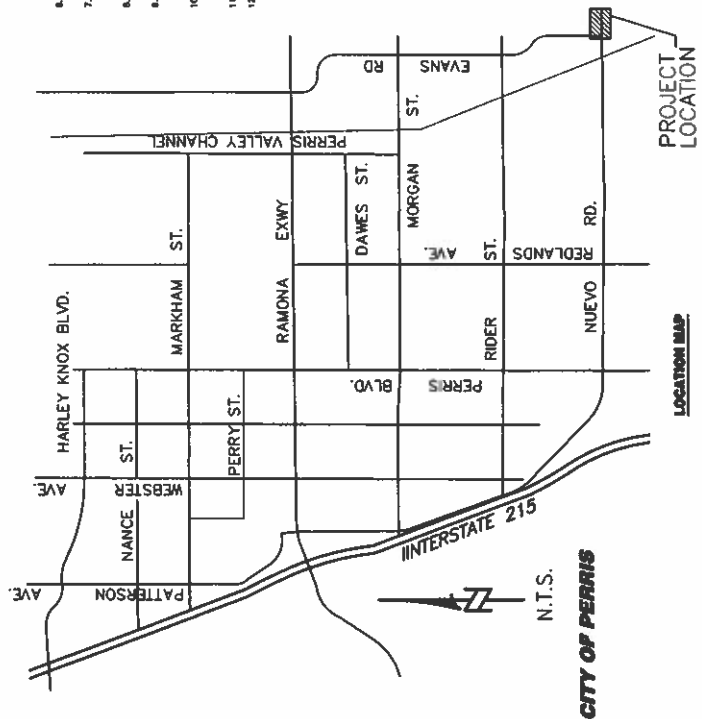

NOTICE TO CONTRACTORS
 PERMISSIBLE TO ASSEMBLY WILL BE ISSUED ONLY IF THE CONTRACTOR FURNISHES THE FOLLOWING INFORMATION:
 1. UNDERGROUND SERVICE ALERT HAS BEEN CONTACTED AND HAS PROVIDED EXACTLY LATEST INFORMATION.
 2. THE UNDERGROUND SERVICE ALERT HAS BEEN CONTACTED AND HAS PROVIDED EXACTLY LATEST INFORMATION.
 (800) 271-5850 at least 100 feet before the work zone.
 DATE: _____
 BY: _____

- LEGEND:**
- PLASMA ARROW SIGN (7-43)
 - TEMPORARY TRAFFIC CONTROL SIGN
 - TYPE II BARRICADE WITH SIGN
 - TYPE II BARRICADE
 - DELMARKATOR
 - EDUCATOR TRACK LINE
 - TEMPORARY CHAIN OBSTRUCTION (TPO-1)
 - TEMPORARY CHAIN OBSTRUCTION STRIPPED IN THE WORK AREA
 - DIRECTION OF TRAVEL
 - SIGNALIZED INTERSECTION
 - WORK ZONE
 - E-PAK
 - WATER FULLED K-PAK ATTENUATOR
 - CHANGEABLE MESSAGE SIGN

GENERAL TRAFFIC CONTROL NOTES:

- THE RESPONSIBILITY OF THE CONTRACTOR FOR ALL NECESSARY TRAFFIC CONTROL, SIGNAL, DELINEATION, BARRICADES AND OTHER RELATED DEVICES SHALL CONTINUE TO THE LATEST DATE OF THE CHANGING STANDARD SPECIFICATIONS (CSSL) THE CALIFORNIA MANUAL ON UNIFORM TRAFFIC CONTROL DEVICES (MUTCD) AND THE CITY OF PERRIS TRAFFIC CONTROL HANDBOOK (WHICH SHALL BE THE BASIS OF THE CONTRACTOR'S SAFETY CONSIDERATIONS AND TRAFFIC CONTROL MEASURES). THE CONTRACTOR SHALL BE RESPONSIBLE FOR THE PROTECTION OF ALL EXISTING UTILITIES AND ALL CHANGES IN APPROVED PROVISIONS OF THESE CONTROL PLANS SHALL BE REPORTED IMMEDIATELY TO THE PROJECT ENGINEER. THE CONTRACTOR SHALL BE RESPONSIBLE FOR THE PROTECTION OF ALL EXISTING UTILITIES AND ALL CHANGES IN APPROVED PROVISIONS OF THESE CONTROL PLANS SHALL BE REPORTED IMMEDIATELY TO THE PROJECT ENGINEER. THE CONTRACTOR SHALL BE RESPONSIBLE FOR THE PROTECTION OF ALL EXISTING UTILITIES AND ALL CHANGES IN APPROVED PROVISIONS OF THESE CONTROL PLANS SHALL BE REPORTED IMMEDIATELY TO THE PROJECT ENGINEER.
- CONTRACTOR TO GENERAL SIGNAL AND WARNING ALL TRAFFIC CONTROL DEVICES AS MAY BE REQUIRED BY THE STANDARDS LISTED IN NOTE 1. ABOVE TO INSURE THE SAFE MOVEMENT OF VEHICULAR, BICYCLE, AND PEDESTRIAN TRAFFIC THROUGHOUT THE WORK AREA AND PROVIDE MAXIMUM PROTECTION AND SAFETY TO CONSTRUCTION WORKERS AND THE PUBLIC. ALL TRAFFIC CONTROL DEVICES SHALL BE USED AS THE BACKGROUND FOR ALL CONSTRUCTION WORK ZONE AND WARNING SIGNS USED WITHIN A WORKING TRAFFIC CONTROL AREA.
- ALL TRAFFIC CONTROL DEVICES SHALL BE REMOVED FOLLOWING COMPLETION OF EACH CONSTRUCTION WORK ZONE AND WARNING SIGNS USED WITHIN A WORKING TRAFFIC CONTROL AREA.
- ALL TYPE 4 OR 5 BARRICADES LEFT ON THE WORKSITE OVERNIGHT SHALL BE RETROREFLECTED AND HAVE YELLOW FLUORESCENT REFLECTORS ATTACHED TO THE TOP OF THE BARRICADE.
- IT IS THE RESPONSIBILITY OF THE CONTRACTOR TO MAINTAIN ACCESS TO ALL PUBLIC AND PRIVATE UTILITIES IN THE WORK AREA AND TO MAINTAIN ACCESS TO ALL LOCAL TRAFFIC SAFETY TO THE MAXIMUM EXTENT.
- AT LEAST ONE (1) WORKER SHALL REMAIN TO THE SIDE OF WORK. THE CONTRACTOR SHALL PROVIDE PORTABLE CHANGABLE MESSAGE SIGNS (CMS) THROUGHOUT THE WORK AREA THROUGHOUT THE PROJECT.
- WORK SHALL NOT COMMENCE UNTIL DITCHING PERMITS HAVE BEEN ISSUED BY THE CITY.
- ALL TEMPORARY TRAFFIC CONTROL DEVICES ARE TO BE REMOVED IN PLACE OR DOUBLE-ENDED FOR PROTECTION AGAINST WORK. THE CONTRACTOR SHALL PROVIDE VENTS TO THE SITE TO REMOVE OR TO BE ADDED DOWN OR ADJUSTED AS DIRECTED BY THE CONTRACTOR'S SPECIAL.

SIGN LEGEND:

CITY OF PERRIS
TRAFFIC CONTROL PLAN
 NUEVO ROAD
 FROM EVANS ROAD TO EL NIDO AVENUE
 PROJECT NO. PCT-19-001
 SHEET NO. 1
 OF 9 SHEETS
 CITY OF PERRIS
 PERRIS, CALIFORNIA
 DATE: 5/24/19
 DRAWN BY: [Signature]
 CHECKED BY: [Signature]

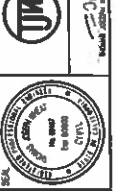

T.W. ENGINEERING, INC.
 T.W. ENGINEERING, INC.
 11000 N. GARDEN ST., SUITE 100
 GARDEN GROVE, CA 92640
 TEL: (714) 261-1111
 FAX: (714) 261-1112
 WWW: TWENGINEERING.COM

NO.	DATE	BY	REVISION
1	5/24/19	[Signature]	ISSUE FOR PERMITS
2	5/24/19	[Signature]	ISSUE FOR PERMITS

811
 Know what's below.
 Call before you dig.

-PHASE 2A-

CMS TO READ:
35MPH WORK AREA
USE CAUTION

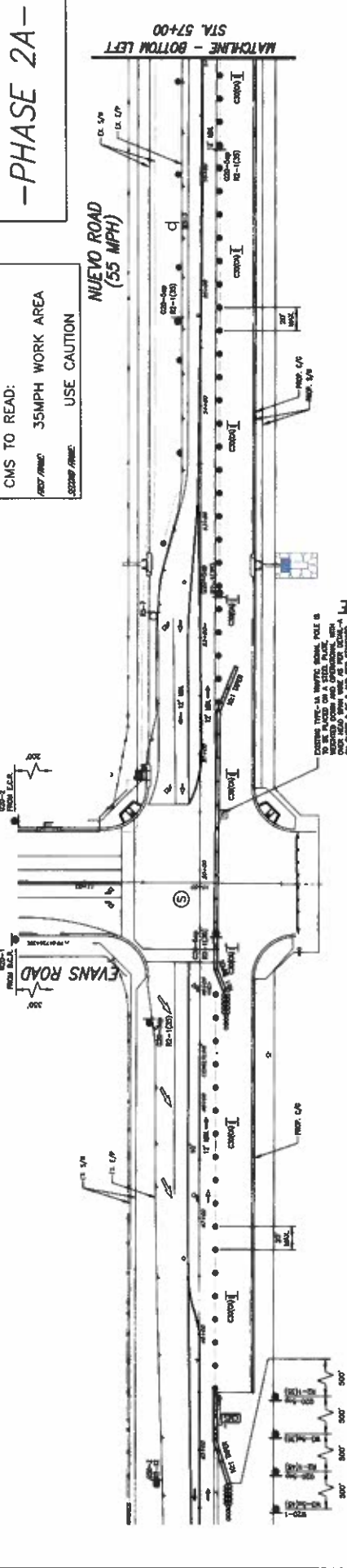

CONCRETE TYPE-III REINFORCED CONCRETE POLE IS INDICATED BY A DIAGONAL LINE THROUGH THE POLE. THIS INDICATES THAT THE POLE IS TO BE REINFORCED WITH TYPE-III CONCRETE. FOR ALL OTHER POLES, THIS INDICATES THAT THE POLE IS TO BE UNREINFORCED.

SEE SHEET 9 FOR DETOUR PLAN

SIGN LEGEND:

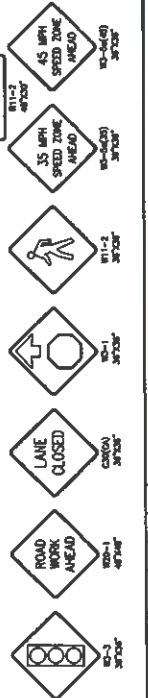

LEGEND:

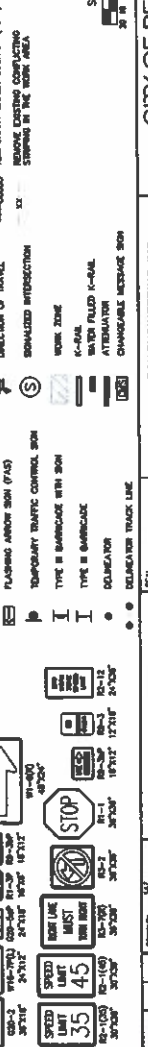

MARK DATE	BY	DATE	REVISIONS

CITY OF PERRIS
 DESIGNED BY: _____
 DATE: 05/17/19
 CHECKED BY: _____
 DATE: 05/17/19
 APPROVED BY: _____
 DATE: 5/23/19



T.M. ENGINEERING, INC.
 T.M. ENGINEERING, INC.
 11111
 11111
 11111

CITY OF PERRIS
WORKSITE TRAFFIC CONTROL PLAN
 NUEVO ROAD
 FROM STA. 44+55 TO STA. 67+00
 SHEET NO. **3**
 OF **9** SHEETS
 T.M. ENGINEERING, INC. PCT-19-001
 PLAN NO. PB-1224

-PHASE 2B-

CMS TO READ:
 35MPH WORK AREA
 USE CAUTION

**NEWUO ROAD
 (55 MPH)**

MATCHLINE - UPPER LEFT
 STA. 57+00

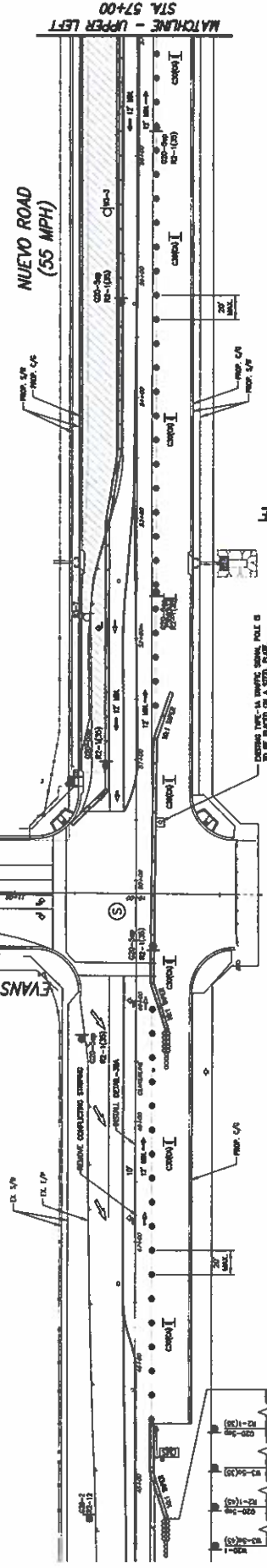

REMOVE THE ALL WORKER SIGNAL PILE 6
 TO BE PLACED ON A SPLIT PILE. WITH
 BRASS SHIELD AND CHAIN. WITH
 ON ONE END 2' OF A 1" DIA POLYURETHANE
 PIPING.

MATCHLINE - TOP RIGHT
 STA. 57+00

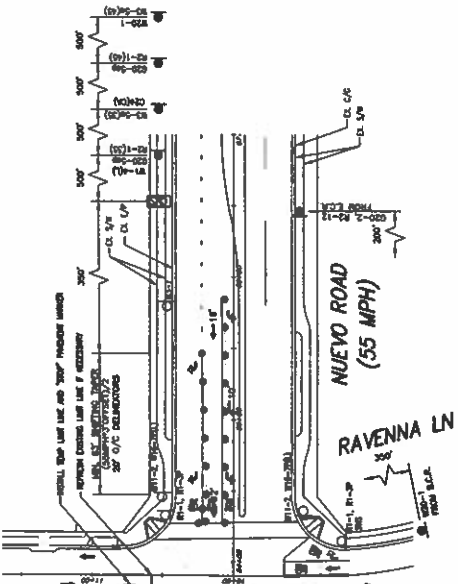

- LEGEND:**
- ROAD WORK AHEAD
 - LANE CLOSED
 - ROAD CLOSED
 - SHOULDER CLOSED
 - SHOULDER CLOSED AHEAD
 - 35 MPH SPEED ZONE AHEAD
 - 45 MPH SPEED ZONE AHEAD
 - STOP
 - ROAD WORK AHEAD
 - LANE CLOSED
 - ROAD CLOSED
 - SHOULDER CLOSED
 - SHOULDER CLOSED AHEAD
 - 35 MPH SPEED ZONE AHEAD
 - 45 MPH SPEED ZONE AHEAD
 - STOP
 - ROAD WORK AHEAD
 - LANE CLOSED
 - ROAD CLOSED
 - SHOULDER CLOSED
 - SHOULDER CLOSED AHEAD
 - 35 MPH SPEED ZONE AHEAD
 - 45 MPH SPEED ZONE AHEAD
 - STOP

- SIGN LEGEND:**
- W11-2
 - W11-3
 - W11-4
 - W11-5
 - W11-6
 - W11-7
 - W11-8
 - W11-9
 - W11-10
 - W11-11
 - W11-12
 - W11-13
 - W11-14
 - W11-15
 - W11-16
 - W11-17
 - W11-18
 - W11-19
 - W11-20
 - W11-21
 - W11-22
 - W11-23
 - W11-24
 - W11-25
 - W11-26
 - W11-27
 - W11-28
 - W11-29
 - W11-30
 - W11-31
 - W11-32
 - W11-33
 - W11-34
 - W11-35
 - W11-36
 - W11-37
 - W11-38
 - W11-39
 - W11-40
 - W11-41
 - W11-42
 - W11-43
 - W11-44
 - W11-45
 - W11-46
 - W11-47
 - W11-48
 - W11-49
 - W11-50
 - W11-51
 - W11-52
 - W11-53
 - W11-54
 - W11-55
 - W11-56
 - W11-57
 - W11-58
 - W11-59
 - W11-60
 - W11-61
 - W11-62
 - W11-63
 - W11-64
 - W11-65
 - W11-66
 - W11-67
 - W11-68
 - W11-69
 - W11-70
 - W11-71
 - W11-72
 - W11-73
 - W11-74
 - W11-75
 - W11-76
 - W11-77
 - W11-78
 - W11-79
 - W11-80
 - W11-81
 - W11-82
 - W11-83
 - W11-84
 - W11-85
 - W11-86
 - W11-87
 - W11-88
 - W11-89
 - W11-90
 - W11-91
 - W11-92
 - W11-93
 - W11-94
 - W11-95
 - W11-96
 - W11-97
 - W11-98
 - W11-99
 - W11-100

- LEGEND:**
- FLUORESCENT ARROW SIGN (FAS)
 - TEMPORARY TRAFFIC CONTROL SIGN
 - TYPE B BARRICADE WITH SIGN
 - TYPE B BARRICADE
 - DEBRIS/AVOID
 - DOUBLE/LEADER TRACK LINE
 - EMERGENCY CROSS CLOSURE (ECC)
 - EMERGENCY CROSS CLOSURE (ECC) STRAPPING IN THE WORK AREA
 - DIRECTION OF TRAVEL
 - SIGNALIZED INTERSECTION
 - WORK ZONE
 - N-SHALE
 - WATER FILLED P-SHALE
 - ATTENUATOR
 - CHANGEABLE MESSAGE SIGN

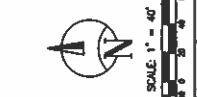

CITY OF PERRIS		SHEET NO. 4	CITY OF PERRIS WORKSITE TRAFFIC CONTROL PLAN NUEVO ROAD FROM STA. 44+35 TO STA. 67+00 TWP PROJ. NUMBER: PCT-19-001 SHEET NO. PB-1224
T&W ENGINEERING, INC. 4150 Sycamore Drive Perris, CA 92370 951-852-7200 www.tandw.com		SCALE: 1" = 40' DATE: 05/27/19 DRAWN: [Name] CHECKED: [Name] APPROVED: [Name]	
REVIEWED BY: [Name] DATE: 05/27/19 CITY: Perris		PERMITTED BY: [Name] DATE: 05/27/19 CITY: Perris	
CDD (CA) SHOULDER CLOSED 48'x24' ROAD WORK AHEAD W11-1 48'x24' W11-2 48'x24' W11-3 48'x24' W11-4 48'x24' W11-5 48'x24' W11-6 48'x24' W11-7 48'x24' W11-8 48'x24' W11-9 48'x24' W11-10 48'x24' W11-11 48'x24' W11-12 48'x24' W11-13 48'x24' W11-14 48'x24' W11-15 48'x24' W11-16 48'x24' W11-17 48'x24' W11-18 48'x24' W11-19 48'x24' W11-20 48'x24' W11-21 48'x24' W11-22 48'x24' W11-23 48'x24' W11-24 48'x24' W11-25 48'x24' W11-26 48'x24' W11-27 48'x24' W11-28 48'x24' W11-29 48'x24' W11-30 48'x24' W11-31 48'x24' W11-32 48'x24' W11-33 48'x24' W11-34 48'x24' W11-35 48'x24' W11-36 48'x24' W11-37 48'x24' W11-38 48'x24' W11-39 48'x24' W11-40 48'x24' W11-41 48'x24' W11-42 48'x24' W11-43 48'x24' W11-44 48'x24' W11-45 48'x24' W11-46 48'x24' W11-47 48'x24' W11-48 48'x24' W11-49 48'x24' W11-50 48'x24' W11-51 48'x24' W11-52 48'x24' W11-53 48'x24' W11-54 48'x24' W11-55 48'x24' W11-56 48'x24' W11-57 48'x24' W11-58 48'x24' W11-59 48'x24' W11-60 48'x24' W11-61 48'x24' W11-62 48'x24' W11-63 48'x24' W11-64 48'x24' W11-65 48'x24' W11-66 48'x24' W11-67 48'x24' W11-68 48'x24' W11-69 48'x24' W11-70 48'x24' W11-71 48'x24' W11-72 48'x24' W11-73 48'x24' W11-74 48'x24' W11-75 48'x24' W11-76 48'x24' W11-77 48'x24' W11-78 48'x24' W11-79 48'x24' W11-80 48'x24' W11-81 48'x24' W11-82 48'x24' W11-83 48'x24' W11-84 48'x24' W11-85 48'x24' W11-86 48'x24' W11-87 48'x24' W11-88 48'x24' W11-89 48'x24' W11-90 48'x24' W11-91 48'x24' W11-92 48'x24' W11-93 48'x24' W11-94 48'x24' W11-95 48'x24' W11-96 48'x24' W11-97 48'x24' W11-98 48'x24' W11-99 48'x24' W11-100 48'x24'		811 Call before you dig.	

LEGEND:

- FLASHING ARROW SIGN (FAS)
- TEMPORARY TRAFFIC CONTROL SIGN
- TYPE II BARRIER WITH SIGN
- TYPE II BARRIER
- COLLIAMTOR
- COLLIAMTOR TRACK LINE
- TEMPORARY ORANGE CONES (TOC)
- SIGNALIZED INTERSECTION
- WORK ZONE
- WATER FILLED E-DIAL
- ATTENTION
- CHANGEABLE MESSAGE SIGN
- ADVANCE WARNING OF CONSTRUCTION STOPPING IN THE WORK AREA

CONTRACTOR TO CHECK SIGNING BEFORE
LIMIT SIGN ON MAJURO ROAD TO AVOID
CONFLICT WITH WORK ZONE.

CMS TO READ:
35MPH WORK AREA
USE CAUTION

-PHASE 3B-

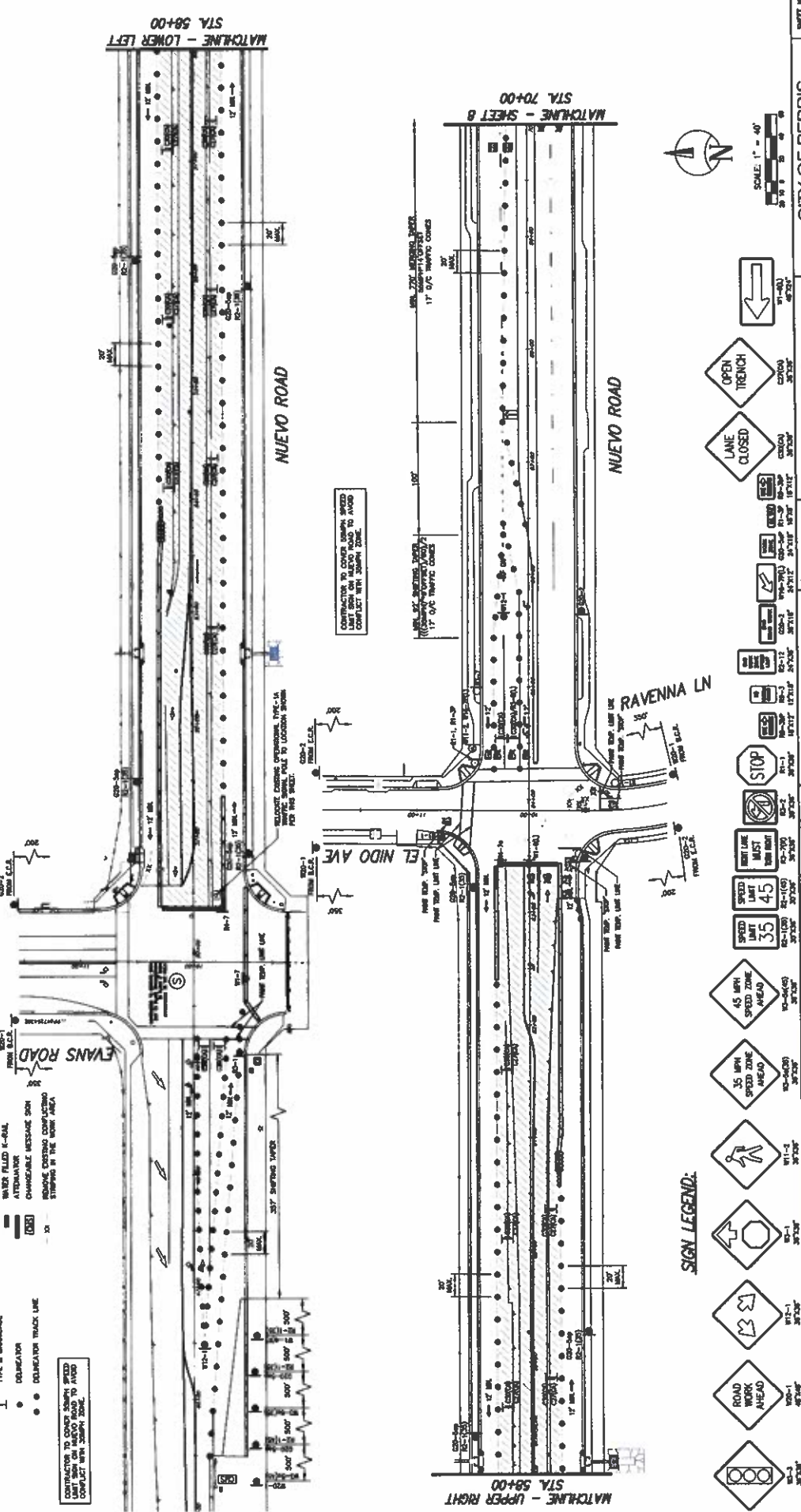

		SHEET NO. 7 OF 9 SHEETS PG-1224
CITY OF PERRIS WASTEWATER TREATMENT PLANT FROM STA. 45+00 TO STA. 70+00 LATEST TELEPHONE NO. PCT-18-001		DATE OF WORK APPROVAL
JAW ENGINEERING, INC. Traffic Engineering & Construction 17700 E. Highway 91, Suite 200, Perris, CA 92504 (951) 221-1111 www.jaweng.com		DATE OF CONTRACT APPROVAL
CITY OF PERRIS RECEIVED BY DATE		DATE OF CONTRACT APPROVAL
CITY OF PERRIS RECEIVED BY DATE		DATE OF CONTRACT APPROVAL

- SIGN LEGEND:**
- ROAD WORK AHEAD
 - 45 MPH SPEED ZONE AHEAD
 - 35 MPH SPEED ZONE AHEAD
 - 45 MPH SPEED ZONE
 - 35 MPH SPEED ZONE
 - LANE CLOSED
 - OPEN TRENCH

811
 Call before you dig
 www.811.com

EL NIDO AVENUE SB DETOUR PLAN (PHASE 2 & 3)

SB EL NIDO AVENUE DETOUR ROUTE:

- ADDISON WAY
- EVANS ROAD
- NUEVO ROAD

DETOUR SIGN LEGEND:

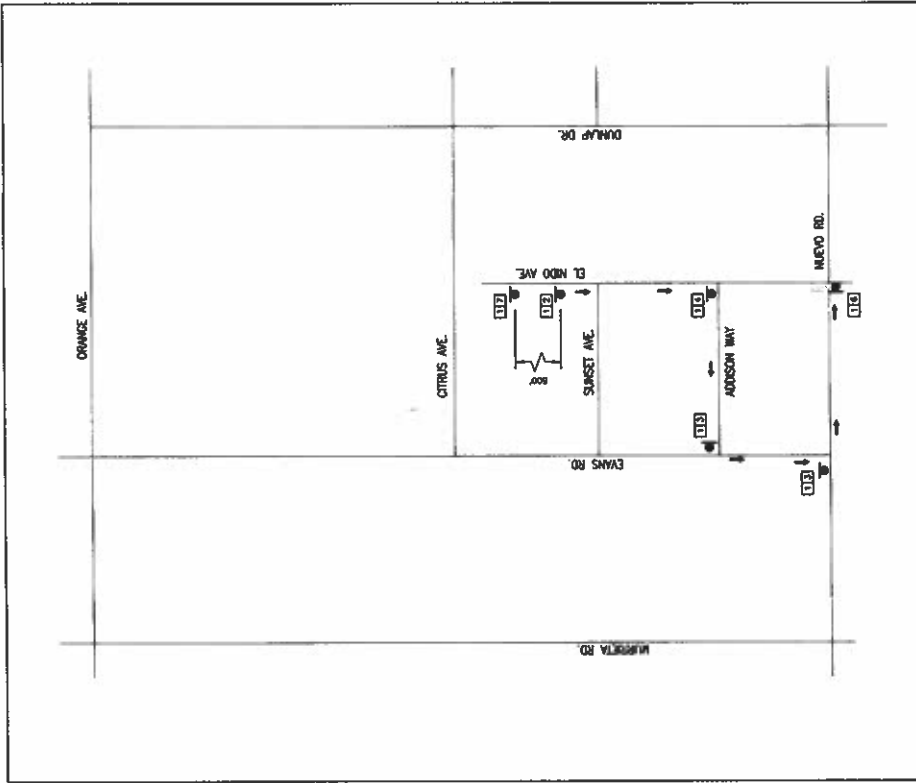
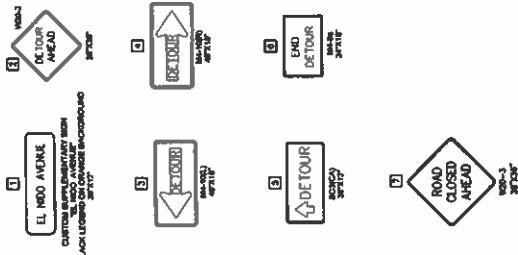

 Know what's Call before you dig.	DATE: 02/24/2019 TIME: 11:42:49 AM	DRAWN BY: [Blank] CHECKED BY: [Blank]	PROJECT NO.: PCT-19-001 SHEET NO.: 9 OF 9 SHEETS PG. 6-1224
	CITY OF PERRIS WORKSITE TRAFFIC CONTROL PLAN DETOUR PLAN EL NIDO AVENUE	T&J ENGINEERING, INC. Traffic Planning & Control 17081 E. Main St., Suite 200 Perris, CA 92370 (951) 221-1111 www.tandjeng.com	SEAL: [Blank] CITY OF PERRIS RECEIVED BY: [Blank] DATE: [Blank]



THE CONTRACTOR SHALL BE RESPONSIBLE FOR OBTAINING ALL NECESSARY PERMITS FROM THE CITY OF PERRIS AND THE CALIFORNIA DEPARTMENT OF INDUSTRIAL RELATIONS AND THE CALIFORNIA DEPARTMENT OF INDUSTRIAL RELATIONS AND THE CALIFORNIA DEPARTMENT OF INDUSTRIAL RELATIONS...

VTA CONSULTING ENGINEERS
1718 E. WASHINGTON AVENUE, SUITE 200
PERRIS, CALIFORNIA 92370
TEL: 951-271-4223 FAX: 951-271-4222

REVISION
DATE
BY

GENERAL NOTES

- 1. UNLESS OTHERWISE NOTED, THE DIMENSIONS SHOWN IN THESE NOTES ARE VTA CONSULTING ENGINEERS' DIMENSIONS TO THE CITY OF PERRIS, CALIFORNIA.
2. THE OWNER REPRESENTS TO BE THE CITY OF PERRIS, CALIFORNIA.
3. ALL DIMENSIONS ARE TO FACE UNLESS OTHERWISE NOTED.
4. ALL DIMENSIONS ARE TO FACE UNLESS OTHERWISE NOTED.

- 5. ALL DIMENSIONS ARE TO FACE UNLESS OTHERWISE NOTED.
6. ALL DIMENSIONS ARE TO FACE UNLESS OTHERWISE NOTED.
7. ALL DIMENSIONS ARE TO FACE UNLESS OTHERWISE NOTED.
8. ALL DIMENSIONS ARE TO FACE UNLESS OTHERWISE NOTED.

- 9. ALL DIMENSIONS ARE TO FACE UNLESS OTHERWISE NOTED.
10. ALL DIMENSIONS ARE TO FACE UNLESS OTHERWISE NOTED.
11. ALL DIMENSIONS ARE TO FACE UNLESS OTHERWISE NOTED.
12. ALL DIMENSIONS ARE TO FACE UNLESS OTHERWISE NOTED.

- 13. ALL DIMENSIONS ARE TO FACE UNLESS OTHERWISE NOTED.
14. ALL DIMENSIONS ARE TO FACE UNLESS OTHERWISE NOTED.
15. ALL DIMENSIONS ARE TO FACE UNLESS OTHERWISE NOTED.
16. ALL DIMENSIONS ARE TO FACE UNLESS OTHERWISE NOTED.

- 17. ALL DIMENSIONS ARE TO FACE UNLESS OTHERWISE NOTED.
18. ALL DIMENSIONS ARE TO FACE UNLESS OTHERWISE NOTED.
19. ALL DIMENSIONS ARE TO FACE UNLESS OTHERWISE NOTED.
20. ALL DIMENSIONS ARE TO FACE UNLESS OTHERWISE NOTED.

- 21. ALL DIMENSIONS ARE TO FACE UNLESS OTHERWISE NOTED.
22. ALL DIMENSIONS ARE TO FACE UNLESS OTHERWISE NOTED.
23. ALL DIMENSIONS ARE TO FACE UNLESS OTHERWISE NOTED.
24. ALL DIMENSIONS ARE TO FACE UNLESS OTHERWISE NOTED.

CONTRACTOR RESPONSIBILITY: THE CONTRACTOR SHALL BE RESPONSIBLE FOR OBTAINING ALL NECESSARY PERMITS FROM THE CITY OF PERRIS AND THE CALIFORNIA DEPARTMENT OF INDUSTRIAL RELATIONS AND THE CALIFORNIA DEPARTMENT OF INDUSTRIAL RELATIONS...

CONTRACTOR RESPONSIBILITY: THE CONTRACTOR SHALL BE RESPONSIBLE FOR OBTAINING ALL NECESSARY PERMITS FROM THE CITY OF PERRIS AND THE CALIFORNIA DEPARTMENT OF INDUSTRIAL RELATIONS AND THE CALIFORNIA DEPARTMENT OF INDUSTRIAL RELATIONS...

GENERAL NOTES:

- THE WORK ON THIS PROJECT INVOLVES ALTERATIONS TO THE EXISTING ELECTRICAL SYSTEM TO ACHIEVE THE AMPLIFICATION INDICATED ON THE DRAWINGS. THE CONTRACTOR SHALL VISIT THE JOB SITE TO DETERMINE THE EXISTING ELECTRICAL SYSTEM AND TO PROVIDE COSTING INSTALLATION AS REQUIRED TO ACCOMMODATE THE CHANGES AND ADDITIONAL WORK, AND TO PROVIDE CONTINUING ELECTRICAL SERVICE FOR THOSE EXISTING PORTIONS OF THE PROJECT WHICH ARE TO REMAIN IN OPERATION.
- THESE DRAWINGS INDICATE THE FINISHED REQUIREMENTS FOR THE ELECTRICAL SYSTEM EQUIPMENT, CONTROLS, RACEWAYS AND DEVICES. DUE TO EXISTING CONDITIONS, INTERFERENCE OR FOR OTHER REASONS, THE CONTRACTOR MAY DESIRE TO INSTALL THE WORK IN A MANNER DIFFERENT FROM THAT SHOWN. SUCH CHANGES SHALL BE SUBMITTED TO THE CITY ENGINEER AND APPROVED IN WRITING BY THE PROFESSIONAL AND THE RECORD DRAWINGS SHALL BE ACCURATELY REVISED TO SHOW THE CHANGES AS COMPLETED.
- IN AREAS WHERE THERE ARE NO ALTERNATIONS INDICATED, THE EXISTING FACILITIES SHALL BE RETAINED IN SERVICE. IN CASE OF DOUBT, ASSUME THAT THE EXISTING ELECTRICAL SYSTEM IS TO REMAIN IN OPERATION THROUGHOUT THE CONSTRUCTION PERIOD AND THEREAFTER.
- THE ELECTRICAL CONTRACTOR SHALL MAINTAIN CONTINUITY OF ALL REMAINING ELECTRICAL AND COMMUNICATION SYSTEMS AFFECTED BY WORK.
- ALL DEVICES SHALL BE RE-SEALED WITH OTHER AHEAD OF TIME (ONE WEEK NOTICE).
- ELECTRICAL CONTRACTOR SHALL VERIFY FINAL LOCATION OF ALL EQUIPMENT WITH OWNER REPRESENTATIVE PRIOR TO INSTALLATION.
- CONTRACTOR SHALL VERIFY ALL LOCATIONS OF PROPOSED JUNCTION BOXES WITH OWNER REPRESENTATIVE PRIOR TO INSTALLATION. IT IS EMPHATIC THAT HANDHOLES/FULL BOXES/BOXES BE INSTALLED IN CONCERT WITH ALL LANDSCAPE ELEMENTS.
- ALL UNDERGROUND FULL BOXES SHALL BE INSTALLED FLUSH WITH GRADE. BOXES SHALL BE PLUMB IN GRADE. FULL BOXES SHALL HAVE BOOT DOWN COVER, AND STAINLESS STEEL BOLTS. BOXES TO BE PLACED AT RIGHT ANGLES TO HANDSCAPE EDGE. LD SHALL INDICATE "ELECTRIC" STREET LIGHTING OR AS REQUIRED FOR THE APPLICATION.
- CONTRACTOR SHALL PROVIDE ALL THE REQUIRED AUXILIARY JOINTS OR HANDHOLES TO FACILITATE THE INSTALLATION OF BRANCH CIRCUIT WORK.
- ALL ELECTRIC EQUIPMENT EXPOSED TO WEATHER OR INSTALLED OUTDOORS, SHALL BE WEATHERPROOF TYPE, INCLUDING BUT NOT LIMITED TO: SWITCHES, CONTACTS, BOXES, ETC.
- PROVIDE FULL HOPE IN ALL CONDUITS MARKED WITH "JSD".
- ELECTRICAL CONTRACTOR IS RESPONSIBLE TO INSTALL ALL EQUIPMENT WITH CLEARANCES AS REQUIRED PER CODE.
- ALL CONDUITS SHALL HAVE GREEN GROUND WIRE PER I.E.C.
- ALL UNDERGROUND CONDUITS SHALL BE INSTALLED AT 2" BELOW FINISH GRADE UNLESS OTHERWISE NOTED. ALL UTILITY UNDERGROUND CONDUITS SHALL BE INSTALLED PER UTILITY COMPANY STANDARDS AND DIRECTIONS.
- ALL UNDERGROUND CONDUITS SHALL BE PVC SCHEDULE 40 AND MINIMUM OF 1" UNLESS NOTED OTHERWISE.
- ALL CONDUITS SHALL BE COPPER THINW AND MINIMUM OF #12 UNLESS NOTED OTHERWISE.
- EXTREME CAUTION IN EXCAVATING AND TRENCHING ON THIS SITE TO AVOID EXISTING DUCTS, PIPES OR CONDUITS, ETC. AND TO PREVENT DAMAGE TO EXISTING UNDERGROUND UTILITIES OR STRUCTURES WHETHER OR NOT SHOWN AND INSTALLED BY ANY OTHER CONTRACTOR. THE CONTRACTOR SHALL IMMEDIATELY NOTIFY THE CITY ENGINEER AND THE PROJECT MANAGER SHOULD SUCH UNIDENTIFIED CONDITIONS BE DISCOVERED.
- NEW UNDERGROUND CONDUITS TO BE LOCATED IN LANDSCAPE AREA AND SHOWN ON EXISTING WALKWAYS OR DRIVEWAYS AS REQUIRED. CONTRACTOR TO PROVIDE STEEL PLATES ON WALKWAYS WHERE ANY TRENCHES LEFT OPENED. ALSO PROVIDE "CAUTION" TAPE IN LANDSCAPE AREAS WHERE TRENCHES LEFT OPENED. VERIFY EXACT RELOCATION WITH CITY. CONTRACTOR IS TO INSTALL ALL ELECTRICAL EQUIPMENT TO MATCH EXISTING FINISH AND TO THE SATISFACTION OF THE CITY PROJECT MANAGER (FULL VISUAL VERIFICATION).

GENERAL NOTES:

- SOME SITES MAY HAVE EXISTING LIGHTING CONTROLS. PROVIDE A DETAIL ALTERNATE FOR LIGHTING CONTROLS.

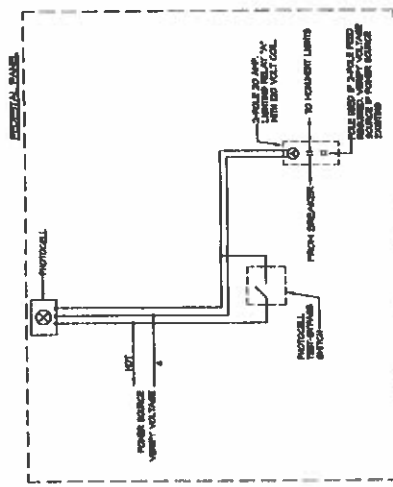

(B) LIGHTING CONTROL DIAGRAM
NOT TO SCALE

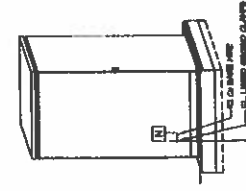
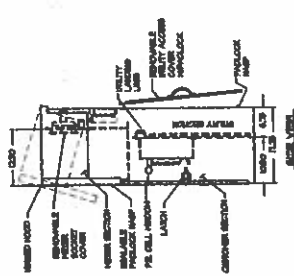
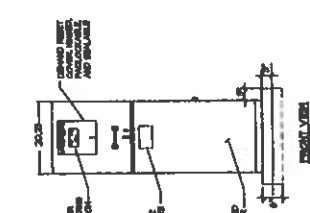
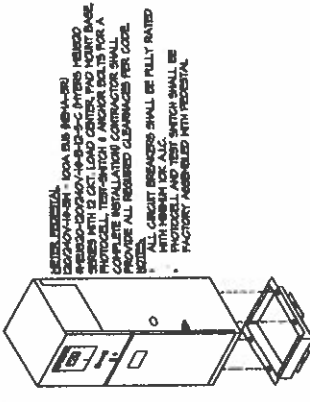

(C) NEW METER PRECAST PANEL DETAIL
SCALE 1/8" = 1'-0"

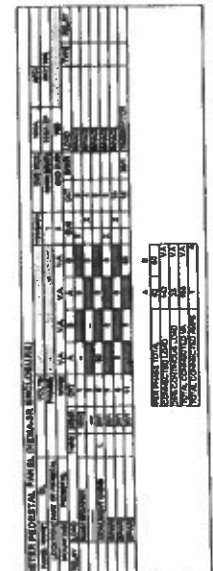

(D) GENERAL ELECTRICAL PANEL DETAIL
SCALE 1/8" = 1'-0"

BID NOTES

- SOME SITES MAY HAVE EXISTING LIGHTING CONTROLS. PROVIDE A DETAIL ALTERNATE FOR LIGHTING CONTROLS.

-PHASE 2A-

CMS TO READ:
 35MPH WORK AREA
 USE CAUTION

**NUOVO ROAD
 (55 MPH)**

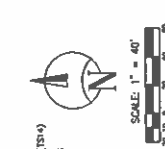
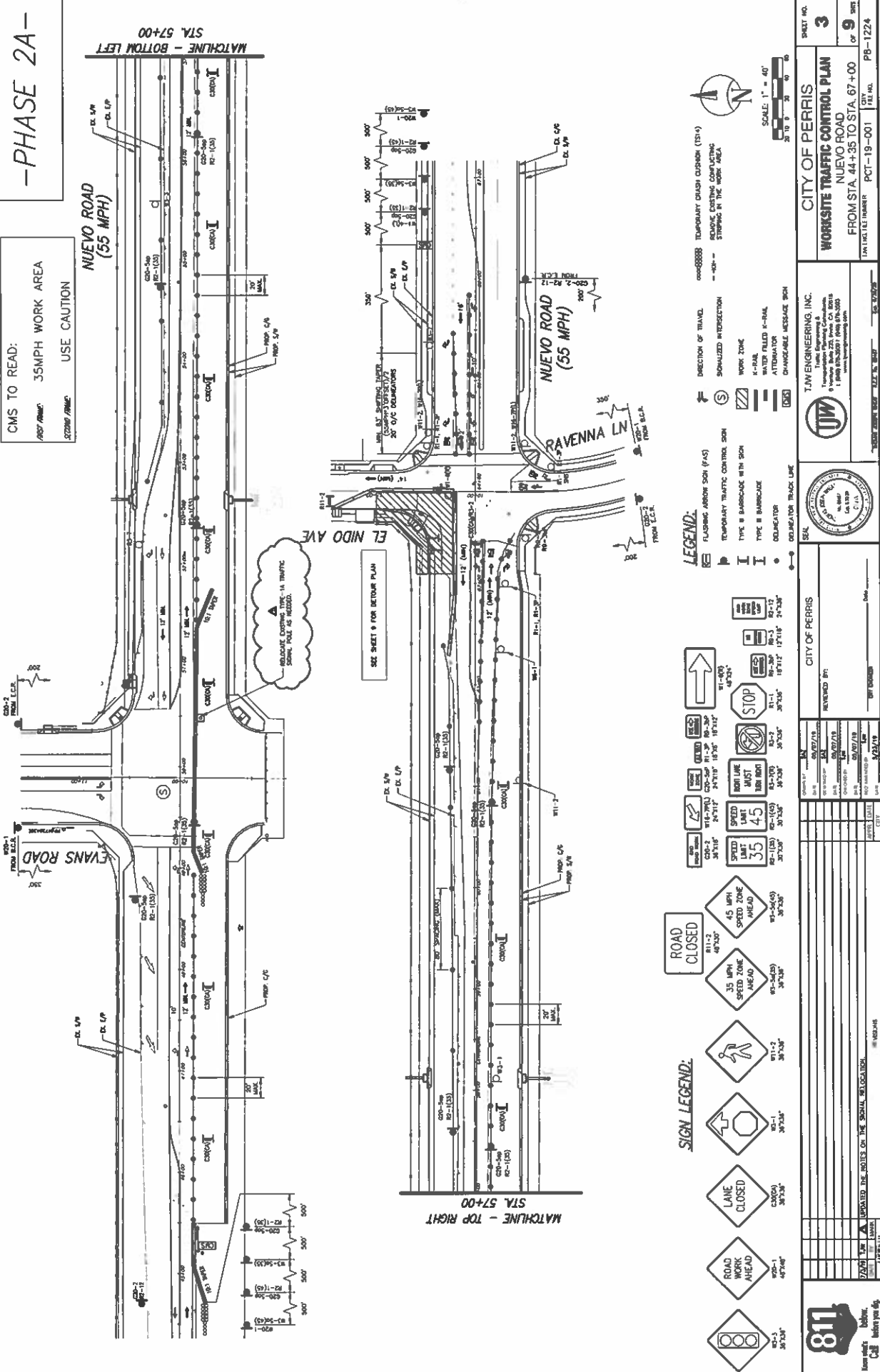

- LEGEND:**
- ROAD CLOSED
 - LANE CLOSED
 - ROAD WORK AHEAD
 - 45 MPH SPEED ZONE AHEAD
 - 35 MPH SPEED ZONE AHEAD
 - ROAD CLOSED
 - LANE CLOSED
 - ROAD WORK AHEAD
 - 45 MPH SPEED ZONE AHEAD
 - 35 MPH SPEED ZONE AHEAD
 - ROAD CLOSED
 - LANE CLOSED
 - ROAD WORK AHEAD
 - 45 MPH SPEED ZONE AHEAD
 - 35 MPH SPEED ZONE AHEAD

CITY OF PERRIS
WORKSITE TRAFFIC CONTROL PLAN
 NUOVO ROAD
 FROM STA. 44+35 TO STA. 67+00
 PCT-19-001
 CITY: PERRIS
 SHEET NO. **3**
 OF **9**

TJM ENGINEERING, INC.
 Traffic Engineering & Construction
 11000 Valley View Dr., Suite 200
 Perris, CA 92570
 (951) 221-1111



CITY OF PERRIS

DATE	BY	REVISION
07/20/19	TJM	ISSUED FOR PERMITS
07/20/19	TJM	REVISED PER CITY ENGINEERING
07/20/19	TJM	REVISED PER CITY ENGINEERING
07/20/19	TJM	REVISED PER CITY ENGINEERING
07/20/19	TJM	REVISED PER CITY ENGINEERING

811
 Before you dig, Call before you dig.
 811 Perris, CA



**ALESHIRE &
WYNDER LLP**
ATTORNEYS AT LAW

ORANGE COUNTY | LOS ANGELES | RIVERSIDE | CENTRAL VALLEY

Eric L. Dunn
edunn@awattorneys.com
(951) 241-7338

3880 Lemon Street, Suite 520
Riverside, CA 92501
P (951) 241-7338
F (951) 300-0985

AWATTORNEYS.COM

June 13, 2019

Via Certified Mail

ParkWest Associates/ East West Properties
235 Park Avenue South, 8th Floor
New York, NY 10003
Attn: Michael Palin

Re: **City of Perris ParkWest Development Agreement – Notice of Commencement of Construction and Demand for Payment of Note Amount**

Dear Mr. Palin:

The City of Perris (“City”) and ParkWest Associates/East West Properties (“Developer”) entered into that certain Amendment No. 1 to ParkWest Development Agreement dated on or about January 30, 2018 (“Amendment”). The Amendment extended the term of the Development Agreement for an additional 10 years, to January 27, 2028. Section 4 of the Amendment provided that in consideration for the extension, the Developer agreed to pay to City a Public Benefit Fee of \$2,000,000. The Public Benefit Fee was further memorialized in a Promissory Note (“Note”) and Deed of Trust.

Pursuant to Section 2 of the Note, Developer/Maker shall pay the entire Note Amount prior to the Maturity Date, which is City’s commencement of construction of the Nuevo Crossing Improvements. City/Holder shall provide written notice to Developer/Maker of the date City intends to commence construction. City has now issued a request for bids for the Nuevo Crossing Improvements. As noted on the attached cover page, the bid opening will be on July 8, 2019, the expected award of contract is July 30, 2019, and the mandatory start of construction will be August 19, 2019.

This letter is notice of City’s intent to begin construction of the Nuevo Crossing Improvements, and demand for payment of the \$2 million Public Benefit Fee pursuant to the Note and Deed of Trust.

ParkWest Associates/ East West Properties
June 13, 2019
Page 2

Please contact me if you have any questions.

Sincerely,

ALESHIRE & WYNDER, LLP

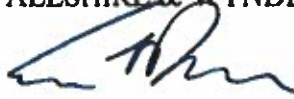
A handwritten signature in black ink, appearing to read "Eric L. Dunn", written over the printed name of the sender.

Eric L. Dunn
City Attorney

ELD:WGA
Attachment: Project Cover Page

cc: Dean Palin
John A. Ramirez, Esq.



July 15, 2019

via e-mail

City of Perris
Engineering Department
24 South "D" Street, Suite 100
Perris, CA 92570

Attn: Habib Motlagh, City Engineer

Re: Nuevo Road Widening (Evans Road to El Nido Avenue/Ravena Lane)
City Project No. P8-1224
Bid Opening: July 10, 2019

Subj: Bid Protest

Dear Mr. Motlagh:

This serves as a formal protest of the bids submitted by Hillcrest Contracting, Inc. (Hillcrest) and GMC Engineering, Inc. (GMC) on the above-referenced Contract, as their respective bids were incomplete and not in conformance with the bid documents.

Granite Construction Company (Granite) timely submitted a responsive bid to the City of Perris (City) for the above-referenced Contract on July 10, 2019 and has standing to submit this bid protest. Hillcrest was the apparent low bidder, GMC was the apparent second low bidder, and Granite was the apparent third low bidder.

The following requirements, which were not followed by Hillcrest or GMC, are clearly stated in the specifications:

- The bid documents checklist clearly instructed each bidder to “please insure (sic) that you have completed the following documents and have submitted originals with your proposal, as only responsive bids will be considered” and listed all documents to be completed.
- Page BF-1 of the Bid Forms clearly stated that “completion and submittal of all enclosed forms including, but not limited to sheets BF-9 & BF-10 is required and must be included with original bid. Failure to submit the required documents shall be deemed as an incomplete bid and shall not be considered by City as a valid bid.”

The following paragraphs detail certain apparent defects in the bids of both Hillcrest and GMC, specifically how each failed to comply with the bid instructions and submit complete documentation as required. Accordingly, the City must deem both bids non-responsive and invalid for award consideration.



GMC did not comply with the Instructions to Bidders in the following ways:

1. GMC did not complete the Equal Employment Opportunity Certification for proposed Subcontractors as required by Page BF-3.
2. GMC did not attest the signatures of the Principal or the Attorney in Fact as required on the Bid Bond, Page BF-8B. An incomplete bid bond provides GMC with a competitive and material advantage, if it can withdraw its bid without penalty after seeing the numbers.
3. GMC did not list any proposed substitutions on Page BF-10. Granite performed due diligence and called every vendor on the list to make sure they could supply the specified material. We learned that Fusion Products does not manufacture Cast Aluminum City Seals and obtained a quote from Storyland Studios. We also learned that Napa Valley Cast Stone is no longer in business and listed California Stonecraft, LLC.
4. GMC did not attest the signature as required on Page BF-11
5. GMC did not attest the signature as required on Page BF-12
6. GMC did not attest the signature as required on Page BF-13
7. GMC did not list the DIR registration date as required on Page BF-15. GMC also did not list the license type on Page BF-15 as is required in bold and underlined typing.

The numerous defects and omissions in RMC's bid noted above cannot be waived by the City. Bid variances that allow an unfair bidding opportunity must result in the bid being declared non-responsive and rejected. California courts have determined that deviations or variances may only be overlooked "if the variance **cannot have affected the amount of the bid or give the bidder an advantage or benefit not allowed other bidders.**" (*Konica Business Machines U.S.A., Inc. v. Regents of University of California* (1988) 206 Cal.App.3d 449, 454.) Here, as noted above, the defects within GMC's bids are numerous and certain of them are material—and should the City attempt to waive them, GMC will have an advantage not allowed other bidders, including Granite. Accordingly, because *Konica* does not allow the City to waive the defects in GMC's bid, the City must reject GMC's bid.

Hillcrest did not comply with the Instructions to Bidders in the following ways:

1. Hillcrest did not complete the Bid Schedule on Page BF-2D. The bid documents checklist clearly states that the bid schedule of values is to be submitted via Active Bidder and submitted via scanned documents BF-2A to BF 2D. Page BF-1 of the Bid Forms states that “completion and submittal of all enclosed forms including, but not limited to sheets BF-9 & BF-10 is required and must be included with original bid. Failure to submit the required documents shall be deemed as an incomplete bid and shall not be considered by City as a valid bid.”

Furthermore, Page BF-1 of the Bid Forms states that no separate payment will be made for any item that is not specifically set forth in the Schedule of Bid Items. All costs, therefore, shall be included in the prices named in the Schedule of Bid Items for the various appurtenant items of work. **In case of discrepancy between words and figures, words shall prevail.** In this case, Hillcrest did not write their bid total in words, nor is there any evidence that the person who submitted the numbers within the Active Bidder program is authorized to do so by Hillcrest.

2. Hillcrest did not complete the Equal Employment Opportunity Certification for proposed Subcontractors as required by Page BF-3.
3. Hillcrest did not fill in the name of the person who inspected the site or the date of the inspection on Page BF-7.
4. Hillcrest did not sign Addenda #1 as required. The document clearly states that “this **signed** Addendum must accompany your Bid on Active Bidder.” Specifically, this technicality within Hillcrest’s bid allowed Hillcrest to avoid being contractually bound, i.e., Hillcrest could have invoked Public Contract Code section 5103 and withdrawn its bid. Public Contract Code section 5103 applies when “[a] mistake was made ... [¶] ... [¶] ... in filling out the bid,” and the mistake ‘made the bid materially different than’ the bidder intended.” (*Bay Cities Paving & Grading, Inc. v. City of San Leandro* (2014) 223 Cal.App.4th 1181, 1197 [167 Cal.Rptr.3d 733].)
5. Hillcrest did not attest the signature of the Attorney in Fact as required on the Bid Bond, Page BF-8B. An incomplete bid bond provides Hillcrest with a competitive and material advantage since it can withdraw its bid without penalty after seeing the numbers
6. Hillcrest did not list any proposed substitutions on Page BF-10. Granite performed due diligence and called every vendor on the list to make sure they could supply the specified material. We learned that Fusion Products does not manufacture Cast Aluminum City Seals and obtained a quote from Storyland Studios. We also learned that Napa Valley Cast Stone is no longer in business and listed California Stonecraft, LLC.
7. There is no evidence of Corporate Seals on Pages BF-7, BF-8B, BF-11, BF-12, and BF-13.

The numerous defects and omissions in Hillcrest's bid noted above cannot be waived by the City. Bid variances that allow an unfair bidding opportunity must result in the bid being declared non-responsive and rejected. California courts have determined that deviations or variances may only be overlooked "if the variance **cannot have affected the amount of the bid or give the bidder an advantage or benefit not allowed other bidders.**" (*Konica Business Machines U.S.A., Inc. v. Regents of University of California* (1988) 206 Cal.App.3d 449, 454.) Here, as noted above, the defects within Hillcrest's bids are numerous and certain of them are material—and should the City attempt to waive them, Hillcrest will have an advantage not allowed other bidders, including Granite. Accordingly, because *Konica* does not allow the City to waive the defects in Hillcrest's bid, the City must reject Hillcrest's bid.

Summary

In summary, the bids submitted by Hillcrest and GMC did not comply with the Instructions to Bidders and other bidding procedures outlined within the documents issued for bid. Certain of these bid defects are material and cannot not be waived, as they give a substantial competitive advantage to Hillcrest and GMC over the other bidders, including Granite. Accordingly, Granite respectfully requests that the City uphold Granite's bid protest and find both bids to be non-responsive and award the Contract to Granite, as the lowest responsive and responsible bidder.

Thank you for your attention to the concerns outlined in this letter. If you have any questions, please contact me at (760) 391-6247.

Sincerely,

GRANITE CONSTRUCTION COMPANY



Joe Richardson
Chief Estimator

Attachments:

1. Bid Document Checklist
2. Page BF-1 of the Bid Forms
3. Bid Submitted by Hillcrest
4. Bid Submitted by GMC
5. Bid Submitted by Granite

Bid Protest - Nuevo Road Widening - Bid Date 7/10/19

Richardson, Joe <Joe.Richardson@gcinc.com>

Wed, Jul 17, 2019 at 9:43 PM

To: Habib Motlagh <habib@trilakeconsultants.com>

Cc: Brad Brophy <brad@trilakeconsultants.com>, "sharon@trilakeconsultants.com" <sharon@trilakeconsultants.com>

Hi Habib,

Please see my additional comments below in blue for your review. Thank you again for your help.

[Quoted text hidden]

[Quoted text hidden]

Page 3 – Item 1 - Regarding BF-2A to BF-2D: It is true that the forms were not completed with bid totals due to the receipt of last minute pricing and bid closing the update documents were not re-scanned and re-submitted. Since this was an electronic bid proposal, Hillcrest submitted the completed bid schedule through Active Bidder on time. Hillcrest can provide the completed documents upon request. – **This form was not completed per the Instructions to Bidders and the timeframe to correct clerical errors had passed prior to this response. There is no evidence that the person who submitted the numbers within the Active Bidder program is authorized to do so by Hillcrest. In case of discrepancy between words and figures, words shall prevail and no words were filled out by Hillcrest.**

Page 3 – Item 2 – Regarding BF-3: Hillcrest Contracting acknowledged Equal Employment Opportunity Certification. Further acknowledgement from the listed sub-contractors can be provided upon request. – **Hillcrest completed it for themselves, but did not complete it for the Subcontractors as is required by the form.**

Page 3 – Item 3 – Regarding BF-7: It is true the name of the person who inspected was not included. Jason G. Jones inspected the site. Hillcrest can provide the completed documents upon request. – **This form was not completed and the timeframe to correct clerical errors passed prior to this response.**

Page 3 – Item 4 – Regarding Addendum #1: Hillcrest Contracting acknowledged receipt of Addenda #1 on BF-7. The bid was also submitted on the revised bid date of July 10, 2019 as stated in Addendum #1. – **Hillcrest did not sign Addenda #1 as required. The document clearly states that "this signed Addendum must accompany your Bid on Active Bidder.**

Page 3 – Item 5 – Regarding BF-8B: Hillcrest contends that the bid bond was signed and submitted as complete. – **It is clear that this form was not complete, as Hillcrest did not attest the signature of the Attorney in Fact as required on the Bid Bond**

Page 3 – Item 6 – Regarding BF-10: Fusion Products is a legitimate supplier. California Stonecraft is the current manufacturer of the cast stone product and sells it as Napa Valley Cast Stone. This is a technicality. **Fusion Products is a legitimate supplier, but they do not manufacture the Cast Aluminum City Seals. I will forward a separate e-mail we received from Fusion Products that verifies this fact. Hillcrest did not call suppliers pre-bid and this gave them a material advantage by allowing them to price these items at a unrealistically low price. They can potentially request a Change Order after award of the job once it is realized that the specified providers do not manufacture the products called out. Granite ensured that all parts and pieces were priced appropriately and provided the City with a complete bid.**

Page 3 – Item 7 – Regarding Corporate Seals: Our corporate seal stamp is embossed and unfortunately did not translate to the scanned documents. Hillcrest can provide the hard copy documents upon request. – **Agreed, this could be the**

case.

[Quoted text hidden]



GENERAL ENGINEERING CONTRACTORS
P.O. BOX 1898, CORONA, CA 92878-1898
PH: (951) 273-9600 || FAX: (951) 273-9608

July 17, 2019

Mr. Habib Motlagh
Tri Lake Consultants
24 S. D St., #100
Perris, CA 92570

Project: Nuevo Rd. Widening Bid – City of Perris

Ref: Bid Protest Letter – Granite Construction

Dear Mr. Motlagh:

This letter is in response to the Nuevo Rd. Widening Bid – City of Perris bid protest letter dated July 15, 2019. I specifically address the Granite's list of alleged Hillcrest non-compliance items beginning on page 3 of their letter.

Page 3 – Item 1 - Regarding BF-2A to BF-2D: It is true that the forms were not completed with bid totals due to the receipt of last minute pricing and bid closing the update documents were not re-scanned and re-submitted. Since this was an electronic bid proposal, Hillcrest submitted the completed bid schedule through Active Bidder on time. Hillcrest can provide the completed documents upon request.

Page 3 – Item 2 – Regarding BF-3: Hillcrest Contracting acknowledged Equal Employment Opportunity Certification. Further acknowledgement from the listed sub-contractors can be provided upon request.

Page 3 – Item 3 – Regarding BF-7: It is true the name of the person who inspected was not included. Jason G. Jones inspected the site. Hillcrest can provide the completed documents upon request.

Page 3 – Item 4 – Regarding Addendum #1: Hillcrest Contracting acknowledged receipt of Addenda #1 on BF-7. The bid was also submitted on the revised bid date of July 10, 2019 as stated in Addendum #1.

Page 3 – Item 5 – Regarding BF-8B: Hillcrest contends that the bid bond was signed and submitted as complete.

Page 3 – Item 6 – Regarding BF-10: Fusion Products is a legitimate supplier. California Stonecraft is the current manufacturer of the cast stone product and sells it as Napa Valley Cast Stone. This is a technicality.

Page 3 – Item 7 – Regarding Corporate Seals: Our corporate seal stamp is embossed and unfortunately did not translate to the scanned documents. Hillcrest can provide the hard copy documents upon request.

If you have any questions, please do not hesitate to contact me jason@hillcrestcontracting.com or at 951-283-5601

Sincerely,

Jason G. Jones
Hillcrest Contracting
Estimator / Project Manager

Michael Morales

From: jason@hillcrestcontracting.com
Sent: Friday, July 19, 2019 2:17 PM
To: Michael Morales; Habib Motlagh
Cc: Sharon Erb; Stuart McKibbin
Subject: Nuevo Rd. Widening Proposal Dated 7/10/19 - Guarantee of BF-10 Materials and Schedule #2 & #3 Pricing

Importance: High

Michael and Habib,

Hillcrest agrees to the following in regards to the Nuevo Rd. Widening project which bid on 7/10/19.

1. Hillcrest Contracting Inc. will be using the City's specified product "Fusion Sign and Design" for the Cast Aluminum Seal and that no substitutes are proposed by Hillcrest as indicated on the original Form BF-10.
2. Barring any changes in design or scope from the project plan and specifications at bid time all prices indicated on Hillcrest's originally submitted Bid Schedule #2 and Bid Schedule #3, per the July 10, 2019 bid proposal will remain the same and will be honored by Hillcrest

Thank you,

Jason G. Jones
Hillcrest Contracting, Inc.
Office: 951-273-9600 x-120
Mobile: 951-283-5601





July 17, 2019

City of Perris
Engineering Department
24 South "D" Street, Suite 100
Perris, CA 92570

Attn: Brad Brophy, PE
Tri Lake Consultants

Re: Nuevo Road Widening (Evans Road to El Nido Avenue/Ravena Lane)
City Project No. P8-1224
Response to Bid Protest Submitted by Granite Construction Company

Dear Mr. Brophy,

We have carefully reviewed our submitted bid proposal, and find that GMC Engineering, Inc. did in fact submit a responsive and responsible bid.

In retort to the protest filed by Granite Construction Company, please see below:

Granite Protest #1: GMC did not complete the Equal Employment Opportunity Certification for proposed Subcontractors as required by Page BF-3.

GMC Response #1: Typically in the competitive bidding process for public works, quotes from subcontractors and material suppliers are received up until the very last minute. It would be next to impossible to fill out AND scan into the computer AND upload the Equal Opportunity Certification for every subcontractor to the Active Bidder online system, in addition to all of the other, much more critical, documents (bid bond, addenda, line items, etc.) Nonetheless, each and every subcontractor listed by GMC Engineering, Inc. has been in business (the construction industry) for many years and has an excellent reputation. **This information should be classified as a minor irregularity, and can be waived by the Agency per page 2 of Notice Inviting Bids.** We are being transparent, and for your reference have attached this paperwork since we were unable to do this at bid time due to the above-mentioned time constraints.

Granite Protest #2: GMC did not attest the signatures of the Principal or the Attorney in Fact as required on the Bid Bond, Page BF-8B. An incomplete bid bond provides GMC with a competitive and material advantage, if it can withdraw its bid without penalty after seeing the numbers.

GMC Response #2: The bid bond submitted by GMC Engineering, Inc. had two notarizations attached – one for the signature of the Attorney-in-Fact of the Bonding Company, and one for the signature of the President of GMC Engineering, Inc., Gennady Chizhik. The bond was executed in full, and Granite’s assertion that our bid bond is “incomplete” is completely inaccurate. In fact, the notarizations are the highest form of legal attestation.

Granite’s claim that our bid bond, as submitted, would “provide GMC with a competitive and material advantage”, is absolutely absurd. What is the incentive for us to spend time and resources putting together and submitting a competitive bid, only to withdraw it? On the contrary, the opposite is true – if we were to withdraw our bid, then all other bidders would have an advantage due to less competition. In our 22+ years in business as a successful public works contractor, we have never withdrawn a bid; furthermore, we even called the City on July 11th to see if we needed to deliver a hard copy of the bid bond or bid documents as is typically required by numerous other public agencies for the 3 apparent low bidders, and were told we would be contacted if this documentation was needed. **We clearly have no intention of withdrawing our bid; rather, our desire is for the City to consider GMC Engineering, Inc. as the lowest responsive, responsible bidder and award this contract to us.**

Granite Protest #3: GMC did not list any proposed substitutions on Page BF-10. Granite performed due diligence and called every vendor on the list to make sure they could supply the specified material. We learned that Fusion Products does not manufacture Cast Aluminum City Seals and obtained a quote from Storyland Studios. We also learned that Napa Valley Cast Stone is no longer in business and listed California Stonecraft, LLC.

GMC Response #3: GMC Engineering, Inc. has submitted as part of the bid package form BF-10. At the time of the bid and based on the quotes received, we were not made aware of any deviations or need for substitutions of specified manufacturers or material suppliers. GMC will be utilizing the services of Bravo Sign & Design, Inc., a contractor well known and respected in the industry, who we have completed public works projects with the sign portion ranging from \$5,000 to \$500,000. In fact, **Bravo Sign & Design, Inc. has completed another project for the City of Perris (D Street Improvements) utilizing the same components as on this project.**

If anything, the City of Perris should be concerned with the value of Granite Construction’s “Schedule B”, and their ability to perform this portion of work in compliance with Page BF-10 requirements. As it states at the top of Page BF-10, “the contractor should ascertain prior to bidding the acceptability of substitutes”. Did Granite Construction request and obtain the City’s approval for their substitutions prior to the bid? If so, then the City should have issued an Addendum so all bidders could have an equal opportunity to utilize the same sources. Addendum #1 clearly did not provide this information.

Granite Protest #4: GMC did not attest the signature as required on Page BF-11

GMC Response #4: Page BF-11 requires a seal “if Bid is by a Corporation”, which GMC provided. The “attest” line was left blank, as President of GMC Engineering, Inc. Gennady Chizhik had already signed on the same page several lines up. It would be redundant for him to sign the same sheet twice, attesting to his own signature. Furthermore, the last 2 sheets included

in the bid package is a resolution authorizing Gennady Chizhik to sign/execute all contracts and documents on behalf of GMC Engineering, Inc., followed by a notarization validating that document. That paperwork in itself is a formal attestation to Gennady Chizhik's signature on any and all contract documents that prefaced it.

Granite Protest #5: GMC did not attest the signature as required on Page BF-12

GMC Response #5: Please see response to #4

Granite Protest #6: GMC did not attest the signature as required on Page BF-13

GMC Response #6: Please see response to #4

Granite Protest #7: GMC did not list the DIR registration date as required on Page BF-15. GMC also did not list the license type on Page BF-15 as required in bold and underlined typing.

GMC Response #7: The DIR registration date and expiration date for GMC Engineering, Inc. and each listed subcontractor was included (and was specifically highlighted) on the printouts from the DIR Web Search immediately following Page BF-15. Not including the specific license type is a minor oversight, and per page 2 of the Notice Inviting Bids, "Agency may waive informalities, irregularities, or defects...". This information can be easily obtained via the CSLB website, and is attached for the City's reference.

Granite's comment regarding "bold and underlined typing" is clearly just how page BF-15 is formatted – the bottom line of each column title has a line running underneath it. It does not emphasize particular importance of those specific words over any others.

In summation, Granite Construction's claim that GMC Engineering, Inc.'s bid has "numerous defects and omissions" and "gives a substantial competitive advantage" is without merit!

It appears that Granite Construction Company's protest mentions numerous legal court cases and decisions that are not applicable to this bid, but rather more of an attempt to intimidate and influence the City's decision-making process. None of the so-called "issues" with our bid would justify the City of Perris spending additional taxpayer money to complete this project. Granite Construction came in 3rd both on just the base bid alone, and on the total bid, and are now being petty. **GMC Engineering, Inc. is the apparent lowest bidder on the base bid, and apparent second lowest bidder overall.**

We trust that the City of Perris will make the appropriate decision in awarding this project to the lowest, responsible and responsive bidder.

Respectfully Submitted,
GMC Engineering

Gennady Chizhik
President



Contractor's License Detail for License # 739091

DISCLAIMER: A license status check provides information taken from the CSLB license database. Before relying on this information, you should be aware of the following limitations.

CSLB complaint disclosure is restricted by law ([BAP 7124.6](#)) If this entity is subject to public complaint disclosure, a link for complaint disclosure will appear below. Click on the link or button to obtain complaint and/or legal action information.
Per [BAP 7071.17](#), only construction related civil judgments reported to the CSLB are disclosed.
Arbitrations are not listed unless the contractor fails to comply with the terms of the arbitration.
Due to workload, there may be relevant information that has not yet been entered onto the Board's license database.

Business Information

GMC ENGINEERING INC
1401 WARNER AVENUE #B
TUSTIN, CA 92780
Business Phone Number:(714) 247-1040

Entity Corporation
Issue Date 08/11/1997
Expire Date **08/31/2021**

License Status

This license is current and active.

All information below should be reviewed.

Classifications

[A - GENERAL ENGINEERING CONTRACTOR](#)
[B - GENERAL BUILDING CONTRACTOR](#)

Contractor's License Detail for License # 583125

DISCLAIMER: A license status check provides information taken from the CSLB license database. Before relying on this information, you should be aware of the following limitations.

CSLB complaint disclosure is restricted by law ([BAP 7124.6](#)) If this entity is subject to public complaint disclosure, a link for complaint disclosure will appear below. Click on the link or button to obtain complaint and/or legal action information.
Per [BAP 7071.17](#), only construction related civil judgments reported to the CSLB are disclosed.
Arbitrations are not listed unless the contractor fails to comply with the terms of the arbitration.
Due to workload, there may be relevant information that has not yet been entered onto the Board's license database.

Business Information

MACADEE ELECTRICAL CONSTRUCTION
4821 LANIER ROAD
CHINO, CA 91710
Business Phone Number:(909) 627-1336

Entity Corporation
Issue Date 12/19/1989
Expire Date **12/31/2019**

License Status

This license is current and active.

All information below should be reviewed.

Classifications

C10 - ELECTRICAL

Contractor's License Detail for License # 641391

DISCLAIMER: A license status check provides information taken from the CSLB license database. Before relying on this information, you should be aware of the following limitations.

CSLB complaint disclosure is restricted by law ([B&P 7124.6](#)) If this entity is subject to public complaint disclosure, a link for complaint disclosure will appear below. Click on the link or button to obtain complaint and/or legal action information.
Per [B&P 7071.17](#), only construction related civil judgments reported to the CSLB are disclosed.
Arbitrations are not listed unless the contractor fails to comply with the terms of the arbitration.
Due to workload, there may be relevant information that has not yet been entered onto the Board's license database.

Business Information

BRAVO SIGN & DESIGN INC
520 S CENTRAL PARK AVE E
ANAHEIM, CA 92802
Business Phone Number:(714) 284-0500

Entity Corporation
Issue Date 04/01/1992
Reissue Date 03/21/2012
Expire Date **03/31/2020**

License Status

This license is current and active.

All information below should be reviewed.

Classifications

A - GENERAL ENGINEERING CONTRACTOR
C-61 / D42 - NON-ELECTRICAL SIGN INSTALLATION

Contractor's License Detail for License # 394471

DISCLAIMER: A license status check provides information taken from the CSLB license database. Before relying on this information, you should be aware of the following limitations.

CSLB complaint disclosure is restricted by law ([BAP 7124.6](#)) If this entity is subject to public complaint disclosure, a link for complaint disclosure will appear below. Click on the link or button to obtain complaint and/or legal action information.
Per [BAP 7071.17](#), only construction related civil judgments reported to the CSLB are disclosed.
Arbitrations are not listed unless the contractor fails to comply with the terms of the arbitration.
Due to workload, there may be relevant information that has not yet been entered onto the Board's license database.

Business Information

MARTINEZ CONCRETE INC
920 W FOOTHILL BLVD
AZUSA, CA 91702
Business Phone Number:(626) 334-2979

Entity Corporation
Issue Date 10/21/1980
Expire Date **10/31/2020**

License Status

This license is current and active.

All information below should be reviewed.

Classifications

A - GENERAL ENGINEERING CONTRACTOR
C-8 - CONCRETE

Contractor's License Detail for License # 877686

DISCLAIMER: A license status check provides information taken from the CSLB license database. Before relying on this information, you should be aware of the following limitations.

CSLB complaint disclosure is restricted by law ([B&P 7124.6](#)) if this entity is subject to public complaint disclosure, a link for complaint disclosure will appear below. Click on the link or button to obtain complaint and/or legal action information.
Per [B&P 7071.12](#), only construction related civil judgments reported to the CSLB are disclosed.
Arbitrations are not listed unless the contractor fails to comply with the terms of the arbitration.
Due to workload, there may be relevant information that has not yet been entered onto the Board's license database.

Business Information

B C RENTALS LLC
dba B C TRAFFIC SPECIALIST

638 W SOUTHERN AVE
ORANGE, CA 92865
Business Phone Number:(714) 974-1190

Entity Ltd Liability
Issue Date 05/12/2006
Reissue Date 02/06/2019
Expire Date **02/28/2021**

License Status

This license is current and active.

All information below should be reviewed.

Classifications

[A - GENERAL ENGINEERING CONTRACTOR](#)
[C-61 / D42 - NON-ELECTRICAL SIGN INSTALLATION](#)
[C-61 / D06 - CONCRETE RELATED SERVICES](#)
[C-61 / D38 - SAND AND WATER BLASTING](#)
[C-61 / D64 - SWPPP](#)
[C31 - CONSTRUCTION ZONE TRAFFIC CONTROL](#)
[C32 - PARKING AND HIGHWAY IMPROVEMENT](#)
[B - GENERAL BUILDING CONTRACTOR](#)
[C-61 / D31 - POLE INSTALLATION AND MAINTENANCE](#)

The undersigned, as Bidder, proposes and agrees, if the proposal is accepted, that he will execute a Contract with the Agency in the form set forth in the Contract Documents and that he will accept in full payment thereof the preceding prices as set forth in Bid Schedules.

Quantities above are for the purpose of comparison only and payments will be made on the basis of actual measurement of work completed. Measurements which vary from estimated quantities, shall require verification by City, and a written change order will be required prior to payment. For quantities indicated as lump sum, Contractor shall be paid at the Contract per lump sum price indicated, and shall include full compensation for all work and no additional compensation will be allowed thereof. Where discrepancies occur between words and figures, the words shall govern. Upon receipt of the Notice of Award, Contractor shall submit to the Agency for approval, a detailed breakdown of the Contractor's cost estimate into the various elements of materials and construction operations. When approved, this breakdown will serve as a basis for the Agency to determine partial payments.

If awarded this contract, the Bidder agrees to execute the Contract and submit the Labor and Materials Payment Bond, Contract Performance Bond, and Insurance Certificates on the required forms within ten (10) calendar days from the date of the Notice of Award. The Notice of Award shall be accompanied by the necessary Contract, Bond, and Insurance Certificate forms. In case of failure of the Bidder to execute the Contract, the Agency may at his option consider the Bidder in default, in which case the Bid Bond, or any deposit in lieu thereof, accompanying the proposal shall become the property of the Agency. Forfeiture of the Bid Bond, or any deposit in lieu thereof, does not preclude the Agency from seeking all other remedies provided by law to recover losses sustained as a result of the Contractor's failure to execute a written agreement to perform the work at his Bid Price.

The Bidder's execution on the signature portion of this proposal shall also constitute an endorsement and execution of those certifications which are a part of this Proposal.

EQUAL EMPLOYMENT OPPORTUNITY CERTIFICATION

The bidder _____, proposed subcontractor Macadee Electrical, hereby certifies that he has , has not _____, participated in a previous contract or subcontract subject to the equal opportunity clause, as required by Executive Orders 10925, 11114, or 11246, and that, where required, he has filed with the Joint Reporting Committee, the Director of the Office of Federal Contract Compliance, a Federal Government contracting or administering agency, or the former President's Committee on Equal Employment Opportunity, all reports due under the applicable filing requirements.

NOTE: The above certification is required by the Equal Employment Opportunity

Regulations of the Secretary of Labor (41CFR 60-1.7(b)(1), and must be submitted by Bidders and proposed subcontractors only in connection with contracts and subcontracts which are subject to the equal opportunity clause. Contracts and subcontracts which are exempt from the equal opportunity clause are set forth in 41 CFR 60-1.5. (Generally only contracts or subcontracts of \$10,000 or under are exempt).

The undersigned, as Bidder, proposes and agrees, if the proposal is accepted, that he will execute a Contract with the Agency in the form set forth in the Contract Documents and that he will accept in full payment thereof the preceding prices as set forth in Bid Schedules.

Quantities above are for the purpose of comparison only and payments will be made on the basis of actual measurement of work completed. Measurements which vary from estimated quantities, shall require verification by City, and a written change order will be required prior to payment. For quantities indicated as lump sum, Contractor shall be paid at the Contract per lump sum price indicated, and shall include full compensation for all work and no additional compensation will be allowed thereof. Where discrepancies occur between words and figures, the words shall govern. Upon receipt of the Notice of Award, Contractor shall submit to the Agency for approval, a detailed breakdown of the Contractor's cost estimate into the various elements of materials and construction operations. When approved, this breakdown will serve as a basis for the Agency to determine partial payments.

If awarded this contract, the Bidder agrees to execute the Contract and submit the Labor and Materials Payment Bond, Contract Performance Bond, and Insurance Certificates on the required forms within ten (10) calendar days from the date of the Notice of Award. The Notice of Award shall be accompanied by the necessary Contract, Bond, and Insurance Certificate forms. In case of failure of the Bidder to execute the Contract, the Agency may at his option consider the Bidder in default, in which case the Bid Bond, or any deposit in lieu thereof, accompanying the proposal shall become the property of the Agency. Forfeiture of the Bid Bond, or any deposit in lieu thereof, does not preclude the Agency from seeking all other remedies provided by law to recover losses sustained as a result of the Contractor's failure to execute a written agreement to perform the work at his Bid Price.

The Bidder's execution on the signature portion of this proposal shall also constitute an endorsement and execution of those certifications which are a part of this Proposal.

EQUAL EMPLOYMENT OPPORTUNITY CERTIFICATION

The bidder _____, proposed subcontractor Brave Sign & Design, hereby certifies that he has X, has not _____, participated in a previous contract or subcontract subject to the equal opportunity clause, as required by Executive Orders 10925, 11114, or 11246, and that, where required, he has filed with the Joint Reporting Committee, the Director of the Office of Federal Contract Compliance, a Federal Government contracting or administering agency, or the former President's Committee on Equal Employment Opportunity, all reports due under the applicable filing requirements.

NOTE: The above certification is required by the Equal Employment Opportunity

Regulations of the Secretary of Labor (41CFR 60-1.7(b)(1), and must be submitted by Bidders and proposed subcontractors only in connection with contracts and subcontracts which are subject to the equal opportunity clause. Contracts and subcontracts which are exempt from the equal opportunity clause are set forth in 41 CFR 60-1.5. (Generally only contracts or subcontracts of \$10,000 or under are exempt).

The undersigned, as Bidder, proposes and agrees, if the proposal is accepted, that he will execute a Contract with the Agency in the form set forth in the Contract Documents and that he will accept in full payment thereof the preceding prices as set forth in Bid Schedules.

Quantities above are for the purpose of comparison only and payments will be made on the basis of actual measurement of work completed. Measurements which vary from estimated quantities, shall require verification by City, and a written change order will be required prior to payment. For quantities indicated as lump sum, Contractor shall be paid at the Contract per lump sum price indicated, and shall include full compensation for all work and no additional compensation will be allowed thereof. Where discrepancies occur between words and figures, the words shall govern. Upon receipt of the Notice of Award, Contractor shall submit to the Agency for approval, a detailed breakdown of the Contractor's cost estimate into the various elements of materials and construction operations. When approved, this breakdown will serve as a basis for the Agency to determine partial payments.

If awarded this contract, the Bidder agrees to execute the Contract and submit the Labor and Materials Payment Bond, Contract Performance Bond, and Insurance Certificates on the required forms within ten (10) calendar days from the date of the Notice of Award. The Notice of Award shall be accompanied by the necessary Contract, Bond, and Insurance Certificate forms. In case of failure of the Bidder to execute the Contract, the Agency may at his option consider the Bidder in default, in which case the Bid Bond, or any deposit in lieu thereof, accompanying the proposal shall become the property of the Agency. Forfeiture of the Bid Bond, or any deposit in lieu thereof, does not preclude the Agency from seeking all other remedies provided by law to recover losses sustained as a result of the Contractor's failure to execute a written agreement to perform the work at his Bid Price.

The Bidder's execution on the signature portion of this proposal shall also constitute an endorsement and execution of those certifications which are a part of this Proposal.

EQUAL EMPLOYMENT OPPORTUNITY CERTIFICATION

The bidder _____, proposed subcontractor Martinez Concrete, hereby certifies that he has , has not _____, participated in a previous contract or subcontract subject to the equal opportunity clause, as required by Executive Orders 10925, 11114, or 11246, and that, where required, he has filed with the Joint Reporting Committee, the Director of the Office of Federal Contract Compliance, a Federal Government contracting or administering agency, or the former President's Committee on Equal Employment Opportunity, all reports due under the applicable filing requirements.

NOTE: The above certification is required by the Equal Employment Opportunity

Regulations of the Secretary of Labor (41CFR 60-1.7(b)(1), and must be submitted by Bidders and proposed subcontractors only in connection with contracts and subcontracts which are subject to the equal opportunity clause. Contracts and subcontracts which are exempt from the equal opportunity clause are set forth in 41 CFR 60-1.5. (Generally only contracts or subcontracts of \$10,000 or under are exempt).

The undersigned, as Bidder, proposes and agrees, if the proposal is accepted, that he will execute a Contract with the Agency in the form set forth in the Contract Documents and that he will accept in full payment thereof the preceding prices as set forth in Bid Schedules.

Quantities above are for the purpose of comparison only and payments will be made on the basis of actual measurement of work completed. Measurements which vary from estimated quantities, shall require verification by City, and a written change order will be required prior to payment. For quantities indicated as lump sum, Contractor shall be paid at the Contract per lump sum price indicated, and shall include full compensation for all work and no additional compensation will be allowed thereof. Where discrepancies occur between words and figures, the words shall govern. Upon receipt of the Notice of Award, Contractor shall submit to the Agency for approval, a detailed breakdown of the Contractor's cost estimate into the various elements of materials and construction operations. When approved, this breakdown will serve as a basis for the Agency to determine partial payments.

If awarded this contract, the Bidder agrees to execute the Contract and submit the Labor and Materials Payment Bond, Contract Performance Bond, and Insurance Certificates on the required forms within ten (10) calendar days from the date of the Notice of Award. The Notice of Award shall be accompanied by the necessary Contract, Bond, and Insurance Certificate forms. In case of failure of the Bidder to execute the Contract, the Agency may at his option consider the Bidder in default, in which case the Bid Bond, or any deposit in lieu thereof, accompanying the proposal shall become the property of the Agency. Forfeiture of the Bid Bond, or any deposit in lieu thereof, does not preclude the Agency from seeking all other remedies provided by law to recover losses sustained as a result of the Contractor's failure to execute a written agreement to perform the work at his Bid Price.

The Bidder's execution on the signature portion of this proposal shall also constitute an endorsement and execution of those certifications which are a part of this Proposal.

EQUAL EMPLOYMENT OPPORTUNITY CERTIFICATION

The bidder _____, proposed subcontractor BC Traffic, hereby certifies that he has , has not _____, participated in a previous contract or subcontract subject to the equal opportunity clause, as required by Executive Orders 10925, 11114, or 11246, and that, where required, he has filed with the Joint Reporting Committee, the Director of the Office of Federal Contract Compliance, a Federal Government contracting or administering agency, or the former President's Committee on Equal Employment Opportunity, all reports due under the applicable filing requirements.

NOTE: The above certification is required by the Equal Employment Opportunity

Regulations of the Secretary of Labor (41CFR 60-1.7(b)(1), and must be submitted by Bidders and proposed subcontractors only in connection with contracts and subcontracts which are subject to the equal opportunity clause. Contracts and subcontracts which are exempt from the equal opportunity clause are set forth in 41 CFR 60-1.5. (Generally only contracts or subcontracts of \$10,000 or under are exempt).

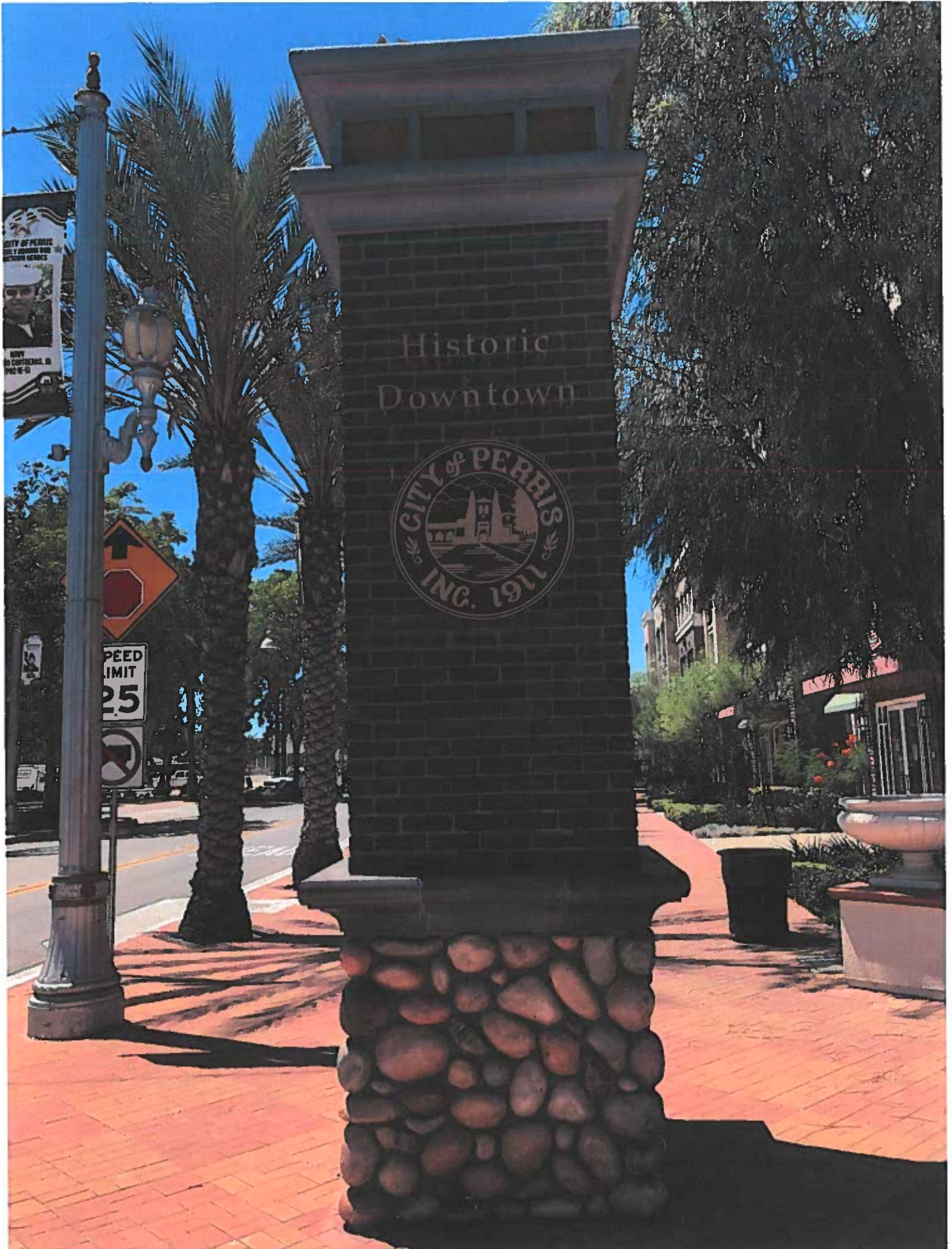

Historic
Downtown



SPEED
LIMIT
25

