

PROFILE SCALES  
HORIZ. 1"=40'  
VERT. 1"=4'

60+00 61+00 62+00 63+00 64+00  
SEE TRACT 3664B-1 STREET IMPROVEMENT PLANS FOR "C" STREET AND "K" STREET;  
SEE TRACT 3664B STREET IMPROVEMENT PLANS FOR "L" STREET.

**TRACT 3664B EVANS ROAD**

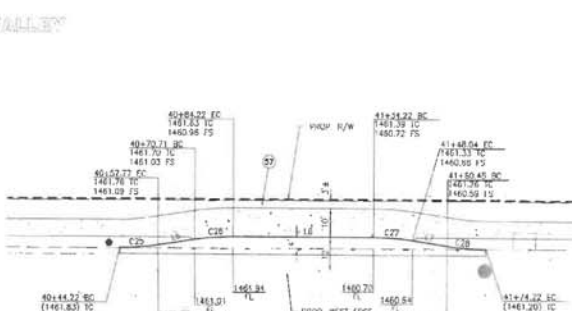
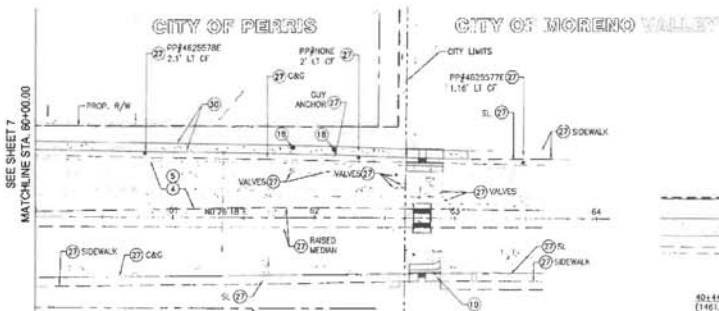

- CONSTRUCTION NOTES:**
- ① COULD PLACE EXISTING PAVEMENT (0.21" MIN.) FOR OVERLAY DETAIL ON SHEET 2
  - ② INSTALL 0.21" A.C. OVERLAY DETAIL ON SHEET 3
  - ③ REMOVE/RELOCATE EXISTING SIGN PER SIGNING & STEERING PLANS.
  - ④ RELOCATE EXISTING AIR VALE AT DIRECTION OF FIRM.
  - ⑤ PROTECT IN PLACE (ITEM NOTED ON PLAN).
  - ⑥ CONSTRUCT 4" THICK - 6" WIDE SIDEWALK PER RIVERSIDE CO. STD. NO. 401.
  - ⑦ CONSTRUCT BUS TURNOUT; LAYOUT PER IFA DESIGN PARAMETERS FOR LARGE BUS TURNOUT ADJACENT TO A BIKE LANE AND NATIONALS PER RIVERSIDE CO. STD. NO. 81A
  - ⑧ CONSTRUCT BUS SHELTER PER CITY OF PERRIS APPROVED SPECIFICATIONS BY AN CUSTOM MANUFACTURING OR APPROVED EQUAL.



**LEGEND**



| LINE TABLE |        |             | CURVE TABLE |        |        |          |
|------------|--------|-------------|-------------|--------|--------|----------|
| LINE #     | LENGTH | DIRECTION   | CURVE #     | LENGTH | RADIUS | DELTA    |
| L5         | 13.09  | N09°11'44"W | C25         | 13.09  | 90.00  | 8°39'31" |
| L6         | 50.00  | N02°28'18"E | C26         | 13.56  | 90.00  | 8°38'02" |
| L7         | 12.56  | N09°16'01"E | C27         | 13.87  | 90.00  | 8°40'44" |
|            |        |             | C28         | 13.83  | 90.00  | 8°48'15" |

| CURVE # | LENGTH | RADIUS | DELTA    | TANGENT |
|---------|--------|--------|----------|---------|
| C25     | 13.09  | 90.00  | 8°39'31" | 6.81    |
| C26     | 13.56  | 90.00  | 8°38'02" | 6.79    |
| C27     | 13.87  | 90.00  | 8°40'44" | 6.95    |
| C28     | 13.83  | 90.00  | 8°48'15" | 6.93    |

① BUS TURNOUT DETAIL  
NOT TO SCALE



**NOTE:**  
WORK CONTAINED WITHIN THESE PLANS SHALL NOT COMMENCE UNTIL AN ENVIRONMENTAL PERMIT AND/OR A GRADING PERMIT HAS BEEN ISSUED.  
THE FIRM'S ENGINEER SIGNING THESE PLANS IS RESPONSIBLE FOR ASSURING THE ACCURACY AND ACCEPTABILITY OF THE DESIGN HEREON IN THE EVENT OF DISCREPANCIES ARISING AFTER OBTAINING OR DURING CONSTRUCTION. THE FIRM'S LIABILITY SHALL BE DETERMINED BY REVIEWING AN ACCEPTABLE SAMPLE AND VERIFYING THE PLANS FOR APPROVAL BY THE CITY.

| MARK | DATE | REVISIONS | APPROVAL | CITY |
|------|------|-----------|----------|------|
|      |      |           |          |      |

CITY OF PERRIS  
APPROVED BY: \_\_\_\_\_  
CITY ENGINEER  
DATE: \_\_\_\_\_

SEAL - ENGINEER  
ALBERT A. WEBB  
REGISTERED PROFESSIONAL ENGINEER  
NO. 050078  
STATE OF CALIFORNIA

CITY OF MORENO VALLEY  
CITY ENGINEER: \_\_\_\_\_ DATE: \_\_\_\_\_  
BENCHMARK: SEE SHEET 1  
PREPARED UNDER THE SUPERVISION OF: *Debrah R. Smith*  
DESIGNED BY: *glr*  
CHECKED BY: *glr*  
DATE: \_\_\_\_\_

SCALE: H: 1"=40' V: 1"=40'  
FOR: 2017-0264  
W.O. 2017-0264  
CITY FILE NO. PB-1297

W/DID#:  
MORNO VALLEY OF LC 018-0026  
CITY OF PERRIS  
TRACT NO. 3664B & 3664B-1  
OFF-SITE STREET IMPROVEMENT PLAN  
EVANS ROAD STA 60+00 TO 63+00  
SHEET NO. 8  
OF 15 SHEETS

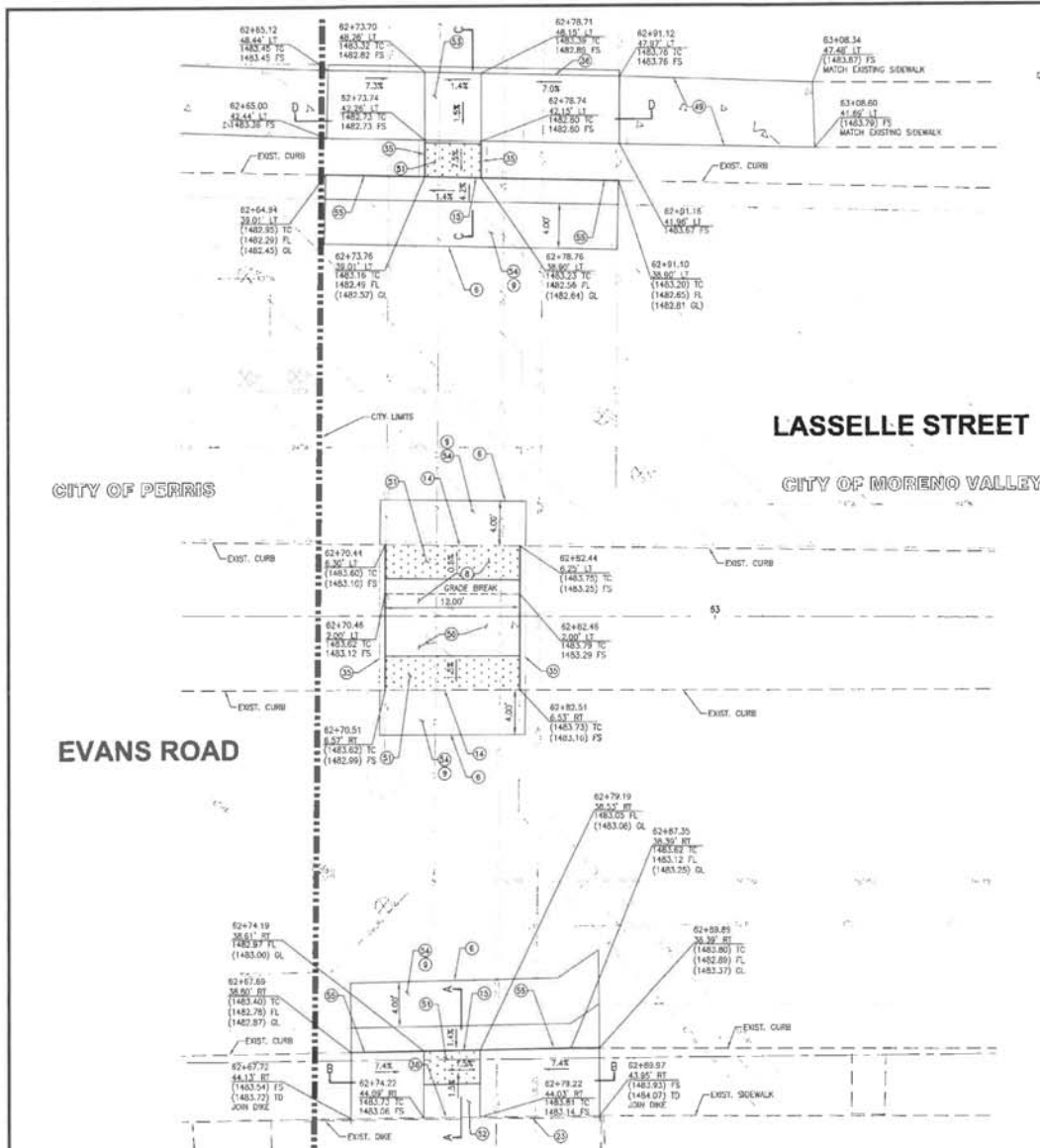

- CONSTRUCTION NOTES:**
- 1) MATCH EXISTING PAVEMENT PER OVERLAY DETAIL ON SHEET 2.
  - 2) CONSTRUCT PEDESTRIAN ACCESS PER DETAIL ON SHEET 9.
  - 3) REMOVE EXISTING PAVEMENT SECTION.
  - 4) REMOVE EXISTING MEDIAN CURB
  - 5) REMOVE EXISTING CURB & DUTTER
  - 6) REMOVE EXISTING A.C. DRK.
  - 7) CONSTRUCT 6" PCC CURB PER PCC CURB DETAIL ON SHEET 9.
  - 8) CONSTRUCT RETAINING CURB PER RETAINING CURB DETAIL ON SHEET 9.
  - 9) CONSTRUCT SIDEWALK PER CITY OF MORENO VALLEY STD. PLAN MVS-115B-0.
  - 10) CONSTRUCT PEDESTRIAN CROSSING PER CALTRANS STANDARD PLAN RSP AB84, TYPE A.
  - 11) INSTALL DETECTABLE WARNING SURFACE PER CITY OF MORENO VALLEY STD. PLAN MVS-1140-1.
  - 12) CONSTRUCT ACCESS RAMP - TYPE 2 PER CITY OF MORENO VALLEY STD. PLAN MVS-1140-1.
  - 13) CONSTRUCT CURB RAMP PER CALTRANS STANDARD PLAN RSP AB84, CASE F.
  - 14) SLOT PATCH FULL DEPTH PAVEMENT (RAMP).
  - 15) CONSTRUCT 8" INTEGRAL CURB AND GUTTER PER MVS-120B-0.



**LASSELIE STREET**

CITY OF PERRIS

CITY OF MORENO VALLEY

**EVANS ROAD**

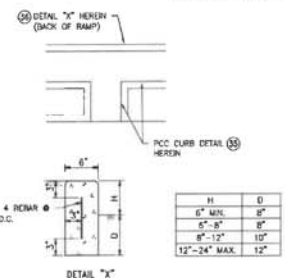

**RETAINING CURB DETAIL**  
NOT TO SCALE

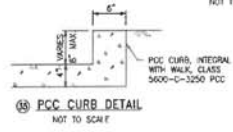

**PCC CURB DETAIL**  
NOT TO SCALE



**PEDESTRIAN PASS THROUGH SECTION**  
NOT TO SCALE



**SECTION A-A**  
NOT TO SCALE



**SECTION C-C**  
NOT TO SCALE

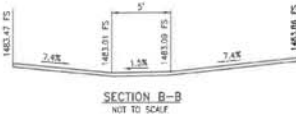

**SECTION B-B**  
NOT TO SCALE

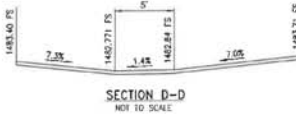

**SECTION D-D**  
NOT TO SCALE



**NOTE:**  
WORK CONTAINED WITHIN THESE PLANS SHALL NOT COMMENCE UNTIL AN ENCROACHMENT PERMIT AND/OR A GRADING PERMIT HAS BEEN ISSUED.  
THE PRIVATE ENGINEER SIGNING THESE PLANS IS RESPONSIBLE FOR ASSURING THE ACCURACY AND ACCEPTABILITY OF THE DESIGN HEREON IN THE EVENT OF DISCREPANCIES ARISING AFTER CITY APPROVAL, OR DURING CONSTRUCTION. THE PUBLIC ENGINEER SHALL BE RESPONSIBLE FOR DETERMINING AN ACCEPTABLE SECTION AND REVISIONS TO THE PLANS FOR APPROVAL BY THE CITY.

| MARK | BY | DATE | REVISIONS |
|------|----|------|-----------|
|      |    |      |           |
|      |    |      |           |

CITY OF PERRIS  
APPROVED BY: \_\_\_\_\_  
CITY ENGINEER  
DATE: \_\_\_\_\_

SEAL - ENGINEER  
ALBERT A. WEBB  
REGISTERED PROFESSIONAL ENGINEER  
No. 058078  
City of Perris, CA

CITY OF MORENO VALLEY  
CITY ENGINEER: \_\_\_\_\_ DATE: \_\_\_\_\_  
BENCHMARK: SEE SHEET 1  
ENGINEERING CONSULTANTS  
3708 HASKINS STREET  
PERRIS, CA 92508  
PH: (951) 886-1070  
FAX: (951) 798-1256

DESIGNED BY: TB  
CHECKED BY: ABK  
DATE: \_\_\_\_\_  
SCALE: HORIZ. 1"=40' VERT. 1"=40'

WDID#: \_\_\_\_\_  
CITY OF PERRIS  
TRACT NO. 36648 & 36648-1  
OFF-SITE STREET IMPROVEMENT PLAN  
PEDESTRIAN CROSSING  
SHEET NO. 9  
OF 15 SHEETS  
FOR: \_\_\_\_\_ W.O. 2017-0264 CITY FILE NO. PB-1297

