

**DISCLAIMER**

THE CITY OF MORNING VALLEY APPROVALS

**APPROVALS:**

- City Engineer: [Signature]
- City Manager: [Signature]
- City Council: [Signature]

**CONTRACT INFORMATION:**

Contract No. 04/20  
 Project Name: MULTILANE TRAIL IMPROVEMENT PLAN  
 Location: JUAN BAUTISTA DE ANCHA MULTILANE TRAIL  
 State Park Connection

**DATE:** 02/23/20

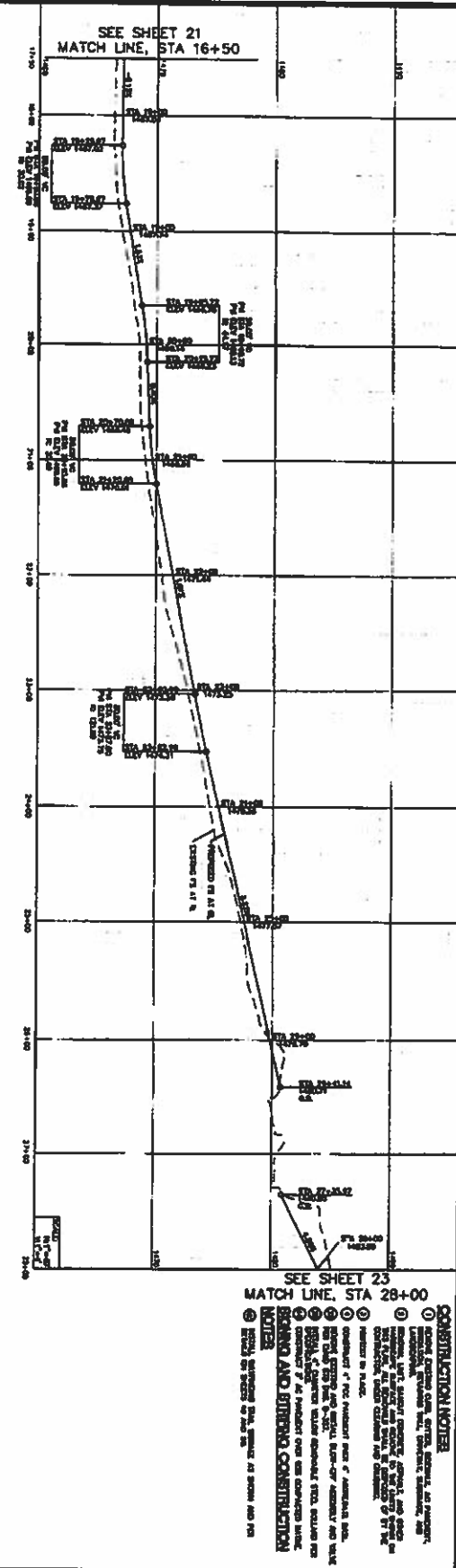
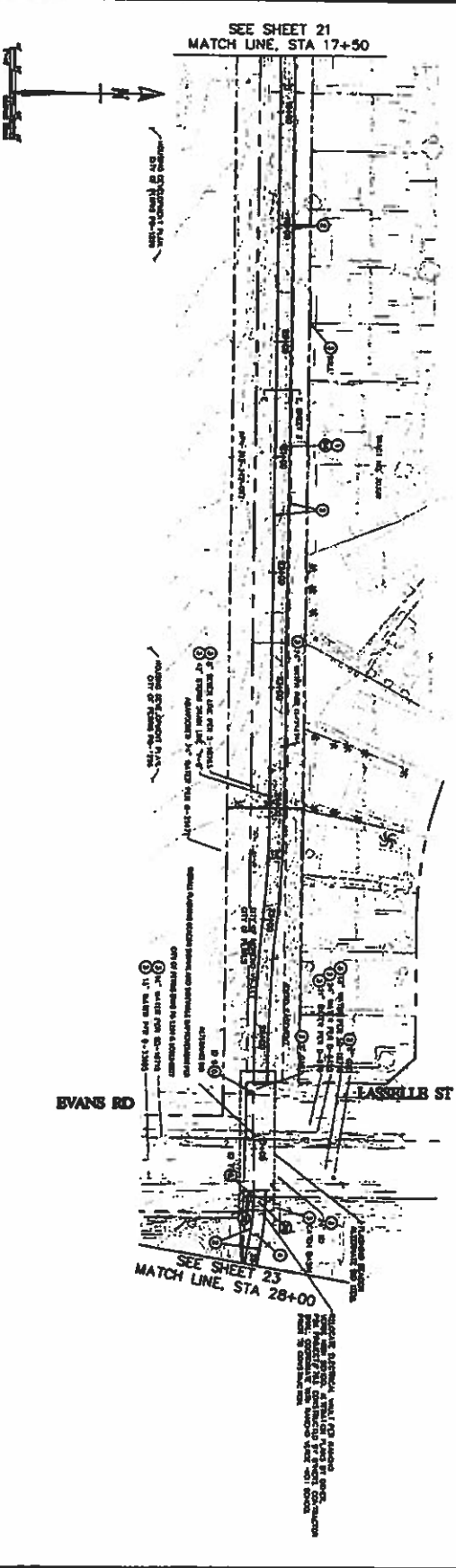

- CONSTRUCTION NOTES**
- REMOVE EXISTING CURB, GUTTER, AND ASPHALT SURFACE TO EXISTING TRAIL ALIGNMENT.
  - REMOVE EXISTING 24" DIAMETER CONCRETE UTILITY PIPES AND RENEW WITH 24" DIAMETER CONCRETE UTILITY PIPES WITH 18" SAND FILL.
  - REMOVE EXISTING 18" DIAMETER CONCRETE UTILITY PIPES AND RENEW WITH 18" DIAMETER CONCRETE UTILITY PIPES WITH 12" SAND FILL.
  - REMOVE EXISTING 12" DIAMETER CONCRETE UTILITY PIPES AND RENEW WITH 12" DIAMETER CONCRETE UTILITY PIPES WITH 6" SAND FILL.
  - REMOVE EXISTING 6" DIAMETER CONCRETE UTILITY PIPES AND RENEW WITH 6" DIAMETER CONCRETE UTILITY PIPES WITH 3" SAND FILL.
  - REMOVE EXISTING 4" DIAMETER CONCRETE UTILITY PIPES AND RENEW WITH 4" DIAMETER CONCRETE UTILITY PIPES WITH 2" SAND FILL.
  - REMOVE EXISTING 3" DIAMETER CONCRETE UTILITY PIPES AND RENEW WITH 3" DIAMETER CONCRETE UTILITY PIPES WITH 1" SAND FILL.
  - REMOVE EXISTING 2" DIAMETER CONCRETE UTILITY PIPES AND RENEW WITH 2" DIAMETER CONCRETE UTILITY PIPES WITH 0.5" SAND FILL.
  - REMOVE EXISTING 1.5" DIAMETER CONCRETE UTILITY PIPES AND RENEW WITH 1.5" DIAMETER CONCRETE UTILITY PIPES WITH 0.25" SAND FILL.
  - REMOVE EXISTING 1" DIAMETER CONCRETE UTILITY PIPES AND RENEW WITH 1" DIAMETER CONCRETE UTILITY PIPES WITH 0.125" SAND FILL.
- NOTES**
1. REMOVE EXISTING 24" DIAMETER CONCRETE UTILITY PIPES AND RENEW WITH 24" DIAMETER CONCRETE UTILITY PIPES WITH 18" SAND FILL.
2. REMOVE EXISTING 18" DIAMETER CONCRETE UTILITY PIPES AND RENEW WITH 18" DIAMETER CONCRETE UTILITY PIPES WITH 12" SAND FILL.
3. REMOVE EXISTING 12" DIAMETER CONCRETE UTILITY PIPES AND RENEW WITH 12" DIAMETER CONCRETE UTILITY PIPES WITH 6" SAND FILL.
4. REMOVE EXISTING 6" DIAMETER CONCRETE UTILITY PIPES AND RENEW WITH 6" DIAMETER CONCRETE UTILITY PIPES WITH 3" SAND FILL.
5. REMOVE EXISTING 4" DIAMETER CONCRETE UTILITY PIPES AND RENEW WITH 4" DIAMETER CONCRETE UTILITY PIPES WITH 2" SAND FILL.
6. REMOVE EXISTING 3" DIAMETER CONCRETE UTILITY PIPES AND RENEW WITH 3" DIAMETER CONCRETE UTILITY PIPES WITH 1" SAND FILL.
7. REMOVE EXISTING 2" DIAMETER CONCRETE UTILITY PIPES AND RENEW WITH 2" DIAMETER CONCRETE UTILITY PIPES WITH 0.5" SAND FILL.
8. REMOVE EXISTING 1.5" DIAMETER CONCRETE UTILITY PIPES AND RENEW WITH 1.5" DIAMETER CONCRETE UTILITY PIPES WITH 0.25" SAND FILL.
9. REMOVE EXISTING 1" DIAMETER CONCRETE UTILITY PIPES AND RENEW WITH 1" DIAMETER CONCRETE UTILITY PIPES WITH 0.125" SAND FILL.