

DATE: November 9, 2022
TO: Lars Andersen, Pacific Development Partners, LLC
FROM: Haseeb Qureshi
Alyssa Barnett
JOB NO: 13234-06 AQ Memo

PERRIS AND RAMONA WAREHOUSE (DPR19-00012) AIR QUALITY, GREENHOUSE GAS, HEALTH RISK, & ENERGY ASSESSMENT

Lars Andersen,

Urban Crossroads, Inc. is pleased to provide the following Air Quality, Greenhouse Gas, Health Risk, & Energy Assessment for the Perris and Ramona warehouse (dpr19-00012) (**Project**), which is located south of Ramona Expressway between Indian Avenue and Perris Boulevard within the Perris Valley Commerce Center Specific Plan in the City of Perris. The following supplemental Air Quality, Greenhouse Gas, Health Risk, & Energy Assessment has been prepared in support of the proposed Alternative 2 site plan which includes a retail component and reduced warehouse building.

PROJECT DESCRIPTION

Alternative 2 will evaluate a single 304,572 square foot warehouse building plus a 2,010 square foot fast-food restaurant with drive-through window and 4,950 square feet of retail space. Exhibit 1 shows the proposed Alternative 2 site plan.

SUMMARY OF FINDINGS

Results of the assessment indicate that Alternative 2 would not result in a significant impact during construction or operational activities associated with air quality, greenhouse gas, energy, and health risk impacts.

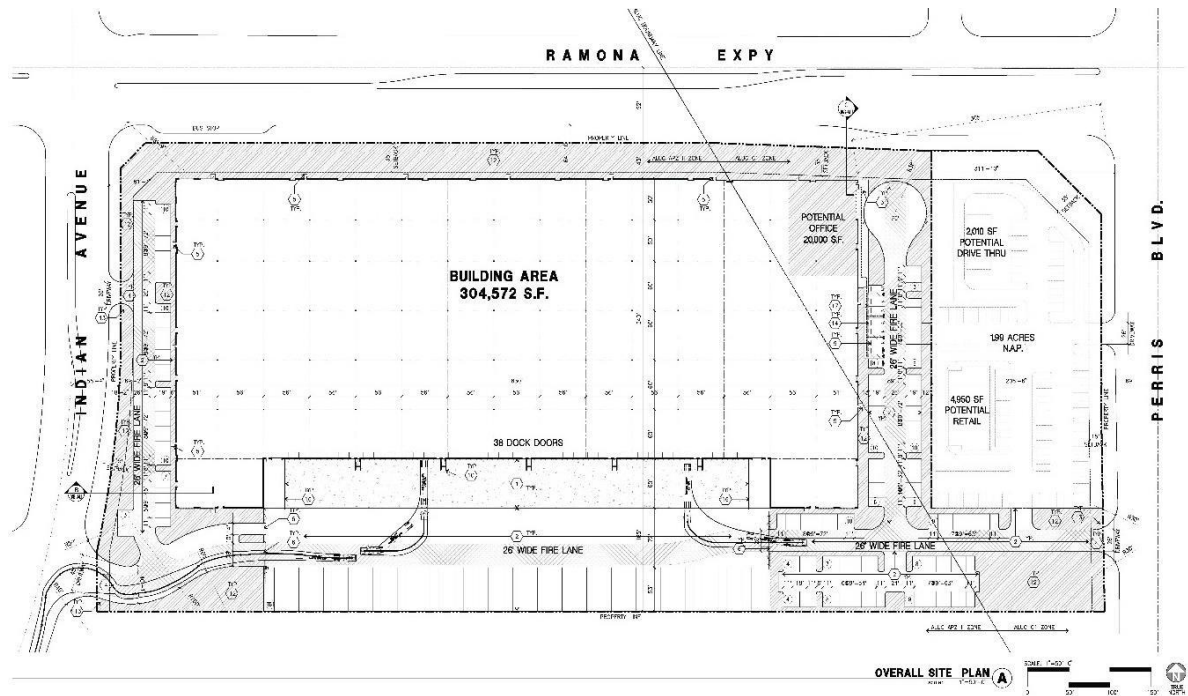
EXHIBIT 1: PRELIMINARY SITE PLAN**PROJECT AIR QUALITY IMPACTS****REGIONAL AND LOCALIZED CONSTRUCTION EMISSIONS**

Construction of Alternative 2 would not result in daily construction emissions that would be substantially different than the emissions identified in the *Perris and Ramona Warehouse (DPR19-00012) Air Quality Analysis* (Urban Crossroads, Inc. 2021). As such, the Project construction will not exceed thresholds established by the SCAQMD for emissions of any criteria pollutant and no mitigation is required.

REGIONAL OPERATIONAL EMISSIONS

Operational activities associated with Alternative 2 would result in emissions of CO, VOCs, NO_x, SO_x, PM₁₀, and PM_{2.5}. Operational related emissions are expected from the following primary sources: area source emissions, energy source emissions, and mobile source emissions.

The estimated operation-source emissions from the Project are summarized on Table 1. Detailed operation model outputs are presented in Attachment A. As shown on Table 1, operational-source emissions would not exceed the applicable SCAQMD regional thresholds for emissions of any criteria pollutant and no mitigation is required.

TABLE 1: TOTAL ALTERNATIVE 2 REGIONAL OPERATIONAL EMISSIONS

Source	Emissions (lbs/day)					
	VOC	NO _x	CO	SO _x	PM ₁₀	PM _{2.5}
Summer						
Mobile Source	3.22	5.56	27.03	0.07	5.96	1.64
Area Source	7.09	9.70e-04	0.11	1.00e-05	0.02	0.02
Energy Source	0.03	0.31	0.26	1.88e-03	0.02	0.02
Offroad Source	0.22	2.07	1.50	6.33e-03	0.08	0.07
Total Maximum Daily Emissions	10.56	7.95	28.90	0.08	6.06	1.73
SCAQMD Regional Threshold	55	55	550	150	150	55
Threshold Exceeded?	NO	NO	NO	NO	NO	NO
Winter						
Mobile Source	3.22	5.56	27.03	0.07	5.96	1.64
Area Source	7.09	9.70e-04	0.11	1.00e-05	0.02	0.02
Energy Source	2.69	5.90	24.39	0.06	5.96	1.64
Offroad Source	0.22	2.07	1.50	6.33e-03	0.08	0.07
Total Maximum Daily Emissions	10.03	8.28	26.25	0.07	6.06	1.73
SCAQMD Regional Threshold	55	55	550	150	150	55
Threshold Exceeded?	NO	NO	NO	NO	NO	NO

PROJECT GHG ANALYSIS

PROJECT GHG EMISSIONS

The estimated GHG emissions for the Project are summarized on Table 2. The estimated GHG emission include emissions from Carbon Dioxide (CO₂), Methane (CH₄), and Nitrous Oxide (N₂O). As shown on Table 2, the Project would generate a total of approximately 1,729.97 MTCO₂e/yr. As shown below, GHG emissions associated with Alternative 2 would be less than the applicable threshold.

TABLE 2: TOTAL ALTERNATIVE 2 PROJECT GHG EMISSIONS

Source	Emission (lbs/day)			
	CO ₂	CH ₄	N ₂ O	Total CO ₂ E
Annual construction-related emissions amortized over 30 years	38.34	6.73E-03	1.02E-03	38.81
Mobile Source	922.06	0.05	0.06	942.48
Area Source	0.03	7.00e-05	0.00	0.03
Energy Source	218.32	0.01	2.74e-03	219.50
Water	193.13	2.34	0.06	268.55
Waste	63.89	3.78	0.00	158.28
Offroad	101.50	0.03	0.00	102.32
Total CO ₂ E (All Sources)			1,729.97	

PROJECT ENERGY ANALYSIS

CONSTRUCTION ENERGY DEMANDS

Construction associated with Alternative 2 would not result in energy demands that would be substantially different than the emissions identified in the *Perris and Ramona Warehouse (DPR19-00012) Air Quality Analysis* (Urban Crossroads, Inc. 2021).

OPERATIONAL ENERGY DEMANDS

The Project proposes conventional industrial and commercial reflecting contemporary energy efficient/energy conserving designs and operational programs. The Project does not propose uses that are inherently energy intensive and the energy demands in total would be comparable to other residential land use projects of similar scale and configuration.

The Project will comply with the applicable Title 24 standards which will ensure that the Project energy demands would not be inefficient, wasteful, or otherwise unnecessary.

The Project would not cause or result in the need for additional energy producing or transmission facilities. The Project would not engage in wasteful or inefficient uses of energy and aims to achieve energy conservation goals within the State of California. As supported by the preceding analyses, Project operations would not result in the inefficient, wasteful, or unnecessary consumption of energy.

TABLE 3: PROJECT-GENERATED VEHICLE TRAFFIC ANNUAL FUEL CONSUMPTION

Vehicle Type	Average Vehicle Fuel Economy (mpg)	Annual VMT	Estimated Annual Fuel Consumption (gallons)
LDA	33.79	1,176,114	34,811
LDT1	28.38	110,155	3,881
LDT2	27.02	420,808	15,573
MDV	21.45	315,987	14,728
LHDT1	14.58	56,559	3,879
LHDT2	15.26	15,745	1,032
MHDT	10.74	51,326	4,780
HHDT	7.44	136,075	18,300
OBUS	6.63	721	109
UBUS	4.97	368	74
MCY	37.90	50,353	1,329
SBUS	8.06	1,287	160
MH	6.17	6,397	1,037
TOTAL (ALL VEHICLES)		2,341,895	99,693

As shown on Table 4, the Project operational energy demands are estimated to result in a 1,168,400 kBTU/year of natural gas; and 879,493 kWh/year of electricity. Natural gas would be supplied to the Project by Southern California Gas; electricity would be supplied by Southern California Edison.

TABLE 4: PROJECT ANNUAL OPERATIONAL ENERGY DEMAND SUMMARY

Land Use	Natural Gas Demand (kBTU/year)	Electricity Demand (kWh/year)
High-Cube Transload/Short-term Storage Warehouse	612,190	706,607
Strip Retail	10,890	60,093
Fast-Food Restaurant with Drive-Through Window	545,320	92,320
Parking	0	20,473
Landscape	0	0
Other Asphalt Surfaces	0	0
TOTAL PROJECT ENERGY DEMAND	1,168,400	879,493

PROJECT HEALTH RISK ASSESSMENT

The potential health risk impacts associated with Alternative 2 would not exceed the health risk values previously disclosed in the *Perris and Ramona Warehouse (DPR19-00012) Mobile Source Health Risk Assessment* (Urban Crossroads, Inc. 2021) due to the fact that Alternative 2 includes a

reduction of approximately 43,346 square feet of warehouse space and removal of the gasoline dispensing facility, which consequently would also result in fewer diesel truck trips associated with Alternative 2 and toxic air contaminants (TACs) associated with gasoline dispensing.

AIR QUALITY, GREENHOUSE GAS, ENERGY, AND HRA CONCLUSION

Results of the assessment indicate that Alternative 2 would not result in a significant impact during construction or operational activities associated with air quality, greenhouse gas, energy, and health risk impacts.

ATTACHMENT A
CALEEMOD PROJECT ALTERNATIVE 2 EMISSIONS MODEL
OUTPUTS

Perris & Ramona Warehouse (Operations) - Riverside-South Coast County, Summer

EMFAC Off-Model Adjustment Factors for Gasoline Light Duty Vehicle to Account for the SAFE Vehicle Rule Applied

Perris & Ramona Warehouse (Operations)

Riverside-South Coast County, Summer

1.0 Project Characteristics

1.1 Land Usage

Land Uses	Size	Metric	Lot Acreage	Floor Surface Area	Population
Unrefrigerated Warehouse-No Rail	304.57	1000sqft	6.99	304,572.00	0
User Defined Industrial	304.57	User Defined Unit	0.00	0.00	0
Other Asphalt Surfaces	211.79	1000sqft	4.86	211,794.00	0
Parking Lot	214.00	Space	1.34	58,493.00	0
City Park	2.16	Acre	2.16	94,036.00	0
Fast Food Restaurant with Drive Thru	2.00	1000sqft	0.05	2,000.00	0
Strip Mall	4.95	1000sqft	0.11	4,950.00	0

1.2 Other Project Characteristics

Urbanization	Urban	Wind Speed (m/s)	2.4	Precipitation Freq (Days)	28
Climate Zone	10			Operational Year	2023

Utility Company Southern California Edison

CO2 Intensity (lb/MW hr)	390.98	CH4 Intensity (lb/MW hr)	0.033	N2O Intensity (lb/MW hr)	0.004
---------------------------------	--------	---------------------------------	-------	---------------------------------	-------

1.3 User Entered Comments & Non-Default Data

Project Characteristics -

Land Use - Total Project area is +/- 15.5 acres

Construction Phase - Operations run only

Off-road Equipment - Operations run only

Operational Off-Road Equipment - Based on SCAQMD High-Cube Warehouse Truck Trip Study White Paper Summary of Business Survey Results (2014)
Pems & Ramona Warehouse (Operations) - Riverside-South Coast County, Summer

EMFAC Off-Model Adjustment Factors for Gasoline Light Duty Vehicle to Account for the SAFE Vehicle Rule Applied

Perris & Ramona Warehouse (Operations) - Riverside-South Coast County, Summer

EMFAC Off-Model Adjustment Factors for Gasoline Light Duty Vehicle to Account for the SAFE Vehicle Rule Applied

Fleet Mix - Passenger Car Mix estimated based on the CalEEMod default fleet mix and the ratio of the vehicle classes (LDA, LDT1, LDT2, MDV, & MCY). Truck Mix based on information in the Traffic analysis

Table Name	Column Name	Default Value	New Value
tblConstructionPhase	NumDays	20.00	0.00
tblFleetMix	HHD	0.02	0.00
tblFleetMix	HHD	0.02	0.62
tblFleetMix	LDA	0.53	0.56
tblFleetMix	LDA	0.53	0.00
tblFleetMix	LDT1	0.06	0.05
tblFleetMix	LDT1	0.06	0.00
tblFleetMix	LDT2	0.17	0.22
tblFleetMix	LDT2	0.17	0.00
tblFleetMix	LHD1	0.03	0.00
tblFleetMix	LHD1	0.03	0.14
tblFleetMix	LHD2	7.3100e-003	0.00
tblFleetMix	LHD2	7.3100e-003	0.04
tblFleetMix	MCY	0.02	0.02
tblFleetMix	MCY	0.02	0.00
tblFleetMix	MDV	0.14	0.15
tblFleetMix	MDV	0.14	0.00
tblFleetMix	MH	5.4680e-003	0.00
tblFleetMix	MH	5.4680e-003	0.00
tblFleetMix	MHD	0.01	0.00
tblFleetMix	MHD	0.01	0.21
tblFleetMix	OBUS	6.1600e-004	0.00
tblFleetMix	OBUS	6.1600e-004	0.00
tblFleetMix	SBUS	1.1000e-003	0.00
tblFleetMix	SBUS	1.1000e-003	0.00
tblFleetMix	UBUS	3.1500e-004	0.00

Perris & Ramona Warehouse (Operations) - Riverside-South Coast County, Summer

EMFAC Off-Model Adjustment Factors for Gasoline Light Duty Vehicle to Account for the SAFE Vehicle Rule Applied

tblFleetMix	UBUS	3.1500e-004	0.00
tblLandUse	LandUseSquareFeet	85,600.00	58,493.00
tblLandUse	LandUseSquareFeet	94,089.60	94,036.00
tblLandUse	LotAcreage	1.93	1.34
tblOffRoadEquipment	OffRoadEquipmentUnitAmount	1.00	0.00
tblOffRoadEquipment	OffRoadEquipmentUnitAmount	3.00	0.00
tblOffRoadEquipment	OffRoadEquipmentUnitAmount	2.00	0.00
tblOperationalOffRoadEquipment	OperDaysPerYear	260.00	365.00
tblOperationalOffRoadEquipment	OperFuelType	Diesel	CNG
tblOperationalOffRoadEquipment	OperHorsePower	97.00	200.00
tblOperationalOffRoadEquipment	OperHoursPerDay	8.00	4.00
tblOperationalOffRoadEquipment	OperOffRoadEquipmentNumber	0.00	2.00
tblVehicleTrips	CC_TTP	48.00	0.00
tblVehicleTrips	CC_TTP	0.00	100.00
tblVehicleTrips	CC_TTP	0.00	100.00
tblVehicleTrips	CNW_TTP	19.00	0.00
tblVehicleTrips	CNW_TTP	41.00	0.00
tblVehicleTrips	CW_TL	16.60	40.00
tblVehicleTrips	CW_TTP	33.00	0.00
tblVehicleTrips	CW_TTP	59.00	0.00
tblVehicleTrips	DV_TP	28.00	0.00
tblVehicleTrips	DV_TP	21.00	0.00
tblVehicleTrips	DV_TP	40.00	0.00
tblVehicleTrips	DV_TP	5.00	0.00
tblVehicleTrips	PB_TP	6.00	0.00
tblVehicleTrips	PB_TP	3.00	0.00
tblVehicleTrips	PR_TP	66.00	0.00
tblVehicleTrips	PR_TP	29.00	50.00
tblVehicleTrips	PR_TP	45.00	85.00

Perris & Ramona Warehouse (Operations) - Riverside-South Coast County, Summer

EMFAC Off-Model Adjustment Factors for Gasoline Light Duty Vehicle to Account for the SAFE Vehicle Rule Applied

tblVehicleTrips	PR_TP	92.00	100.00
tblVehicleTrips	PR_TP	0.00	100.00
tblVehicleTrips	ST_TR	1.96	0.00
tblVehicleTrips	ST_TR	616.12	276.60
tblVehicleTrips	ST_TR	42.04	43.12
tblVehicleTrips	ST_TR	1.74	0.79
tblVehicleTrips	ST_TR	0.00	0.15
tblVehicleTrips	SU_TR	2.19	0.00
tblVehicleTrips	SU_TR	472.58	212.16
tblVehicleTrips	SU_TR	20.43	33.07
tblVehicleTrips	SU_TR	1.74	0.73
tblVehicleTrips	SU_TR	0.00	0.14
tblVehicleTrips	WD_TR	0.78	0.00
tblVehicleTrips	WD_TR	470.95	209.95
tblVehicleTrips	WD_TR	44.32	32.73
tblVehicleTrips	WD_TR	1.74	1.18
tblVehicleTrips	WD_TR	0.00	0.22

2.0 Emissions Summary

Perris & Ramona Warehouse (Operations) - Riverside-South Coast County, Summer

EMFAC Off-Model Adjustment Factors for Gasoline Light Duty Vehicle to Account for the SAFE Vehicle Rule Applied

2.2 Overall Operational

Unmitigated Operational

	ROG	NOx	CO	SO2	Fugitive PM10	Exhaust PM10	PM10 Total	Fugitive PM2.5	Exhaust PM2.5	PM2.5 Total	Bio- CO2	NBio- CO2	Total CO2	CH4	N2O	CO2e
Category	lb/day										lb/day					
Area	7.0904	9.7000e-004	0.1066	1.0000e-005		3.8000e-004	3.8000e-004		3.8000e-004	3.8000e-004		0.2285	0.2285	6.0000e-004		0.2435
Energy	0.0345	0.3138	0.2636	1.8800e-003		0.0239	0.0239		0.0239	0.0239		376.5994	376.5994	7.2200e-003	6.9000e-003	378.8374
Mobile	3.2185	5.5581	27.0298	0.0668	5.9023	0.0619	5.9642	1.5775	0.0583	1.6358		6,902.018 1	6,902.018 1	0.3187	0.4478	7,043.414 5
Offroad	0.2207	2.0721	1.4984	6.3300e-003		0.0752	0.0752		0.0692	0.0692	0.0000	613.0902	613.0902	0.1983		618.0473
Total	10.5640	7.9450	28.8985	0.0750	5.9023	0.1613	6.0636	1.5775	0.1517	1.7292	0.0000	7,891.936 2	7,891.936 2	0.5248	0.4547	8,040.542 7

Perris & Ramona Warehouse (Operations) - Riverside-South Coast County, Summer

EMFAC Off-Model Adjustment Factors for Gasoline Light Duty Vehicle to Account for the SAFE Vehicle Rule Applied

2.2 Overall Operational

Mitigated Operational

	ROG	NOx	CO	SO2	Fugitive PM10	Exhaust PM10	PM10 Total	Fugitive PM2.5	Exhaust PM2.5	PM2.5 Total	Bio- CO2	NBio- CO2	Total CO2	CH4	N2O	CO2e
Category	lb/day										lb/day					
Area	7.0904	9.7000e-004	0.1066	1.0000e-005		3.8000e-004	3.8000e-004		3.8000e-004	3.8000e-004		0.2285	0.2285	6.0000e-004		0.2435
Energy	0.0345	0.3138	0.2636	1.8800e-003		0.0239	0.0239		0.0239	0.0239		376.5994	376.5994	7.2200e-003	6.9000e-003	378.8374
Mobile	3.2185	5.5581	27.0298	0.0668	5.9023	0.0619	5.9642	1.5775	0.0583	1.6358		6,902.018 1	6,902.018 1	0.3187	0.4478	7,043.414 5
Offroad	0.2207	2.0721	1.4984	6.3300e-003		0.0752	0.0752		0.0692	0.0692	0.0000	613.0902	613.0902	0.1983		618.0473
Total	10.5640	7.9450	28.8985	0.0750	5.9023	0.1613	6.0636	1.5775	0.1517	1.7292	0.0000	7,891.936 2	7,891.936 2	0.5248	0.4547	8,040.542 7

	ROG	NOx	CO	SO2	Fugitive PM10	Exhaust PM10	PM10 Total	Fugitive PM2.5	Exhaust PM2.5	PM2.5 Total	Bio- CO2	NBio-CO2	Total CO2	CH4	N2O	CO2e
Percent Reduction	0.00	0.00	0.00	0.00	0.00	0.00	0.00	0.00	0.00	0.00	0.00	0.00	0.00	0.00	0.00	0.00

3.0 Construction Detail

Construction Phase

Phase Number	Phase Name	Phase Type	Start Date	End Date	Num Days Week	Num Days	Phase Description
1	Demolition	Demolition	11/7/2022	11/6/2022	5	0	

Acres of Grading (Site Preparation Phase): 0

Acres of Grading (Grading Phase): 0

Perris & Ramona Warehouse (Operations) - Riverside-South Coast County, Summer

EMFAC Off-Model Adjustment Factors for Gasoline Light Duty Vehicle to Account for the SAFE Vehicle Rule Applied

3.2 Demolition - 2022

Mitigated Construction Off-Site

	ROG	NOx	CO	SO2	Fugitive PM10	Exhaust PM10	PM10 Total	Fugitive PM2.5	Exhaust PM2.5	PM2.5 Total	Bio- CO2	NBio- CO2	Total CO2	CH4	N2O	CO2e
Category	lb/day										lb/day					
Hauling	0.0000	0.0000	0.0000	0.0000	0.0000	0.0000	0.0000	0.0000	0.0000	0.0000	0.0000	0.0000	0.0000	0.0000	0.0000	0.0000
Vendor	0.0000	0.0000	0.0000	0.0000	0.0000	0.0000	0.0000	0.0000	0.0000	0.0000	0.0000	0.0000	0.0000	0.0000	0.0000	0.0000
Worker	0.0000	0.0000	0.0000	0.0000	0.0000	0.0000	0.0000	0.0000	0.0000	0.0000	0.0000	0.0000	0.0000	0.0000	0.0000	0.0000
Total	0.0000	0.0000	0.0000	0.0000	0.0000	0.0000	0.0000	0.0000	0.0000	0.0000	0.0000	0.0000	0.0000	0.0000	0.0000	0.0000

4.0 Operational Detail - Mobile

4.1 Mitigation Measures Mobile

Perris & Ramona Warehouse (Operations) - Riverside-South Coast County, Summer

EMFAC Off-Model Adjustment Factors for Gasoline Light Duty Vehicle to Account for the SAFE Vehicle Rule Applied

	ROG	NOx	CO	SO2	Fugitive PM10	Exhaust PM10	PM10 Total	Fugitive PM2.5	Exhaust PM2.5	PM2.5 Total	Bio- CO2	NBio- CO2	Total CO2	CH4	N2O	CO2e
Category	lb/day										lb/day					
Mitigated	3.2185	5.5581	27.0298	0.0668	5.9023	0.0619	5.9642	1.5775	0.0583	1.6358		6,902.0181	6,902.0181	0.3187	0.4478	7,043.4145
Unmitigated	3.2185	5.5581	27.0298	0.0668	5.9023	0.0619	5.9642	1.5775	0.0583	1.6358		6,902.0181	6,902.0181	0.3187	0.4478	7,043.4145

4.2 Trip Summary Information

Land Use	Average Daily Trip Rate			Unmitigated	Mitigated
	Weekday	Saturday	Sunday	Annual VMT	Annual VMT
City Park	0.00	0.00	0.00		
Fast Food Restaurant with Drive Thru	419.90	553.20	424.32	671,653	671,653
Other Asphalt Surfaces	0.00	0.00	0.00		
Parking Lot	0.00	0.00	0.00		
Strip Mall	162.01	213.44	163.70	498,186	498,186
Unrefrigerated Warehouse-No Rail	359.39	240.61	222.34	987,135	987,135
User Defined Industrial	67.01	45.69	42.64	184,921	184,921
Total	1,008.31	1,052.94	852.99	2,341,895	2,341,895

4.3 Trip Type Information

Land Use	Miles			Trip %			Trip Purpose %		
	H-W or C-W	H-S or C-C	H-O or C-NW	H-W or C-W	H-S or C-C	H-O or C-NW	Primary	Diverted	Pass-by
City Park	16.60	8.40	6.90	0.00	0.00	0.00	0	0	0
Fast Food Restaurant with Drive	16.60	8.40	6.90	2.20	78.80	19.00	50	0	50
Other Asphalt Surfaces	16.60	8.40	6.90	0.00	0.00	0.00	0	0	0
Parking Lot	16.60	8.40	6.90	0.00	0.00	0.00	0	0	0
Strip Mall	16.60	8.40	6.90	16.60	64.40	19.00	85	0	15

Perris & Ramona Warehouse (Operations) - Riverside-South Coast County, Summer

EMFAC Off-Model Adjustment Factors for Gasoline Light Duty Vehicle to Account for the SAFE Vehicle Rule Applied

Land Use	Miles			Trip %			Trip Purpose %		
	H-W or C-W	H-S or C-C	H-O or C-NW	H-W or C-W	H-S or C-C	H-O or C-NW	Primary	Diverted	Pass-by
Unrefrigerated Warehouse-No	40.00	8.40	6.90	0.00	100.00	0.00	100	0	0
User Defined Industrial	16.60	8.40	6.90	0.00	100.00	0.00	100	0	0

4.4 Fleet Mix

Land Use	LDA	LDT1	LDT2	MDV	LHD1	LHD2	MHD	HHD	OBUS	UBUS	MCY	SBUS	MH
City Park	0.534849	0.056022	0.172639	0.141007	0.026597	0.007310	0.011327	0.018693	0.000616	0.000315	0.024057	0.001100	0.005468
Fast Food Restaurant with Drive Thru	0.534849	0.056022	0.172639	0.141007	0.026597	0.007310	0.011327	0.018693	0.000616	0.000315	0.024057	0.001100	0.005468
Other Asphalt Surfaces	0.534849	0.056022	0.172639	0.141007	0.026597	0.007310	0.011327	0.018693	0.000616	0.000315	0.024057	0.001100	0.005468
Parking Lot	0.534849	0.056022	0.172639	0.141007	0.026597	0.007310	0.011327	0.018693	0.000616	0.000315	0.024057	0.001100	0.005468
Strip Mall	0.534849	0.056022	0.172639	0.141007	0.026597	0.007310	0.011327	0.018693	0.000616	0.000315	0.024057	0.001100	0.005468
Unrefrigerated Warehouse-No Rail	0.557600	0.045200	0.221700	0.153000	0.000000	0.000000	0.000000	0.000000	0.000000	0.000000	0.022500	0.000000	0.000000
User Defined Industrial	0.000000	0.000000	0.000000	0.000000	0.137600	0.038900	0.205900	0.617600	0.000000	0.000000	0.000000	0.000000	0.000000

5.0 Energy Detail

Historical Energy Use: N

5.1 Mitigation Measures Energy

Perris & Ramona Warehouse (Operations) - Riverside-South Coast County, Summer

EMFAC Off-Model Adjustment Factors for Gasoline Light Duty Vehicle to Account for the SAFE Vehicle Rule Applied

	ROG	NOx	CO	SO2	Fugitive PM10	Exhaust PM10	PM10 Total	Fugitive PM2.5	Exhaust PM2.5	PM2.5 Total	Bio- CO2	NBio- CO2	Total CO2	CH4	N2O	CO2e
Category	lb/day										lb/day					
NaturalGas Mitigated	0.0345	0.3138	0.2636	1.8800e-003		0.0239	0.0239		0.0239	0.0239		376.5994	376.5994	7.2200e-003	6.9000e-003	378.8374
NaturalGas Unmitigated	0.0345	0.3138	0.2636	1.8800e-003		0.0239	0.0239		0.0239	0.0239		376.5994	376.5994	7.2200e-003	6.9000e-003	378.8374

Perris & Ramona Warehouse (Operations) - Riverside-South Coast County, Summer

EMFAC Off-Model Adjustment Factors for Gasoline Light Duty Vehicle to Account for the SAFE Vehicle Rule Applied

5.2 Energy by Land Use - NaturalGas

Unmitigated

	NaturalGas Use	ROG	NOx	CO	SO2	Fugitive PM10	Exhaust PM10	PM10 Total	Fugitive PM2.5	Exhaust PM2.5	PM2.5 Total	Bio- CO2	NBio- CO2	Total CO2	CH4	N2O	CO2e
Land Use	kBTU/yr	lb/day										lb/day					
City Park	0	0.0000	0.0000	0.0000	0.0000		0.0000	0.0000		0.0000	0.0000		0.0000	0.0000	0.0000	0.0000	0.0000
Fast Food Restaurant with Drive Thru	1494.03	0.0161	0.1465	0.1230	8.8000e-004		0.0111	0.0111		0.0111	0.0111		175.7679	175.7679	3.3700e-003	3.2200e-003	176.8124
Other Asphalt Surfaces	0	0.0000	0.0000	0.0000	0.0000		0.0000	0.0000		0.0000	0.0000		0.0000	0.0000	0.0000	0.0000	0.0000
Parking Lot	0	0.0000	0.0000	0.0000	0.0000		0.0000	0.0000		0.0000	0.0000		0.0000	0.0000	0.0000	0.0000	0.0000
Strip Mall	29.8356	3.2000e-004	2.9300e-003	2.4600e-003	2.0000e-005		2.2000e-004	2.2000e-004		2.2000e-004	2.2000e-004		3.5101	3.5101	7.0000e-005	6.0000e-005	3.5309
Unrefrigerated Warehouse-No Rail	1677.23	0.0181	0.1644	0.1381	9.9000e-004		0.0125	0.0125		0.0125	0.0125		197.3214	197.3214	3.7800e-003	3.6200e-003	198.4940
User Defined Industrial	0	0.0000	0.0000	0.0000	0.0000		0.0000	0.0000		0.0000	0.0000		0.0000	0.0000	0.0000	0.0000	0.0000
Total		0.0345	0.3138	0.2636	1.8900e-003		0.0239	0.0239		0.0239	0.0239		376.5994	376.5994	7.2200e-003	6.9000e-003	378.8374

Perris & Ramona Warehouse (Operations) - Riverside-South Coast County, Summer

EMFAC Off-Model Adjustment Factors for Gasoline Light Duty Vehicle to Account for the SAFE Vehicle Rule Applied

5.2 Energy by Land Use - NaturalGas

Mitigated

	NaturalGas Use	ROG	NOx	CO	SO2	Fugitive PM10	Exhaust PM10	PM10 Total	Fugitive PM2.5	Exhaust PM2.5	PM2.5 Total	Bio- CO2	NBio- CO2	Total CO2	CH4	N2O	CO2e
Land Use	kBTU/yr	lb/day										lb/day					
City Park	0	0.0000	0.0000	0.0000	0.0000		0.0000	0.0000		0.0000	0.0000		0.0000	0.0000	0.0000	0.0000	0.0000
Fast Food Restaurant with Drive Thru	1.49403	0.0161	0.1465	0.1230	8.8000e-004		0.0111	0.0111		0.0111	0.0111		175.7679	175.7679	3.3700e-003	3.2200e-003	176.8124
Other Asphalt Surfaces	0	0.0000	0.0000	0.0000	0.0000		0.0000	0.0000		0.0000	0.0000		0.0000	0.0000	0.0000	0.0000	0.0000
Parking Lot	0	0.0000	0.0000	0.0000	0.0000		0.0000	0.0000		0.0000	0.0000		0.0000	0.0000	0.0000	0.0000	0.0000
Strip Mall	0.0298356	3.2000e-004	2.9300e-003	2.4600e-003	2.0000e-005		2.2000e-004	2.2000e-004		2.2000e-004	2.2000e-004		3.5101	3.5101	7.0000e-005	6.0000e-005	3.5309
Unrefrigerated Warehouse-No Rail	1.67723	0.0181	0.1644	0.1381	9.9000e-004		0.0125	0.0125		0.0125	0.0125		197.3214	197.3214	3.7800e-003	3.6200e-003	198.4940
User Defined Industrial	0	0.0000	0.0000	0.0000	0.0000		0.0000	0.0000		0.0000	0.0000		0.0000	0.0000	0.0000	0.0000	0.0000
Total		0.0345	0.3138	0.2636	1.8900e-003		0.0239	0.0239		0.0239	0.0239		376.5994	376.5994	7.2200e-003	6.9000e-003	378.8374

6.0 Area Detail

6.1 Mitigation Measures Area

Perris & Ramona Warehouse (Operations) - Riverside-South Coast County, Summer

EMFAC Off-Model Adjustment Factors for Gasoline Light Duty Vehicle to Account for the SAFE Vehicle Rule Applied

	ROG	NOx	CO	SO2	Fugitive PM10	Exhaust PM10	PM10 Total	Fugitive PM2.5	Exhaust PM2.5	PM2.5 Total	Bio- CO2	NBio- CO2	Total CO2	CH4	N2O	CO2e
Category	lb/day										lb/day					
Mitigated	7.0904	9.7000e-004	0.1066	1.0000e-005		3.8000e-004	3.8000e-004		3.8000e-004	3.8000e-004		0.2285	0.2285	6.0000e-004		0.2435
Unmitigated	7.0904	9.7000e-004	0.1066	1.0000e-005		3.8000e-004	3.8000e-004		3.8000e-004	3.8000e-004		0.2285	0.2285	6.0000e-004		0.2435

6.2 Area by SubCategory

Unmitigated

	ROG	NOx	CO	SO2	Fugitive PM10	Exhaust PM10	PM10 Total	Fugitive PM2.5	Exhaust PM2.5	PM2.5 Total	Bio- CO2	NBio- CO2	Total CO2	CH4	N2O	CO2e
SubCategory	lb/day										lb/day					
Architectural Coating	0.8118					0.0000	0.0000		0.0000	0.0000			0.0000			0.0000
Consumer Products	6.2687					0.0000	0.0000		0.0000	0.0000			0.0000			0.0000
Landscaping	9.8700e-003	9.7000e-004	0.1066	1.0000e-005		3.8000e-004	3.8000e-004		3.8000e-004	3.8000e-004		0.2285	0.2285	6.0000e-004		0.2435
Total	7.0904	9.7000e-004	0.1066	1.0000e-005		3.8000e-004	3.8000e-004		3.8000e-004	3.8000e-004		0.2285	0.2285	6.0000e-004		0.2435

Perris & Ramona Warehouse (Operations) - Riverside-South Coast County, Summer

EMFAC Off-Model Adjustment Factors for Gasoline Light Duty Vehicle to Account for the SAFE Vehicle Rule Applied

6.2 Area by SubCategory

Mitigated

	ROG	NOx	CO	SO2	Fugitive PM10	Exhaust PM10	PM10 Total	Fugitive PM2.5	Exhaust PM2.5	PM2.5 Total	Bio- CO2	NBio- CO2	Total CO2	CH4	N2O	CO2e
SubCategory	lb/day										lb/day					
Architectural Coating	0.8118					0.0000	0.0000		0.0000	0.0000			0.0000			0.0000
Consumer Products	6.2687					0.0000	0.0000		0.0000	0.0000			0.0000			0.0000
Landscaping	9.8700e-003	9.7000e-004	0.1066	1.0000e-005		3.8000e-004	3.8000e-004		3.8000e-004	3.8000e-004		0.2285	0.2285	6.0000e-004		0.2435
Total	7.0904	9.7000e-004	0.1066	1.0000e-005		3.8000e-004	3.8000e-004		3.8000e-004	3.8000e-004		0.2285	0.2285	6.0000e-004		0.2435

7.0 Water Detail

7.1 Mitigation Measures Water

8.0 Waste Detail

8.1 Mitigation Measures Waste

9.0 Operational Offroad

Equipment Type	Number	Hours/Day	Days/Year	Horse Power	Load Factor	Fuel Type
Tractors/Loaders/Backhoes	2	4.00	365	200	0.37	CNG

Perris & Ramona Warehouse (Operations) - Riverside-South Coast County, Summer

EMFAC Off-Model Adjustment Factors for Gasoline Light Duty Vehicle to Account for the SAFE Vehicle Rule Applied

UnMitigated/Mitigated

	ROG	NOx	CO	SO2	Fugitive PM10	Exhaust PM10	PM10 Total	Fugitive PM2.5	Exhaust PM2.5	PM2.5 Total	Bio- CO2	NBio- CO2	Total CO2	CH4	N2O	CO2e
Equipment Type	lb/day										lb/day					
Tractors/Loaders/Backhoes	0.2207	2.0721	1.4984	6.3300e-003		0.0752	0.0752		0.0692	0.0692	0.0000	613.0902	613.0902	0.1983		618.0473
Total	0.2207	2.0721	1.4984	6.3300e-003		0.0752	0.0752		0.0692	0.0692	0.0000	613.0902	613.0902	0.1983		618.0473

10.0 Stationary Equipment

Fire Pumps and Emergency Generators

Equipment Type	Number	Hours/Day	Hours/Year	Horse Power	Load Factor	Fuel Type
----------------	--------	-----------	------------	-------------	-------------	-----------

Boilers

Equipment Type	Number	Heat Input/Day	Heat Input/Year	Boiler Rating	Fuel Type
----------------	--------	----------------	-----------------	---------------	-----------

User Defined Equipment

Equipment Type	Number
----------------	--------

11.0 Vegetation

Perris & Ramona Warehouse (Operations) - Riverside-South Coast County, Winter

EMFAC Off-Model Adjustment Factors for Gasoline Light Duty Vehicle to Account for the SAFE Vehicle Rule Applied

Perris & Ramona Warehouse (Operations)

Riverside-South Coast County, Winter

1.0 Project Characteristics

1.1 Land Usage

Land Uses	Size	Metric	Lot Acreage	Floor Surface Area	Population
Unrefrigerated Warehouse-No Rail	304.57	1000sqft	6.99	304,572.00	0
User Defined Industrial	304.57	User Defined Unit	0.00	0.00	0
Other Asphalt Surfaces	211.79	1000sqft	4.86	211,794.00	0
Parking Lot	214.00	Space	1.34	58,493.00	0
City Park	2.16	Acre	2.16	94,036.00	0
Fast Food Restaurant with Drive Thru	2.00	1000sqft	0.05	2,000.00	0
Strip Mall	4.95	1000sqft	0.11	4,950.00	0

1.2 Other Project Characteristics

Urbanization	Urban	Wind Speed (m/s)	2.4	Precipitation Freq (Days)	28
Climate Zone	10			Operational Year	2023
Utility Company	Southern California Edison				
CO2 Intensity (lb/MW hr)	390.98	CH4 Intensity (lb/MW hr)	0.033	N2O Intensity (lb/MW hr)	0.004

1.3 User Entered Comments & Non-Default Data

Project Characteristics -
 Land Use - Total Project area is +/- 15.5 acres
 Construction Phase - Operations run only
 Off-road Equipment - Operations run only

Operational Off-Road Equipment - Based on SCAQMD High Cube Warehouse Truck Trip Study White Paper Summary of Business Survey Results (2014)
Perris & Ramona Warehouse (Operations) - Riverside-South Coast County, Winter

EMFAC Off-Model Adjustment Factors for Gasoline Light Duty Vehicle to Account for the SAFE Vehicle Rule Applied

Perris & Ramona Warehouse (Operations) - Riverside-South Coast County, Winter

EMFAC Off-Model Adjustment Factors for Gasoline Light Duty Vehicle to Account for the SAFE Vehicle Rule Applied

Fleet Mix - Passenger Car Mix estimated based on the CalEEMod default fleet mix and the ratio of the vehicle classes (LDA, LDT1, LDT2, MDV, & MCY). Truck Mix based on information in the Traffic analysis

Table Name	Column Name	Default Value	New Value
tblConstructionPhase	NumDays	20.00	0.00
tblFleetMix	HHD	0.02	0.00
tblFleetMix	HHD	0.02	0.62
tblFleetMix	LDA	0.53	0.56
tblFleetMix	LDA	0.53	0.00
tblFleetMix	LDT1	0.06	0.05
tblFleetMix	LDT1	0.06	0.00
tblFleetMix	LDT2	0.17	0.22
tblFleetMix	LDT2	0.17	0.00
tblFleetMix	LHD1	0.03	0.00
tblFleetMix	LHD1	0.03	0.14
tblFleetMix	LHD2	7.3100e-003	0.00
tblFleetMix	LHD2	7.3100e-003	0.04
tblFleetMix	MCY	0.02	0.02
tblFleetMix	MCY	0.02	0.00
tblFleetMix	MDV	0.14	0.15
tblFleetMix	MDV	0.14	0.00
tblFleetMix	MH	5.4680e-003	0.00
tblFleetMix	MH	5.4680e-003	0.00
tblFleetMix	MHD	0.01	0.00
tblFleetMix	MHD	0.01	0.21
tblFleetMix	OBUS	6.1600e-004	0.00
tblFleetMix	OBUS	6.1600e-004	0.00
tblFleetMix	SBUS	1.1000e-003	0.00
tblFleetMix	SBUS	1.1000e-003	0.00
tblFleetMix	UBUS	3.1500e-004	0.00

Perris & Ramona Warehouse (Operations) - Riverside-South Coast County, Winter

EMFAC Off-Model Adjustment Factors for Gasoline Light Duty Vehicle to Account for the SAFE Vehicle Rule Applied

tblFleetMix	UBUS	3.1500e-004	0.00
tblLandUse	LandUseSquareFeet	85,600.00	58,493.00
tblLandUse	LandUseSquareFeet	94,089.60	94,036.00
tblLandUse	LotAcreage	1.93	1.34
tblOffRoadEquipment	OffRoadEquipmentUnitAmount	1.00	0.00
tblOffRoadEquipment	OffRoadEquipmentUnitAmount	3.00	0.00
tblOffRoadEquipment	OffRoadEquipmentUnitAmount	2.00	0.00
tblOperationalOffRoadEquipment	OperDaysPerYear	260.00	365.00
tblOperationalOffRoadEquipment	OperFuelType	Diesel	CNG
tblOperationalOffRoadEquipment	OperHorsePower	97.00	200.00
tblOperationalOffRoadEquipment	OperHoursPerDay	8.00	4.00
tblOperationalOffRoadEquipment	OperOffRoadEquipmentNumber	0.00	2.00
tblVehicleTrips	CC_TTP	48.00	0.00
tblVehicleTrips	CC_TTP	0.00	100.00
tblVehicleTrips	CC_TTP	0.00	100.00
tblVehicleTrips	CNW_TTP	19.00	0.00
tblVehicleTrips	CNW_TTP	41.00	0.00
tblVehicleTrips	CW_TL	16.60	40.00
tblVehicleTrips	CW_TTP	33.00	0.00
tblVehicleTrips	CW_TTP	59.00	0.00
tblVehicleTrips	DV_TP	28.00	0.00
tblVehicleTrips	DV_TP	21.00	0.00
tblVehicleTrips	DV_TP	40.00	0.00
tblVehicleTrips	DV_TP	5.00	0.00
tblVehicleTrips	PB_TP	6.00	0.00
tblVehicleTrips	PB_TP	3.00	0.00
tblVehicleTrips	PR_TP	66.00	0.00
tblVehicleTrips	PR_TP	29.00	50.00
tblVehicleTrips	PR_TP	45.00	85.00

Perris & Ramona Warehouse (Operations) - Riverside-South Coast County, Winter

EMFAC Off-Model Adjustment Factors for Gasoline Light Duty Vehicle to Account for the SAFE Vehicle Rule Applied

tblVehicleTrips	PR_TP	92.00	100.00
tblVehicleTrips	PR_TP	0.00	100.00
tblVehicleTrips	ST_TR	1.96	0.00
tblVehicleTrips	ST_TR	616.12	276.60
tblVehicleTrips	ST_TR	42.04	43.12
tblVehicleTrips	ST_TR	1.74	0.79
tblVehicleTrips	ST_TR	0.00	0.15
tblVehicleTrips	SU_TR	2.19	0.00
tblVehicleTrips	SU_TR	472.58	212.16
tblVehicleTrips	SU_TR	20.43	33.07
tblVehicleTrips	SU_TR	1.74	0.73
tblVehicleTrips	SU_TR	0.00	0.14
tblVehicleTrips	WD_TR	0.78	0.00
tblVehicleTrips	WD_TR	470.95	209.95
tblVehicleTrips	WD_TR	44.32	32.73
tblVehicleTrips	WD_TR	1.74	1.18
tblVehicleTrips	WD_TR	0.00	0.22

2.0 Emissions Summary

Perris & Ramona Warehouse (Operations) - Riverside-South Coast County, Winter

EMFAC Off-Model Adjustment Factors for Gasoline Light Duty Vehicle to Account for the SAFE Vehicle Rule Applied

2.2 Overall Operational

Unmitigated Operational

	ROG	NOx	CO	SO2	Fugitive PM10	Exhaust PM10	PM10 Total	Fugitive PM2.5	Exhaust PM2.5	PM2.5 Total	Bio- CO2	NBio- CO2	Total CO2	CH4	N2O	CO2e
Category	lb/day										lb/day					
Area	7.0904	9.7000e-004	0.1066	1.0000e-005		3.8000e-004	3.8000e-004		3.8000e-004	3.8000e-004		0.2285	0.2285	6.0000e-004		0.2435
Energy	0.0345	0.3138	0.2636	1.8800e-003		0.0239	0.0239		0.0239	0.0239		376.5994	376.5994	7.2200e-003	6.9000e-003	378.8374
Mobile	2.6854	5.8961	24.3851	0.0627	5.9023	0.0620	5.9643	1.5775	0.0584	1.6359		6,486.9160	6,486.9160	0.3310	0.4544	6,630.6097
Offroad	0.2207	2.0721	1.4984	6.3300e-003		0.0752	0.0752		0.0692	0.0692	0.0000	613.0902	613.0902	0.1983		618.0473
Total	10.0310	8.2831	26.2537	0.0709	5.9023	0.1614	6.0637	1.5775	0.1518	1.7293	0.0000	7,476.8342	7,476.8342	0.5371	0.4613	7,627.7378

Perris & Ramona Warehouse (Operations) - Riverside-South Coast County, Winter

EMFAC Off-Model Adjustment Factors for Gasoline Light Duty Vehicle to Account for the SAFE Vehicle Rule Applied

2.2 Overall Operational

Mitigated Operational

	ROG	NOx	CO	SO2	Fugitive PM10	Exhaust PM10	PM10 Total	Fugitive PM2.5	Exhaust PM2.5	PM2.5 Total	Bio- CO2	NBio- CO2	Total CO2	CH4	N2O	CO2e
Category	lb/day										lb/day					
Area	7.0904	9.7000e-004	0.1066	1.0000e-005		3.8000e-004	3.8000e-004		3.8000e-004	3.8000e-004		0.2285	0.2285	6.0000e-004		0.2435
Energy	0.0345	0.3138	0.2636	1.8800e-003		0.0239	0.0239		0.0239	0.0239		376.5994	376.5994	7.2200e-003	6.9000e-003	378.8374
Mobile	2.6854	5.8961	24.3851	0.0627	5.9023	0.0620	5.9643	1.5775	0.0584	1.6359		6,486.9160	6,486.9160	0.3310	0.4544	6,630.6097
Offroad	0.2207	2.0721	1.4984	6.3300e-003		0.0752	0.0752		0.0692	0.0692	0.0000	613.0902	613.0902	0.1983		618.0473
Total	10.0310	8.2831	26.2537	0.0709	5.9023	0.1614	6.0637	1.5775	0.1518	1.7293	0.0000	7,476.8342	7,476.8342	0.5371	0.4613	7,627.7378

	ROG	NOx	CO	SO2	Fugitive PM10	Exhaust PM10	PM10 Total	Fugitive PM2.5	Exhaust PM2.5	PM2.5 Total	Bio- CO2	NBio-CO2	Total CO2	CH4	N2O	CO2e
Percent Reduction	0.00	0.00	0.00	0.00	0.00	0.00	0.00	0.00	0.00	0.00	0.00	0.00	0.00	0.00	0.00	0.00

3.0 Construction Detail

Construction Phase

Phase Number	Phase Name	Phase Type	Start Date	End Date	Num Days Week	Num Days	Phase Description
1	Demolition	Demolition	11/7/2022	11/6/2022	5	0	

Acres of Grading (Site Preparation Phase): 0

Acres of Grading (Grading Phase): 0

Perris & Ramona Warehouse (Operations) - Riverside-South Coast County, Winter

EMFAC Off-Model Adjustment Factors for Gasoline Light Duty Vehicle to Account for the SAFE Vehicle Rule Applied

3.2 Demolition - 2022

Mitigated Construction Off-Site

	ROG	NOx	CO	SO2	Fugitive PM10	Exhaust PM10	PM10 Total	Fugitive PM2.5	Exhaust PM2.5	PM2.5 Total	Bio- CO2	NBio- CO2	Total CO2	CH4	N2O	CO2e	
Category	lb/day										lb/day						
Hauling	0.0000	0.0000	0.0000	0.0000	0.0000	0.0000	0.0000	0.0000	0.0000	0.0000	0.0000	0.0000	0.0000	0.0000	0.0000	0.0000	0.0000
Vendor	0.0000	0.0000	0.0000	0.0000	0.0000	0.0000	0.0000	0.0000	0.0000	0.0000	0.0000	0.0000	0.0000	0.0000	0.0000	0.0000	0.0000
Worker	0.0000	0.0000	0.0000	0.0000	0.0000	0.0000	0.0000	0.0000	0.0000	0.0000	0.0000	0.0000	0.0000	0.0000	0.0000	0.0000	0.0000
Total	0.0000	0.0000	0.0000	0.0000	0.0000	0.0000	0.0000	0.0000	0.0000	0.0000	0.0000	0.0000	0.0000	0.0000	0.0000	0.0000	0.0000

4.0 Operational Detail - Mobile

4.1 Mitigation Measures Mobile

Perris & Ramona Warehouse (Operations) - Riverside-South Coast County, Winter

EMFAC Off-Model Adjustment Factors for Gasoline Light Duty Vehicle to Account for the SAFE Vehicle Rule Applied

	ROG	NOx	CO	SO2	Fugitive PM10	Exhaust PM10	PM10 Total	Fugitive PM2.5	Exhaust PM2.5	PM2.5 Total	Bio- CO2	NBio- CO2	Total CO2	CH4	N2O	CO2e
Category	lb/day										lb/day					
Mitigated	2.6854	5.8961	24.3851	0.0627	5.9023	0.0620	5.9643	1.5775	0.0584	1.6359		6,486.9160	6,486.9160	0.3310	0.4544	6,630.6097
Unmitigated	2.6854	5.8961	24.3851	0.0627	5.9023	0.0620	5.9643	1.5775	0.0584	1.6359		6,486.9160	6,486.9160	0.3310	0.4544	6,630.6097

4.2 Trip Summary Information

Land Use	Average Daily Trip Rate			Unmitigated	Mitigated
	Weekday	Saturday	Sunday	Annual VMT	Annual VMT
City Park	0.00	0.00	0.00		
Fast Food Restaurant with Drive Thru	419.90	553.20	424.32	671,653	671,653
Other Asphalt Surfaces	0.00	0.00	0.00		
Parking Lot	0.00	0.00	0.00		
Strip Mall	162.01	213.44	163.70	498,186	498,186
Unrefrigerated Warehouse-No Rail	359.39	240.61	222.34	987,135	987,135
User Defined Industrial	67.01	45.69	42.64	184,921	184,921
Total	1,008.31	1,052.94	852.99	2,341,895	2,341,895

4.3 Trip Type Information

Land Use	Miles			Trip %			Trip Purpose %		
	H-W or C-W	H-S or C-C	H-O or C-NW	H-W or C-W	H-S or C-C	H-O or C-NW	Primary	Diverted	Pass-by
City Park	16.60	8.40	6.90	0.00	0.00	0.00	0	0	0
Fast Food Restaurant with Drive	16.60	8.40	6.90	2.20	78.80	19.00	50	0	50
Other Asphalt Surfaces	16.60	8.40	6.90	0.00	0.00	0.00	0	0	0
Parking Lot	16.60	8.40	6.90	0.00	0.00	0.00	0	0	0
Strip Mall	16.60	8.40	6.90	16.60	64.40	19.00	85	0	15

Perris & Ramona Warehouse (Operations) - Riverside-South Coast County, Winter

EMFAC Off-Model Adjustment Factors for Gasoline Light Duty Vehicle to Account for the SAFE Vehicle Rule Applied

Land Use	Miles			Trip %			Trip Purpose %		
	H-W or C-W	H-S or C-C	H-O or C-NW	H-W or C-W	H-S or C-C	H-O or C-NW	Primary	Diverted	Pass-by
Unrefrigerated Warehouse-No	40.00	8.40	6.90	0.00	100.00	0.00	100	0	0
User Defined Industrial	16.60	8.40	6.90	0.00	100.00	0.00	100	0	0

4.4 Fleet Mix

Land Use	LDA	LDT1	LDT2	MDV	LHD1	LHD2	MHD	HHD	OBUS	UBUS	MCY	SBUS	MH
City Park	0.534849	0.056022	0.172639	0.141007	0.026597	0.007310	0.011327	0.018693	0.000616	0.000315	0.024057	0.001100	0.005468
Fast Food Restaurant with Drive Thru	0.534849	0.056022	0.172639	0.141007	0.026597	0.007310	0.011327	0.018693	0.000616	0.000315	0.024057	0.001100	0.005468
Other Asphalt Surfaces	0.534849	0.056022	0.172639	0.141007	0.026597	0.007310	0.011327	0.018693	0.000616	0.000315	0.024057	0.001100	0.005468
Parking Lot	0.534849	0.056022	0.172639	0.141007	0.026597	0.007310	0.011327	0.018693	0.000616	0.000315	0.024057	0.001100	0.005468
Strip Mall	0.534849	0.056022	0.172639	0.141007	0.026597	0.007310	0.011327	0.018693	0.000616	0.000315	0.024057	0.001100	0.005468
Unrefrigerated Warehouse-No Rail	0.557600	0.045200	0.221700	0.153000	0.000000	0.000000	0.000000	0.000000	0.000000	0.000000	0.022500	0.000000	0.000000
User Defined Industrial	0.000000	0.000000	0.000000	0.000000	0.137600	0.038900	0.205900	0.617600	0.000000	0.000000	0.000000	0.000000	0.000000

5.0 Energy Detail

Historical Energy Use: N

5.1 Mitigation Measures Energy

Perris & Ramona Warehouse (Operations) - Riverside-South Coast County, Winter

EMFAC Off-Model Adjustment Factors for Gasoline Light Duty Vehicle to Account for the SAFE Vehicle Rule Applied

	ROG	NOx	CO	SO2	Fugitive PM10	Exhaust PM10	PM10 Total	Fugitive PM2.5	Exhaust PM2.5	PM2.5 Total	Bio- CO2	NBio- CO2	Total CO2	CH4	N2O	CO2e
Category	lb/day										lb/day					
NaturalGas Mitigated	0.0345	0.3138	0.2636	1.8800e-003		0.0239	0.0239		0.0239	0.0239		376.5994	376.5994	7.2200e-003	6.9000e-003	378.8374
NaturalGas Unmitigated	0.0345	0.3138	0.2636	1.8800e-003		0.0239	0.0239		0.0239	0.0239		376.5994	376.5994	7.2200e-003	6.9000e-003	378.8374

Perris & Ramona Warehouse (Operations) - Riverside-South Coast County, Winter

EMFAC Off-Model Adjustment Factors for Gasoline Light Duty Vehicle to Account for the SAFE Vehicle Rule Applied

5.2 Energy by Land Use - NaturalGas

Unmitigated

	NaturalGas Use	ROG	NOx	CO	SO2	Fugitive PM10	Exhaust PM10	PM10 Total	Fugitive PM2.5	Exhaust PM2.5	PM2.5 Total	Bio- CO2	NBio- CO2	Total CO2	CH4	N2O	CO2e
Land Use	kBTU/yr	lb/day										lb/day					
City Park	0	0.0000	0.0000	0.0000	0.0000		0.0000	0.0000		0.0000	0.0000		0.0000	0.0000	0.0000	0.0000	0.0000
Fast Food Restaurant with Drive Thru	1494.03	0.0161	0.1465	0.1230	8.8000e-004		0.0111	0.0111		0.0111	0.0111		175.7679	175.7679	3.3700e-003	3.2200e-003	176.8124
Other Asphalt Surfaces	0	0.0000	0.0000	0.0000	0.0000		0.0000	0.0000		0.0000	0.0000		0.0000	0.0000	0.0000	0.0000	0.0000
Parking Lot	0	0.0000	0.0000	0.0000	0.0000		0.0000	0.0000		0.0000	0.0000		0.0000	0.0000	0.0000	0.0000	0.0000
Strip Mall	29.8356	3.2000e-004	2.9300e-003	2.4600e-003	2.0000e-005		2.2000e-004	2.2000e-004		2.2000e-004	2.2000e-004		3.5101	3.5101	7.0000e-005	6.0000e-005	3.5309
Unrefrigerated Warehouse-No Rail	1677.23	0.0181	0.1644	0.1381	9.9000e-004		0.0125	0.0125		0.0125	0.0125		197.3214	197.3214	3.7800e-003	3.6200e-003	198.4940
User Defined Industrial	0	0.0000	0.0000	0.0000	0.0000		0.0000	0.0000		0.0000	0.0000		0.0000	0.0000	0.0000	0.0000	0.0000
Total		0.0345	0.3138	0.2636	1.8900e-003		0.0239	0.0239		0.0239	0.0239		376.5994	376.5994	7.2200e-003	6.9000e-003	378.8374

Perris & Ramona Warehouse (Operations) - Riverside-South Coast County, Winter

EMFAC Off-Model Adjustment Factors for Gasoline Light Duty Vehicle to Account for the SAFE Vehicle Rule Applied

5.2 Energy by Land Use - NaturalGas

Mitigated

	NaturalGas Use	ROG	NOx	CO	SO2	Fugitive PM10	Exhaust PM10	PM10 Total	Fugitive PM2.5	Exhaust PM2.5	PM2.5 Total	Bio- CO2	NBio- CO2	Total CO2	CH4	N2O	CO2e
Land Use	kBTU/yr	lb/day										lb/day					
City Park	0	0.0000	0.0000	0.0000	0.0000		0.0000	0.0000		0.0000	0.0000		0.0000	0.0000	0.0000	0.0000	0.0000
Fast Food Restaurant with Drive Thru	1.49403	0.0161	0.1465	0.1230	8.8000e-004		0.0111	0.0111		0.0111	0.0111		175.7679	175.7679	3.3700e-003	3.2200e-003	176.8124
Other Asphalt Surfaces	0	0.0000	0.0000	0.0000	0.0000		0.0000	0.0000		0.0000	0.0000		0.0000	0.0000	0.0000	0.0000	0.0000
Parking Lot	0	0.0000	0.0000	0.0000	0.0000		0.0000	0.0000		0.0000	0.0000		0.0000	0.0000	0.0000	0.0000	0.0000
Strip Mall	0.0298356	3.2000e-004	2.9300e-003	2.4600e-003	2.0000e-005		2.2000e-004	2.2000e-004		2.2000e-004	2.2000e-004		3.5101	3.5101	7.0000e-005	6.0000e-005	3.5309
Unrefrigerated Warehouse-No Rail	1.67723	0.0181	0.1644	0.1381	9.9000e-004		0.0125	0.0125		0.0125	0.0125		197.3214	197.3214	3.7800e-003	3.6200e-003	198.4940
User Defined Industrial	0	0.0000	0.0000	0.0000	0.0000		0.0000	0.0000		0.0000	0.0000		0.0000	0.0000	0.0000	0.0000	0.0000
Total		0.0345	0.3138	0.2636	1.8900e-003		0.0239	0.0239		0.0239	0.0239		376.5994	376.5994	7.2200e-003	6.9000e-003	378.8374

6.0 Area Detail

6.1 Mitigation Measures Area

Perris & Ramona Warehouse (Operations) - Riverside-South Coast County, Winter

EMFAC Off-Model Adjustment Factors for Gasoline Light Duty Vehicle to Account for the SAFE Vehicle Rule Applied

	ROG	NOx	CO	SO2	Fugitive PM10	Exhaust PM10	PM10 Total	Fugitive PM2.5	Exhaust PM2.5	PM2.5 Total	Bio- CO2	NBio- CO2	Total CO2	CH4	N2O	CO2e
Category	lb/day										lb/day					
Mitigated	7.0904	9.7000e-004	0.1066	1.0000e-005		3.8000e-004	3.8000e-004		3.8000e-004	3.8000e-004		0.2285	0.2285	6.0000e-004		0.2435
Unmitigated	7.0904	9.7000e-004	0.1066	1.0000e-005		3.8000e-004	3.8000e-004		3.8000e-004	3.8000e-004		0.2285	0.2285	6.0000e-004		0.2435

6.2 Area by SubCategory

Unmitigated

	ROG	NOx	CO	SO2	Fugitive PM10	Exhaust PM10	PM10 Total	Fugitive PM2.5	Exhaust PM2.5	PM2.5 Total	Bio- CO2	NBio- CO2	Total CO2	CH4	N2O	CO2e
SubCategory	lb/day										lb/day					
Architectural Coating	0.8118					0.0000	0.0000		0.0000	0.0000			0.0000			0.0000
Consumer Products	6.2687					0.0000	0.0000		0.0000	0.0000			0.0000			0.0000
Landscaping	9.8700e-003	9.7000e-004	0.1066	1.0000e-005		3.8000e-004	3.8000e-004		3.8000e-004	3.8000e-004		0.2285	0.2285	6.0000e-004		0.2435
Total	7.0904	9.7000e-004	0.1066	1.0000e-005		3.8000e-004	3.8000e-004		3.8000e-004	3.8000e-004		0.2285	0.2285	6.0000e-004		0.2435

Perris & Ramona Warehouse (Operations) - Riverside-South Coast County, Winter

EMFAC Off-Model Adjustment Factors for Gasoline Light Duty Vehicle to Account for the SAFE Vehicle Rule Applied

6.2 Area by SubCategory

Mitigated

	ROG	NOx	CO	SO2	Fugitive PM10	Exhaust PM10	PM10 Total	Fugitive PM2.5	Exhaust PM2.5	PM2.5 Total	Bio- CO2	NBio- CO2	Total CO2	CH4	N2O	CO2e
SubCategory	lb/day										lb/day					
Architectural Coating	0.8118					0.0000	0.0000		0.0000	0.0000			0.0000			0.0000
Consumer Products	6.2687					0.0000	0.0000		0.0000	0.0000			0.0000			0.0000
Landscaping	9.8700e-003	9.7000e-004	0.1066	1.0000e-005		3.8000e-004	3.8000e-004		3.8000e-004	3.8000e-004		0.2285	0.2285	6.0000e-004		0.2435
Total	7.0904	9.7000e-004	0.1066	1.0000e-005		3.8000e-004	3.8000e-004		3.8000e-004	3.8000e-004		0.2285	0.2285	6.0000e-004		0.2435

7.0 Water Detail

7.1 Mitigation Measures Water

8.0 Waste Detail

8.1 Mitigation Measures Waste

9.0 Operational Offroad

Equipment Type	Number	Hours/Day	Days/Year	Horse Power	Load Factor	Fuel Type
Tractors/Loaders/Backhoes	2	4.00	365	200	0.37	CNG

Perris & Ramona Warehouse (Operations) - Riverside-South Coast County, Winter

EMFAC Off-Model Adjustment Factors for Gasoline Light Duty Vehicle to Account for the SAFE Vehicle Rule Applied

UnMitigated/Mitigated

	ROG	NOx	CO	SO2	Fugitive PM10	Exhaust PM10	PM10 Total	Fugitive PM2.5	Exhaust PM2.5	PM2.5 Total	Bio- CO2	NBio- CO2	Total CO2	CH4	N2O	CO2e
Equipment Type	lb/day										lb/day					
Tractors/Loaders/Backhoes	0.2207	2.0721	1.4984	6.3300e-003		0.0752	0.0752		0.0692	0.0692	0.0000	613.0902	613.0902	0.1983		618.0473
Total	0.2207	2.0721	1.4984	6.3300e-003		0.0752	0.0752		0.0692	0.0692	0.0000	613.0902	613.0902	0.1983		618.0473

10.0 Stationary Equipment

Fire Pumps and Emergency Generators

Equipment Type	Number	Hours/Day	Hours/Year	Horse Power	Load Factor	Fuel Type
----------------	--------	-----------	------------	-------------	-------------	-----------

Boilers

Equipment Type	Number	Heat Input/Day	Heat Input/Year	Boiler Rating	Fuel Type
----------------	--------	----------------	-----------------	---------------	-----------

User Defined Equipment

Equipment Type	Number
----------------	--------

11.0 Vegetation

Perris & Ramona Warehouse (Operations) - Riverside-South Coast County, Annual

EMFAC Off-Model Adjustment Factors for Gasoline Light Duty Vehicle to Account for the SAFE Vehicle Rule Applied

Perris & Ramona Warehouse (Operations)

Riverside-South Coast County, Annual

1.0 Project Characteristics

1.1 Land Usage

Land Uses	Size	Metric	Lot Acreage	Floor Surface Area	Population
Unrefrigerated Warehouse-No Rail	304.57	1000sqft	6.99	304,572.00	0
User Defined Industrial	304.57	User Defined Unit	0.00	0.00	0
Other Asphalt Surfaces	211.79	1000sqft	4.86	211,794.00	0
Parking Lot	214.00	Space	1.34	58,493.00	0
City Park	2.16	Acre	2.16	94,036.00	0
Fast Food Restaurant with Drive Thru	2.00	1000sqft	0.05	2,000.00	0
Strip Mall	4.95	1000sqft	0.11	4,950.00	0

1.2 Other Project Characteristics

Urbanization	Urban	Wind Speed (m/s)	2.4	Precipitation Freq (Days)	28
Climate Zone	10			Operational Year	2023
Utility Company	Southern California Edison				
CO2 Intensity (lb/MW hr)	390.98	CH4 Intensity (lb/MW hr)	0.033	N2O Intensity (lb/MW hr)	0.004

1.3 User Entered Comments & Non-Default Data

Project Characteristics -
 Land Use - Total Project area is +/- 15.5 acres
 Construction Phase - Operations run only
 Off-road Equipment - Operations run only

EMFAC Off-Model Adjustment Factors for Gasoline Light Duty Vehicle to Account for the SAFE Vehicle Rule Applied

Perris & Ramona Warehouse (Operations) - Riverside-South Coast County, Annual

EMFAC Off-Model Adjustment Factors for Gasoline Light Duty Vehicle to Account for the SAFE Vehicle Rule Applied

Fleet Mix - Passenger Car Mix estimated based on the CalEEMod default fleet mix and the ratio of the vehicle classes (LDA, LDT1, LDT2, MDV, & MCY). Truck Mix based on information in the Traffic analysis

Table Name	Column Name	Default Value	New Value
tblConstructionPhase	NumDays	20.00	0.00
tblFleetMix	HHD	0.02	0.00
tblFleetMix	HHD	0.02	0.62
tblFleetMix	LDA	0.53	0.56
tblFleetMix	LDA	0.53	0.00
tblFleetMix	LDT1	0.06	0.05
tblFleetMix	LDT1	0.06	0.00
tblFleetMix	LDT2	0.17	0.22
tblFleetMix	LDT2	0.17	0.00
tblFleetMix	LHD1	0.03	0.00
tblFleetMix	LHD1	0.03	0.14
tblFleetMix	LHD2	7.3100e-003	0.00
tblFleetMix	LHD2	7.3100e-003	0.04
tblFleetMix	MCY	0.02	0.02
tblFleetMix	MCY	0.02	0.00
tblFleetMix	MDV	0.14	0.15
tblFleetMix	MDV	0.14	0.00
tblFleetMix	MH	5.4680e-003	0.00
tblFleetMix	MH	5.4680e-003	0.00
tblFleetMix	MHD	0.01	0.00
tblFleetMix	MHD	0.01	0.21
tblFleetMix	OBUS	6.1600e-004	0.00
tblFleetMix	OBUS	6.1600e-004	0.00
tblFleetMix	SBUS	1.1000e-003	0.00
tblFleetMix	SBUS	1.1000e-003	0.00
tblFleetMix	UBUS	3.1500e-004	0.00

Perris & Ramona Warehouse (Operations) - Riverside-South Coast County, Annual

EMFAC Off-Model Adjustment Factors for Gasoline Light Duty Vehicle to Account for the SAFE Vehicle Rule Applied

tblFleetMix	UBUS	3.1500e-004	0.00
tblLandUse	LandUseSquareFeet	85,600.00	58,493.00
tblLandUse	LandUseSquareFeet	94,089.60	94,036.00
tblLandUse	LotAcreage	1.93	1.34
tblOffRoadEquipment	OffRoadEquipmentUnitAmount	1.00	0.00
tblOffRoadEquipment	OffRoadEquipmentUnitAmount	3.00	0.00
tblOffRoadEquipment	OffRoadEquipmentUnitAmount	2.00	0.00
tblOperationalOffRoadEquipment	OperDaysPerYear	260.00	365.00
tblOperationalOffRoadEquipment	OperFuelType	Diesel	CNG
tblOperationalOffRoadEquipment	OperHorsePower	97.00	200.00
tblOperationalOffRoadEquipment	OperHoursPerDay	8.00	4.00
tblOperationalOffRoadEquipment	OperOffRoadEquipmentNumber	0.00	2.00
tblVehicleTrips	CC_TTP	48.00	0.00
tblVehicleTrips	CC_TTP	0.00	100.00
tblVehicleTrips	CC_TTP	0.00	100.00
tblVehicleTrips	CNW_TTP	19.00	0.00
tblVehicleTrips	CNW_TTP	41.00	0.00
tblVehicleTrips	CW_TL	16.60	40.00
tblVehicleTrips	CW_TTP	33.00	0.00
tblVehicleTrips	CW_TTP	59.00	0.00
tblVehicleTrips	DV_TP	28.00	0.00
tblVehicleTrips	DV_TP	21.00	0.00
tblVehicleTrips	DV_TP	40.00	0.00
tblVehicleTrips	DV_TP	5.00	0.00
tblVehicleTrips	PB_TP	6.00	0.00
tblVehicleTrips	PB_TP	3.00	0.00
tblVehicleTrips	PR_TP	66.00	0.00
tblVehicleTrips	PR_TP	29.00	50.00
tblVehicleTrips	PR_TP	45.00	85.00

Perris & Ramona Warehouse (Operations) - Riverside-South Coast County, Annual

EMFAC Off-Model Adjustment Factors for Gasoline Light Duty Vehicle to Account for the SAFE Vehicle Rule Applied

tblVehicleTrips	PR_TP	92.00	100.00
tblVehicleTrips	PR_TP	0.00	100.00
tblVehicleTrips	ST_TR	1.96	0.00
tblVehicleTrips	ST_TR	616.12	276.60
tblVehicleTrips	ST_TR	42.04	43.12
tblVehicleTrips	ST_TR	1.74	0.79
tblVehicleTrips	ST_TR	0.00	0.15
tblVehicleTrips	SU_TR	2.19	0.00
tblVehicleTrips	SU_TR	472.58	212.16
tblVehicleTrips	SU_TR	20.43	33.07
tblVehicleTrips	SU_TR	1.74	0.73
tblVehicleTrips	SU_TR	0.00	0.14
tblVehicleTrips	WD_TR	0.78	0.00
tblVehicleTrips	WD_TR	470.95	209.95
tblVehicleTrips	WD_TR	44.32	32.73
tblVehicleTrips	WD_TR	1.74	1.18
tblVehicleTrips	WD_TR	0.00	0.22

2.0 Emissions Summary

Perris & Ramona Warehouse (Operations) - Riverside-South Coast County, Annual

EMFAC Off-Model Adjustment Factors for Gasoline Light Duty Vehicle to Account for the SAFE Vehicle Rule Applied

2.1 Overall Construction

Unmitigated Construction

	ROG	NOx	CO	SO2	Fugitive PM10	Exhaust PM10	PM10 Total	Fugitive PM2.5	Exhaust PM2.5	PM2.5 Total	Bio- CO2	NBio- CO2	Total CO2	CH4	N2O	CO2e
Year	tons/yr										MT/yr					
2022	0.0000	0.0000	0.0000	0.0000	0.0000	0.0000	0.0000	0.0000	0.0000	0.0000	0.0000	0.0000	0.0000	0.0000	0.0000	0.0000
Maximum	0.0000	0.0000	0.0000	0.0000	0.0000	0.0000	0.0000	0.0000	0.0000	0.0000	0.0000	0.0000	0.0000	0.0000	0.0000	0.0000

Mitigated Construction

	ROG	NOx	CO	SO2	Fugitive PM10	Exhaust PM10	PM10 Total	Fugitive PM2.5	Exhaust PM2.5	PM2.5 Total	Bio- CO2	NBio- CO2	Total CO2	CH4	N2O	CO2e
Year	tons/yr										MT/yr					
2022	0.0000	0.0000	0.0000	0.0000	0.0000	0.0000	0.0000	0.0000	0.0000	0.0000	0.0000	0.0000	0.0000	0.0000	0.0000	0.0000
Maximum	0.0000	0.0000	0.0000	0.0000	0.0000	0.0000	0.0000	0.0000	0.0000	0.0000	0.0000	0.0000	0.0000	0.0000	0.0000	0.0000

	ROG	NOx	CO	SO2	Fugitive PM10	Exhaust PM10	PM10 Total	Fugitive PM2.5	Exhaust PM2.5	PM2.5 Total	Bio- CO2	NBio- CO2	Total CO2	CH4	N2O	CO2e
Percent Reduction	0.00	0.00	0.00	0.00	0.00	0.00	0.00	0.00	0.00	0.00	0.00	0.00	0.00	0.00	0.00	0.00

Quarter	Start Date	End Date	Maximum Unmitigated ROG + NOX (tons/quarter)	Maximum Mitigated ROG + NOX (tons/quarter)

Perris & Ramona Warehouse (Operations) - Riverside-South Coast County, Annual

EMFAC Off-Model Adjustment Factors for Gasoline Light Duty Vehicle to Account for the SAFE Vehicle Rule Applied

		Highest		
--	--	---------	--	--

2.2 Overall Operational

Unmitigated Operational

	ROG	NOx	CO	SO2	Fugitive PM10	Exhaust PM10	PM10 Total	Fugitive PM2.5	Exhaust PM2.5	PM2.5 Total	Bio- CO2	NBio- CO2	Total CO2	CH4	N2O	CO2e
Category	tons/yr										MT/yr					
Area	1.2934	1.2000e-004	0.0133	0.0000		5.0000e-005	5.0000e-005		5.0000e-005	5.0000e-005	0.0000	0.0259	0.0259	7.0000e-005	0.0000	0.0276
Energy	6.3000e-003	0.0573	0.0481	3.4000e-004		4.3500e-003	4.3500e-003		4.3500e-003	4.3500e-003	0.0000	218.3244	218.3244	0.0144	2.7400e-003	219.4995
Mobile	0.4126	0.9207	3.8264	9.8200e-003	0.8918	9.6500e-003	0.9015	0.2387	9.1000e-003	0.2478	0.0000	922.0614	922.0614	0.0455	0.0647	942.4752
Offroad	0.0403	0.3782	0.2735	1.1600e-003		0.0137	0.0137		0.0126	0.0126	0.0000	101.5038	101.5038	0.0328	0.0000	102.3246
Waste						0.0000	0.0000		0.0000	0.0000	63.8874	0.0000	63.8874	3.7756	0.0000	158.2782
Water						0.0000	0.0000		0.0000	0.0000	22.6537	170.4808	193.1344	2.3411	0.0567	268.5547
Total	1.7526	1.3563	4.1613	0.0113	0.8918	0.0278	0.9196	0.2387	0.0261	0.2648	86.5410	1,412.3962	1,498.9373	6.2095	0.1241	1,691.1597

Perris & Ramona Warehouse (Operations) - Riverside-South Coast County, Annual

EMFAC Off-Model Adjustment Factors for Gasoline Light Duty Vehicle to Account for the SAFE Vehicle Rule Applied

2.2 Overall Operational

Mitigated Operational

	ROG	NOx	CO	SO2	Fugitive PM10	Exhaust PM10	PM10 Total	Fugitive PM2.5	Exhaust PM2.5	PM2.5 Total	Bio- CO2	NBio- CO2	Total CO2	CH4	N2O	CO2e
Category	tons/yr										MT/yr					
Area	1.2934	1.2000e-004	0.0133	0.0000		5.0000e-005	5.0000e-005		5.0000e-005	5.0000e-005	0.0000	0.0259	0.0259	7.0000e-005	0.0000	0.0276
Energy	6.3000e-003	0.0573	0.0481	3.4000e-004		4.3500e-003	4.3500e-003		4.3500e-003	4.3500e-003	0.0000	218.3244	218.3244	0.0144	2.7400e-003	219.4995
Mobile	0.4126	0.9207	3.8264	9.8200e-003	0.8918	9.6500e-003	0.9015	0.2387	9.1000e-003	0.2478	0.0000	922.0614	922.0614	0.0455	0.0647	942.4752
Offroad	0.0403	0.3782	0.2735	1.1600e-003		0.0137	0.0137		0.0126	0.0126	0.0000	101.5038	101.5038	0.0328	0.0000	102.3246
Waste						0.0000	0.0000		0.0000	0.0000	63.8874	0.0000	63.8874	3.7756	0.0000	158.2782
Water						0.0000	0.0000		0.0000	0.0000	22.6537	170.4808	193.1344	2.3411	0.0567	268.5547
Total	1.7526	1.3563	4.1613	0.0113	0.8918	0.0278	0.9196	0.2387	0.0261	0.2648	86.5410	1,412.3962	1,498.9373	6.2095	0.1241	1,691.1597

	ROG	NOx	CO	SO2	Fugitive PM10	Exhaust PM10	PM10 Total	Fugitive PM2.5	Exhaust PM2.5	PM2.5 Total	Bio- CO2	NBio-CO2	Total CO2	CH4	N2O	CO2e
Percent Reduction	0.00	0.00	0.00	0.00	0.00	0.00	0.00	0.00	0.00	0.00	0.00	0.00	0.00	0.00	0.00	0.00

3.0 Construction Detail

Construction Phase

Phase Number	Phase Name	Phase Type	Start Date	End Date	Num Days Week	Num Days	Phase Description
1	Demolition	Demolition	11/7/2022	11/6/2022	5	0	

Perris & Ramona Warehouse (Operations) - Riverside-South Coast County, Annual

EMFAC Off-Model Adjustment Factors for Gasoline Light Duty Vehicle to Account for the SAFE Vehicle Rule Applied

Acres of Grading (Site Preparation Phase): 0

Acres of Grading (Grading Phase): 0

Acres of Paving: 6.2

Residential Indoor: 0; Residential Outdoor: 0; Non-Residential Indoor: 0; Non-Residential Outdoor: 0; Striped Parking Area: 0 (Architectural Coating – sqft)

OffRoad Equipment

Phase Name	Offroad Equipment Type	Amount	Usage Hours	Horse Power	Load Factor
Demolition	Concrete/Industrial Saws	0	8.00	81	0.73
Demolition	Excavators	0	8.00	158	0.38
Demolition	Rubber Tired Dozers	0	8.00	247	0.40

Trips and VMT

Phase Name	Offroad Equipment Count	Worker Trip Number	Vendor Trip Number	Hauling Trip Number	Worker Trip Length	Vendor Trip Length	Hauling Trip Length	Worker Vehicle Class	Vendor Vehicle Class	Hauling Vehicle Class
Demolition	0	0.00	0.00	0.00	14.70	6.90	20.00	LD_Mix	HDT_Mix	HHDT

3.1 Mitigation Measures Construction

Perris & Ramona Warehouse (Operations) - Riverside-South Coast County, Annual

EMFAC Off-Model Adjustment Factors for Gasoline Light Duty Vehicle to Account for the SAFE Vehicle Rule Applied

3.2 Demolition - 2022

Mitigated Construction On-Site

	ROG	NOx	CO	SO2	Fugitive PM10	Exhaust PM10	PM10 Total	Fugitive PM2.5	Exhaust PM2.5	PM2.5 Total	Bio- CO2	NBio- CO2	Total CO2	CH4	N2O	CO2e
Category	tons/yr										MT/yr					
Off-Road	0.0000	0.0000	0.0000	0.0000	0.0000	0.0000	0.0000	0.0000	0.0000	0.0000	0.0000	0.0000	0.0000	0.0000	0.0000	0.0000
Total	0.0000	0.0000	0.0000	0.0000	0.0000	0.0000	0.0000	0.0000	0.0000	0.0000	0.0000	0.0000	0.0000	0.0000	0.0000	0.0000

Mitigated Construction Off-Site

	ROG	NOx	CO	SO2	Fugitive PM10	Exhaust PM10	PM10 Total	Fugitive PM2.5	Exhaust PM2.5	PM2.5 Total	Bio- CO2	NBio- CO2	Total CO2	CH4	N2O	CO2e
Category	tons/yr										MT/yr					
Hauling	0.0000	0.0000	0.0000	0.0000	0.0000	0.0000	0.0000	0.0000	0.0000	0.0000	0.0000	0.0000	0.0000	0.0000	0.0000	0.0000
Vendor	0.0000	0.0000	0.0000	0.0000	0.0000	0.0000	0.0000	0.0000	0.0000	0.0000	0.0000	0.0000	0.0000	0.0000	0.0000	0.0000
Worker	0.0000	0.0000	0.0000	0.0000	0.0000	0.0000	0.0000	0.0000	0.0000	0.0000	0.0000	0.0000	0.0000	0.0000	0.0000	0.0000
Total	0.0000	0.0000	0.0000	0.0000	0.0000	0.0000	0.0000	0.0000	0.0000	0.0000	0.0000	0.0000	0.0000	0.0000	0.0000	0.0000

4.0 Operational Detail - Mobile

Perris & Ramona Warehouse (Operations) - Riverside-South Coast County, Annual

EMFAC Off-Model Adjustment Factors for Gasoline Light Duty Vehicle to Account for the SAFE Vehicle Rule Applied

4.1 Mitigation Measures Mobile

	ROG	NOx	CO	SO2	Fugitive PM10	Exhaust PM10	PM10 Total	Fugitive PM2.5	Exhaust PM2.5	PM2.5 Total	Bio- CO2	NBio- CO2	Total CO2	CH4	N2O	CO2e
Category	tons/yr										MT/yr					
Mitigated	0.4126	0.9207	3.8264	9.8200e-003	0.8918	9.6500e-003	0.9015	0.2387	9.1000e-003	0.2478	0.0000	922.0614	922.0614	0.0455	0.0647	942.4752
Unmitigated	0.4126	0.9207	3.8264	9.8200e-003	0.8918	9.6500e-003	0.9015	0.2387	9.1000e-003	0.2478	0.0000	922.0614	922.0614	0.0455	0.0647	942.4752

4.2 Trip Summary Information

Land Use	Average Daily Trip Rate			Unmitigated	Mitigated
	Weekday	Saturday	Sunday	Annual VMT	Annual VMT
City Park	0.00	0.00	0.00		
Fast Food Restaurant with Drive Thru	419.90	553.20	424.32	671,653	671,653
Other Asphalt Surfaces	0.00	0.00	0.00		
Parking Lot	0.00	0.00	0.00		
Strip Mall	162.01	213.44	163.70	498,186	498,186
Unrefrigerated Warehouse-No Rail	359.39	240.61	222.34	987,135	987,135
User Defined Industrial	67.01	45.69	42.64	184,921	184,921
Total	1,008.31	1,052.94	852.99	2,341,895	2,341,895

4.3 Trip Type Information

Land Use	Miles			Trip %			Trip Purpose %		
	H-W or C-W	H-S or C-C	H-O or C-NW	H-W or C-W	H-S or C-C	H-O or C-NW	Primary	Diverted	Pass-by
City Park	16.60	8.40	6.90	0.00	0.00	0.00	0	0	0
Fast Food Restaurant with Drive	16.60	8.40	6.90	2.20	78.80	19.00	50	0	50

Perris & Ramona Warehouse (Operations) - Riverside-South Coast County, Annual

EMFAC Off-Model Adjustment Factors for Gasoline Light Duty Vehicle to Account for the SAFE Vehicle Rule Applied

Land Use	Miles			Trip %			Trip Purpose %		
	H-W or C-W	H-S or C-C	H-O or C-NW	H-W or C-W	H-S or C-C	H-O or C-NW	Primary	Diverted	Pass-by
Other Asphalt Surfaces	16.60	8.40	6.90	0.00	0.00	0.00	0	0	0
Parking Lot	16.60	8.40	6.90	0.00	0.00	0.00	0	0	0
Strip Mall	16.60	8.40	6.90	16.60	64.40	19.00	85	0	15
Unrefrigerated Warehouse-No	40.00	8.40	6.90	0.00	100.00	0.00	100	0	0
User Defined Industrial	16.60	8.40	6.90	0.00	100.00	0.00	100	0	0

4.4 Fleet Mix

Land Use	LDA	LDT1	LDT2	MDV	LHD1	LHD2	MHD	HHD	OBUS	UBUS	MCY	SBUS	MH
City Park	0.534849	0.056022	0.172639	0.141007	0.026597	0.007310	0.011327	0.018693	0.000616	0.000315	0.024057	0.001100	0.005468
Fast Food Restaurant with Drive Thru	0.534849	0.056022	0.172639	0.141007	0.026597	0.007310	0.011327	0.018693	0.000616	0.000315	0.024057	0.001100	0.005468
Other Asphalt Surfaces	0.534849	0.056022	0.172639	0.141007	0.026597	0.007310	0.011327	0.018693	0.000616	0.000315	0.024057	0.001100	0.005468
Parking Lot	0.534849	0.056022	0.172639	0.141007	0.026597	0.007310	0.011327	0.018693	0.000616	0.000315	0.024057	0.001100	0.005468
Strip Mall	0.534849	0.056022	0.172639	0.141007	0.026597	0.007310	0.011327	0.018693	0.000616	0.000315	0.024057	0.001100	0.005468
Unrefrigerated Warehouse-No Rail	0.557600	0.045200	0.221700	0.153000	0.000000	0.000000	0.000000	0.000000	0.000000	0.000000	0.022500	0.000000	0.000000
User Defined Industrial	0.000000	0.000000	0.000000	0.000000	0.137600	0.038900	0.205900	0.617600	0.000000	0.000000	0.000000	0.000000	0.000000

5.0 Energy Detail

Historical Energy Use: N

5.1 Mitigation Measures Energy

Perris & Ramona Warehouse (Operations) - Riverside-South Coast County, Annual

EMFAC Off-Model Adjustment Factors for Gasoline Light Duty Vehicle to Account for the SAFE Vehicle Rule Applied

	ROG	NOx	CO	SO2	Fugitive PM10	Exhaust PM10	PM10 Total	Fugitive PM2.5	Exhaust PM2.5	PM2.5 Total	Bio- CO2	NBio- CO2	Total CO2	CH4	N2O	CO2e
Category	tons/yr										MT/yr					
Electricity Mitigated						0.0000	0.0000		0.0000	0.0000	0.0000	155.9741	155.9741	0.0132	1.6000e-003	156.7787
Electricity Unmitigated						0.0000	0.0000		0.0000	0.0000	0.0000	155.9741	155.9741	0.0132	1.6000e-003	156.7787
NaturalGas Mitigated	6.3000e-003	0.0573	0.0481	3.4000e-004		4.3500e-003	4.3500e-003		4.3500e-003	4.3500e-003	0.0000	62.3503	62.3503	1.2000e-003	1.1400e-003	62.7208
NaturalGas Unmitigated	6.3000e-003	0.0573	0.0481	3.4000e-004		4.3500e-003	4.3500e-003		4.3500e-003	4.3500e-003	0.0000	62.3503	62.3503	1.2000e-003	1.1400e-003	62.7208

Perris & Ramona Warehouse (Operations) - Riverside-South Coast County, Annual

EMFAC Off-Model Adjustment Factors for Gasoline Light Duty Vehicle to Account for the SAFE Vehicle Rule Applied

5.2 Energy by Land Use - NaturalGas

Unmitigated

	NaturalGas Use	ROG	NOx	CO	SO2	Fugitive PM10	Exhaust PM10	PM10 Total	Fugitive PM2.5	Exhaust PM2.5	PM2.5 Total	Bio- CO2	NBio- CO2	Total CO2	CH4	N2O	CO2e
Land Use	kBTU/yr	tons/yr										MT/yr					
City Park	0	0.0000	0.0000	0.0000	0.0000		0.0000	0.0000		0.0000	0.0000	0.0000	0.0000	0.0000	0.0000	0.0000	0.0000
Fast Food Restaurant with Drive Thru	545320	2.9400e-003	0.0267	0.0225	1.6000e-004		2.0300e-003	2.0300e-003		2.0300e-003	2.0300e-003	0.0000	29.1004	29.1004	5.6000e-004	5.3000e-004	29.2733
Other Asphalt Surfaces	0	0.0000	0.0000	0.0000	0.0000		0.0000	0.0000		0.0000	0.0000	0.0000	0.0000	0.0000	0.0000	0.0000	0.0000
Parking Lot	0	0.0000	0.0000	0.0000	0.0000		0.0000	0.0000		0.0000	0.0000	0.0000	0.0000	0.0000	0.0000	0.0000	0.0000
Strip Mall	10890	6.0000e-005	5.3000e-004	4.5000e-004	0.0000		4.0000e-005	4.0000e-005		4.0000e-005	4.0000e-005	0.0000	0.5811	0.5811	1.0000e-005	1.0000e-005	0.5846
Unrefrigerated Warehouse-No Rail	612190	3.3000e-003	0.0300	0.0252	1.8000e-004		2.2800e-003	2.2800e-003		2.2800e-003	2.2800e-003	0.0000	32.6688	32.6688	6.3000e-004	6.0000e-004	32.8629
User Defined Industrial	0	0.0000	0.0000	0.0000	0.0000		0.0000	0.0000		0.0000	0.0000	0.0000	0.0000	0.0000	0.0000	0.0000	0.0000
Total		6.3000e-003	0.0573	0.0481	3.4000e-004		4.3500e-003	4.3500e-003		4.3500e-003	4.3500e-003	0.0000	62.3503	62.3503	1.2000e-003	1.1400e-003	62.7208

Perris & Ramona Warehouse (Operations) - Riverside-South Coast County, Annual

EMFAC Off-Model Adjustment Factors for Gasoline Light Duty Vehicle to Account for the SAFE Vehicle Rule Applied

5.2 Energy by Land Use - NaturalGas

Mitigated

	NaturalGas Use	ROG	NOx	CO	SO2	Fugitive PM10	Exhaust PM10	PM10 Total	Fugitive PM2.5	Exhaust PM2.5	PM2.5 Total	Bio- CO2	NBio- CO2	Total CO2	CH4	N2O	CO2e
Land Use	kBTU/yr	tons/yr										MT/yr					
City Park	0	0.0000	0.0000	0.0000	0.0000		0.0000	0.0000		0.0000	0.0000	0.0000	0.0000	0.0000	0.0000	0.0000	0.0000
Fast Food Restaurant with Drive Thru	545320	2.9400e-003	0.0267	0.0225	1.6000e-004		2.0300e-003	2.0300e-003		2.0300e-003	2.0300e-003	0.0000	29.1004	29.1004	5.6000e-004	5.3000e-004	29.2733
Other Asphalt Surfaces	0	0.0000	0.0000	0.0000	0.0000		0.0000	0.0000		0.0000	0.0000	0.0000	0.0000	0.0000	0.0000	0.0000	0.0000
Parking Lot	0	0.0000	0.0000	0.0000	0.0000		0.0000	0.0000		0.0000	0.0000	0.0000	0.0000	0.0000	0.0000	0.0000	0.0000
Strip Mall	10890	6.0000e-005	5.3000e-004	4.5000e-004	0.0000		4.0000e-005	4.0000e-005		4.0000e-005	4.0000e-005	0.0000	0.5811	0.5811	1.0000e-005	1.0000e-005	0.5846
Unrefrigerated Warehouse-No Rail	612190	3.3000e-003	0.0300	0.0252	1.8000e-004		2.2800e-003	2.2800e-003		2.2800e-003	2.2800e-003	0.0000	32.6688	32.6688	6.3000e-004	6.0000e-004	32.8629
User Defined Industrial	0	0.0000	0.0000	0.0000	0.0000		0.0000	0.0000		0.0000	0.0000	0.0000	0.0000	0.0000	0.0000	0.0000	0.0000
Total		6.3000e-003	0.0573	0.0481	3.4000e-004		4.3500e-003	4.3500e-003		4.3500e-003	4.3500e-003	0.0000	62.3503	62.3503	1.2000e-003	1.1400e-003	62.7208

Perris & Ramona Warehouse (Operations) - Riverside-South Coast County, Annual

EMFAC Off-Model Adjustment Factors for Gasoline Light Duty Vehicle to Account for the SAFE Vehicle Rule Applied

5.3 Energy by Land Use - Electricity

Unmitigated

	Electricity Use	Total CO2	CH4	N2O	CO2e
Land Use	kWh/yr	MT/yr			
City Park	0	0.0000	0.0000	0.0000	0.0000
Fast Food Restaurant with Drive Thru	92320	16.3725	1.3800e-003	1.7000e-004	16.4570
Other Asphalt Surfaces	0	0.0000	0.0000	0.0000	0.0000
Parking Lot	20472.5	3.6307	3.1000e-004	4.0000e-005	3.6495
Strip Mall	60093	10.6572	9.0000e-004	1.1000e-004	10.7122
Unrefrigerated Warehouse-No Rail	706607	125.3136	0.0106	1.2800e-003	125.9601
User Defined Industrial	0	0.0000	0.0000	0.0000	0.0000
Total		155.9741	0.0132	1.6000e-003	156.7787

Perris & Ramona Warehouse (Operations) - Riverside-South Coast County, Annual

EMFAC Off-Model Adjustment Factors for Gasoline Light Duty Vehicle to Account for the SAFE Vehicle Rule Applied

5.3 Energy by Land Use - Electricity

Mitigated

	Electricity Use	Total CO2	CH4	N2O	CO2e
Land Use	kWh/yr	MT/yr			
City Park	0	0.0000	0.0000	0.0000	0.0000
Fast Food Restaurant with Drive Thru	92320	16.3725	1.3800e-003	1.7000e-004	16.4570
Other Asphalt Surfaces	0	0.0000	0.0000	0.0000	0.0000
Parking Lot	20472.5	3.6307	3.1000e-004	4.0000e-005	3.6495
Strip Mall	60093	10.6572	9.0000e-004	1.1000e-004	10.7122
Unrefrigerated Warehouse-No Rail	706607	125.3136	0.0106	1.2800e-003	125.9601
User Defined Industrial	0	0.0000	0.0000	0.0000	0.0000
Total		155.9741	0.0132	1.6000e-003	156.7787

6.0 Area Detail

6.1 Mitigation Measures Area

Perris & Ramona Warehouse (Operations) - Riverside-South Coast County, Annual

EMFAC Off-Model Adjustment Factors for Gasoline Light Duty Vehicle to Account for the SAFE Vehicle Rule Applied

	ROG	NOx	CO	SO2	Fugitive PM10	Exhaust PM10	PM10 Total	Fugitive PM2.5	Exhaust PM2.5	PM2.5 Total	Bio- CO2	NBio- CO2	Total CO2	CH4	N2O	CO2e
Category	tons/yr										MT/yr					
Mitigated	1.2934	1.2000e-004	0.0133	0.0000		5.0000e-005	5.0000e-005		5.0000e-005	5.0000e-005	0.0000	0.0259	0.0259	7.0000e-005	0.0000	0.0276
Unmitigated	1.2934	1.2000e-004	0.0133	0.0000		5.0000e-005	5.0000e-005		5.0000e-005	5.0000e-005	0.0000	0.0259	0.0259	7.0000e-005	0.0000	0.0276

6.2 Area by SubCategory

Unmitigated

	ROG	NOx	CO	SO2	Fugitive PM10	Exhaust PM10	PM10 Total	Fugitive PM2.5	Exhaust PM2.5	PM2.5 Total	Bio- CO2	NBio- CO2	Total CO2	CH4	N2O	CO2e
SubCategory	tons/yr										MT/yr					
Architectural Coating	0.1482					0.0000	0.0000		0.0000	0.0000	0.0000	0.0000	0.0000	0.0000	0.0000	0.0000
Consumer Products	1.1440					0.0000	0.0000		0.0000	0.0000	0.0000	0.0000	0.0000	0.0000	0.0000	0.0000
Landscaping	1.2300e-003	1.2000e-004	0.0133	0.0000		5.0000e-005	5.0000e-005		5.0000e-005	5.0000e-005	0.0000	0.0259	0.0259	7.0000e-005	0.0000	0.0276
Total	1.2934	1.2000e-004	0.0133	0.0000		5.0000e-005	5.0000e-005		5.0000e-005	5.0000e-005	0.0000	0.0259	0.0259	7.0000e-005	0.0000	0.0276

Perris & Ramona Warehouse (Operations) - Riverside-South Coast County, Annual

EMFAC Off-Model Adjustment Factors for Gasoline Light Duty Vehicle to Account for the SAFE Vehicle Rule Applied

6.2 Area by SubCategory

Mitigated

	ROG	NOx	CO	SO2	Fugitive PM10	Exhaust PM10	PM10 Total	Fugitive PM2.5	Exhaust PM2.5	PM2.5 Total	Bio- CO2	NBio- CO2	Total CO2	CH4	N2O	CO2e
SubCategory	tons/yr										MT/yr					
Architectural Coating	0.1482					0.0000	0.0000		0.0000	0.0000	0.0000	0.0000	0.0000	0.0000	0.0000	0.0000
Consumer Products	1.1440					0.0000	0.0000		0.0000	0.0000	0.0000	0.0000	0.0000	0.0000	0.0000	0.0000
Landscaping	1.2300e-003	1.2000e-004	0.0133	0.0000		5.0000e-005	5.0000e-005		5.0000e-005	5.0000e-005	0.0000	0.0259	0.0259	7.0000e-005	0.0000	0.0276
Total	1.2934	1.2000e-004	0.0133	0.0000		5.0000e-005	5.0000e-005		5.0000e-005	5.0000e-005	0.0000	0.0259	0.0259	7.0000e-005	0.0000	0.0276

7.0 Water Detail

7.1 Mitigation Measures Water

Perris & Ramona Warehouse (Operations) - Riverside-South Coast County, Annual

EMFAC Off-Model Adjustment Factors for Gasoline Light Duty Vehicle to Account for the SAFE Vehicle Rule Applied

	Total CO2	CH4	N2O	CO2e
Category	MT/yr			
Mitigated	193.1344	2.3411	0.0567	268.5547
Unmitigated	193.1344	2.3411	0.0567	268.5547

Perris & Ramona Warehouse (Operations) - Riverside-South Coast County, Annual

EMFAC Off-Model Adjustment Factors for Gasoline Light Duty Vehicle to Account for the SAFE Vehicle Rule Applied

7.2 Water by Land Use

Unmitigated

	Indoor/Outdoor Use	Total CO2	CH4	N2O	CO2e
Land Use	Mgal	MT/yr			
City Park	0 / 2.5736	5.0708	4.3000e-004	5.0000e-005	5.0970
Fast Food Restaurant with Drive Thru	0.607067 / 0.038749	1.6708	0.0199	4.8000e-004	2.3121
Other Asphalt Surfaces	0 / 0	0.0000	0.0000	0.0000	0.0000
Parking Lot	0 / 0	0.0000	0.0000	0.0000	0.0000
Strip Mall	0.366659 / 0.224726	1.4058	0.0121	3.0000e-004	1.7952
Unrefrigerated Warehouse-No Rail	70.4318 / 0	184.9871	2.3088	0.0559	259.3504
User Defined Industrial	0 / 0	0.0000	0.0000	0.0000	0.0000
Total		193.1344	2.3412	0.0567	268.5547

Perris & Ramona Warehouse (Operations) - Riverside-South Coast County, Annual

EMFAC Off-Model Adjustment Factors for Gasoline Light Duty Vehicle to Account for the SAFE Vehicle Rule Applied

7.2 Water by Land Use

Mitigated

	Indoor/Outdoor Use	Total CO2	CH4	N2O	CO2e
Land Use	Mgal	MT/yr			
City Park	0 / 2.5736	5.0708	4.3000e-004	5.0000e-005	5.0970
Fast Food Restaurant with Drive Thru	0.607067 / 0.038749	1.6708	0.0199	4.8000e-004	2.3121
Other Asphalt Surfaces	0 / 0	0.0000	0.0000	0.0000	0.0000
Parking Lot	0 / 0	0.0000	0.0000	0.0000	0.0000
Strip Mall	0.366659 / 0.224726	1.4058	0.0121	3.0000e-004	1.7952
Unrefrigerated Warehouse-No Rail	70.4318 / 0	184.9871	2.3088	0.0559	259.3504
User Defined Industrial	0 / 0	0.0000	0.0000	0.0000	0.0000
Total		193.1344	2.3412	0.0567	268.5547

8.0 Waste Detail

8.1 Mitigation Measures Waste

Perris & Ramona Warehouse (Operations) - Riverside-South Coast County, Annual

EMFAC Off-Model Adjustment Factors for Gasoline Light Duty Vehicle to Account for the SAFE Vehicle Rule Applied

Category/Year

	Total CO2	CH4	N2O	CO2e
	MT/yr			
Mitigated	63.8874	3.7756	0.0000	158.2782
Unmitigated	63.8874	3.7756	0.0000	158.2782

Perris & Ramona Warehouse (Operations) - Riverside-South Coast County, Annual

EMFAC Off-Model Adjustment Factors for Gasoline Light Duty Vehicle to Account for the SAFE Vehicle Rule Applied

8.2 Waste by Land Use

Unmitigated

	Waste Disposed	Total CO2	CH4	N2O	CO2e
Land Use	tons	MT/yr			
City Park	0.19	0.0386	2.2800e-003	0.0000	0.0956
Fast Food Restaurant with Drive Thru	23.04	4.6769	0.2764	0.0000	11.5869
Other Asphalt Surfaces	0	0.0000	0.0000	0.0000	0.0000
Parking Lot	0	0.0000	0.0000	0.0000	0.0000
Strip Mall	5.2	1.0556	0.0624	0.0000	2.6151
Unrefrigerated Warehouse-No Rail	286.3	58.1163	3.4346	0.0000	143.9807
User Defined Industrial	0	0.0000	0.0000	0.0000	0.0000
Total		63.8873	3.7756	0.0000	158.2782

Perris & Ramona Warehouse (Operations) - Riverside-South Coast County, Annual

EMFAC Off-Model Adjustment Factors for Gasoline Light Duty Vehicle to Account for the SAFE Vehicle Rule Applied

8.2 Waste by Land Use

Mitigated

	Waste Disposed	Total CO2	CH4	N2O	CO2e
Land Use	tons	MT/yr			
City Park	0.19	0.0386	2.2800e-003	0.0000	0.0956
Fast Food Restaurant with Drive Thru	23.04	4.6769	0.2764	0.0000	11.5869
Other Asphalt Surfaces	0	0.0000	0.0000	0.0000	0.0000
Parking Lot	0	0.0000	0.0000	0.0000	0.0000
Strip Mall	5.2	1.0556	0.0624	0.0000	2.6151
Unrefrigerated Warehouse-No Rail	286.3	58.1163	3.4346	0.0000	143.9807
User Defined Industrial	0	0.0000	0.0000	0.0000	0.0000
Total		63.8873	3.7756	0.0000	158.2782

9.0 Operational Offroad

Equipment Type	Number	Hours/Day	Days/Year	Horse Power	Load Factor	Fuel Type
Tractors/Loaders/Backhoes	2	4.00	365	200	0.37	CNG

Perris & Ramona Warehouse (Operations) - Riverside-South Coast County, Annual

EMFAC Off-Model Adjustment Factors for Gasoline Light Duty Vehicle to Account for the SAFE Vehicle Rule Applied

UnMitigated/Mitigated

	ROG	NOx	CO	SO2	Fugitive PM10	Exhaust PM10	PM10 Total	Fugitive PM2.5	Exhaust PM2.5	PM2.5 Total	Bio- CO2	NBio- CO2	Total CO2	CH4	N2O	CO2e
Equipment Type	tons/yr										MT/yr					
Tractors/Loaders/Backhoes	0.0403	0.3782	0.2735	1.1600e-003		0.0137	0.0137		0.0126	0.0126	0.0000	101.5038	101.5038	0.0328	0.0000	102.3246
Total	0.0403	0.3782	0.2735	1.1600e-003		0.0137	0.0137		0.0126	0.0126	0.0000	101.5038	101.5038	0.0328	0.0000	102.3246

10.0 Stationary Equipment

Fire Pumps and Emergency Generators

Equipment Type	Number	Hours/Day	Hours/Year	Horse Power	Load Factor	Fuel Type
----------------	--------	-----------	------------	-------------	-------------	-----------

Boilers

Equipment Type	Number	Heat Input/Day	Heat Input/Year	Boiler Rating	Fuel Type
----------------	--------	----------------	-----------------	---------------	-----------

User Defined Equipment

Equipment Type	Number
----------------	--------

11.0 Vegetation

ATTACHMENT B
EMFAC2017

Source: EMFAC2017 (v1.0.3) Emissions Inventory

Region Type: Sub-Area

Region: Riverside (SC)

Calendar Year: 2022

Season: Annual

Vehicle Classification: EMFAC2007 Categories

Units: miles/year for VMT, trips/year for Trips, tons/year for Emissions, 1000 gallons/year for Fuel Consumption

Region	CalYr	VehClass	MdYr	Speed	Fuel	Population	VMT	Fuel_Consumption	Fuel_Consumption	Total Fuel	VMT	Total VMT	Miles per Gallon	Vehicle Class
Riverside (SC)	2022	HHDT	Aggregate	Aggregate	Gasoline	6.576938112	153457.8614	36.38308143	36383.08143	86338603.49	153457.8614	609730316.4	7.06	HHDT
Riverside (SC)	2022	HHDT	Aggregate	Aggregate	Diesel	15714.36952	606232799.9	84894.0389	84894038.9		606232799.9			
Riverside (SC)	2022	HHDT	Aggregate	Aggregate	Natural Gas	263.7933161	3344058.656	1408.18151	1408181.51		3344058.656			
Riverside (SC)	2022	LDA	Aggregate	Aggregate	Gasoline	581991.6725	8224182944	255876.5259	255876525.9	257472567.5		8437175826	32.77	LDA
Riverside (SC)	2022	LDA	Aggregate	Aggregate	Diesel	5627.648407	83145410.99	1596.041638	1596041.638		83145410.99			
Riverside (SC)	2022	LDA	Aggregate	Aggregate	Electricity	9519.079074	129847470.9	0	0		129847470.9			
Riverside (SC)	2022	LDT1	Aggregate	Aggregate	Gasoline	60037.51621	784889608.4	28670.08786	28670087.86	28678196.65	784889608.4	790148273.6	27.55	LDT1
Riverside (SC)	2022	LDT1	Aggregate	Aggregate	Diesel	27.76404389	208778.8044	8.108788608	8108.788608		208778.8044			
Riverside (SC)	2022	LDT1	Aggregate	Aggregate	Electricity	356.2042589	5049886.408	0	0		5049886.408			
Riverside (SC)	2022	LDT2	Aggregate	Aggregate	Gasoline	182118.8677	2486397650	96428.35184	96428351.84	96853535.07	2486397650	2521171664	26.03	LDT2
Riverside (SC)	2022	LDT2	Aggregate	Aggregate	Diesel	1054.483634	16665909.69	425.1832295	425183.2295		16665909.69			
Riverside (SC)	2022	LDT2	Aggregate	Aggregate	Electricity	1677.633962	18108104.13	0	0		18108104.13			
Riverside (SC)	2022	LHDT1	Aggregate	Aggregate	Gasoline	15417.55767	163201148.4	15108.11893	15108118.93	23387437.93	163201148.4	336574881.3	14.39	LHDT1
Riverside (SC)	2022	LHDT1	Aggregate	Aggregate	Diesel	15837.49513	173373732.9	8279.318992	8279318.992		173373732.9			
Riverside (SC)	2022	LHDT2	Aggregate	Aggregate	Gasoline	2252.42518	24026208.75	2542.009363	2542009.363	6051733.364	24026208.75	91253583.76	15.08	LHDT2
Riverside (SC)	2022	LHDT2	Aggregate	Aggregate	Diesel	6123.275766	67227375.01	3509.724001	3509724.001		67227375.01			
Riverside (SC)	2022	MCY	Aggregate	Aggregate	Gasoline	28171.90267	62796448.34	1655.586212	1655586.212	1655586.212	62796448.34	62796448.34	37.93	MCY
Riverside (SC)	2022	MDV	Aggregate	Aggregate	Gasoline	154199.5457	1942294285	94789.21819	94789218.19	96446076.25	1942294285	2000039012	20.74	MDV
Riverside (SC)	2022	MDV	Aggregate	Aggregate	Diesel	3261.4865	47596581.84	1656.858052	1656858.052		47596581.84			
Riverside (SC)	2022	MDV	Aggregate	Aggregate	Electricity	916.717804	10148145.12	0	0		10148145.12			
Riverside (SC)	2022	MH	Aggregate	Aggregate	Gasoline	4849.122996	12414677.16	2406.257705	2406257.705	2875800.063	12414677.16	17521753.84	6.09	MH
Riverside (SC)	2022	MH	Aggregate	Aggregate	Diesel	1986.085476	5107076.677	469.5423575	469542.3575		5107076.677			
Riverside (SC)	2022	MHDT	Aggregate	Aggregate	Gasoline	1326.926938	17674320.91	3359.446933	3359446.933	24049505.3	17674320.91	248635402	10.34	MHDT
Riverside (SC)	2022	MHDT	Aggregate	Aggregate	Diesel	11907.6705	230961081.1	20690.05836	20690058.36		230961081.1			
Riverside (SC)	2022	OBUS	Aggregate	Aggregate	Gasoline	438.8357563	4993518.807	967.2190429	967219.0429	1483181.022	4993518.807	9603790.146	6.48	OBUS
Riverside (SC)	2022	OBUS	Aggregate	Aggregate	Diesel	222.2197269	4610271.339	515.9619792	515961.9792		4610271.339			
Riverside (SC)	2022	SBUS	Aggregate	Aggregate	Gasoline	417.9532809	4815312.165	544.2910283	544291.0283	1708055.084	4815312.165	13640990.38	7.99	SBUS
Riverside (SC)	2022	SBUS	Aggregate	Aggregate	Diesel	852.548169	8825678.217	1163.764056	1163764.056		8825678.217			
Riverside (SC)	2022	UBUS	Aggregate	Aggregate	Gasoline	164.4551683	7571499.764	1228.231474	1228231.474	3307606.769	7571499.764	16372886.42	4.95	UBUS
Riverside (SC)	2022	UBUS	Aggregate	Aggregate	Diesel	1.105797941	19153.01246	2.147195041	2147.195041		19153.01246			
Riverside (SC)	2022	UBUS	Aggregate	Aggregate	Electricity	0.058469431	409.3068597	0	0		409.3068597			
Riverside (SC)	2022	UBUS	Aggregate	Aggregate	Natural Gas	204.1188773	8781824.334	2077.2281	2077228.1		8781824.334			

Source: EMFAC2017 (v1.0.3) Emissions Inventory

Region Type: Sub-Area

Region: Riverside (SC)

Calendar Year: 2023

Season: Annual

Vehicle Classification: EMFAC2007 Categories

Units: miles/year for VMT, trips/year for Trips, tons/year for Emissions, 1000 gallons/year for Fuel Consumption

Region	CalYr	VehClass	MdYr	Speed	Fuel	Population	VMT	Fuel_Consumption	Fuel_Consumption	Total Fuel	VMT	Total VMT	Miles per Gallon	Vehicle Class
Riverside (SC)	2023	HHDT	Aggregate	Aggregate	Gasoline	6.287048944	153937.6255	35.55040317	35550.40317	83956073.71	153937.6255	624266409.2	7.44	HHDT
Riverside (SC)	2023	HHDT	Aggregate	Aggregate	Diesel	15994.29576	620335254.9	82353.42203	82353422.03		620335254.9			
Riverside (SC)	2023	HHDT	Aggregate	Aggregate	Natural Gas	297.8339277	3777216.619	1567.101271	1567101.271		3777216.619			
Riverside (SC)	2023	LDA	Aggregate	Aggregate	Gasoline	600073.2625	8365084572	253390.156	253390156	255027967.5	8365084572	8616394452	33.79	LDA
Riverside (SC)	2023	LDA	Aggregate	Aggregate	Diesel	6022.455725	87471276.92	1637.811474	1637811.474		87471276.92			
Riverside (SC)	2023	LDA	Aggregate	Aggregate	Electricity	11812.58063	163838603.3	0	0		163838603.3			
Riverside (SC)	2023	LDT1	Aggregate	Aggregate	Gasoline	61620.9911	799977533.2	28439.50607	28439506.07	28446990.16	799977533.2	807387761	28.38	LDT1
Riverside (SC)	2023	LDT1	Aggregate	Aggregate	Diesel	25.82294405	195899.1133	7.484089094	7484.089094		195899.1133			
Riverside (SC)	2023	LDT1	Aggregate	Aggregate	Electricity	500.2265064	7214328.719	0	0		7214328.719			
Riverside (SC)	2023	LDT2	Aggregate	Aggregate	Gasoline	186844.1926	2523160631	94460.38646	94460386.46	94911274.58	2523160631	2564584260	27.02	LDT2
Riverside (SC)	2023	LDT2	Aggregate	Aggregate	Diesel	1179.189513	18179036.69	450.888116	450888.116		18179036.69			
Riverside (SC)	2023	LDT2	Aggregate	Aggregate	Electricity	2202.047417	23244591.93	0	0		23244591.93			
Riverside (SC)	2023	LHDT1	Aggregate	Aggregate	Gasoline	15202.19219	160036544.4	14645.65687	14645656.87	22712976.52	160036544.4	331139011.1	14.58	LHDT1
Riverside (SC)	2023	LHDT1	Aggregate	Aggregate	Diesel	15878.17916	171102466.7	8067.31965	8067319.65		171102466.7			
Riverside (SC)	2023	LHDT2	Aggregate	Aggregate	Gasoline	2254.447347	23819917.55	2491.847218	2491847.218	5925383.012	23819917.55	90400247.11	15.26	LHDT2
Riverside (SC)	2023	LHDT2	Aggregate	Aggregate	Diesel	6182.746468	66580329.56	3433.535795	3433535.795		66580329.56			
Riverside (SC)	2023	MCY	Aggregate	Aggregate	Gasoline	28475.24545	62139045.86	1639.73057	1639730.57	1639730.57	62139045.86	62139045.86	37.90	MCY
Riverside (SC)	2023	MDV	Aggregate	Aggregate	Gasoline	154204.1049	1919857377	90781.78682	90781786.82	92469161.97	1919857377	1983892786	21.45	MDV
Riverside (SC)	2023	MDV	Aggregate	Aggregate	Diesel	3492.231312	49837792.99	1687.375147	1687375.147		49837792.99			
Riverside (SC)	2023	MDV	Aggregate	Aggregate	Electricity	1314.447545	14197616.87	0	0		14197616.87			
Riverside (SC)	2023	MH	Aggregate	Aggregate	Gasoline	4646.002839	11786716.04	2262.850071	2262850.071	2716664.402	11786716.04	16757390.07	6.17	MH
Riverside (SC)	2023	MH	Aggregate	Aggregate	Diesel	1979.944695	4970674.029	453.8143312	453814.3312		4970674.029			
Riverside (SC)	2023	MHDT	Aggregate	Aggregate	Gasoline	1361.919314	18155961.42	3400.73407	3400734.07	23439444.62	18155961.42	251707089.5	10.74	MHDT
Riverside (SC)	2023	MHDT	Aggregate	Aggregate	Diesel	11600.10675	233551128.1	20038.71055	20038710.55		233551128.1			
Riverside (SC)	2023	OBUS	Aggregate	Aggregate	Gasoline	437.8068702	4892382.41	934.9605215	934960.5215	1447125.767	4892382.41	9596664.79	6.63	OBUS
Riverside (SC)	2023	OBUS	Aggregate	Aggregate	Diesel	221.7033657	4704282.38	512.1652457	512165.2457		4704282.38			
Riverside (SC)	2023	SBUS	Aggregate	Aggregate	Gasoline	428.8888994	4875379.461	549.2707658	549270.7658	1727264.498	4875379.461	13916051.77	8.06	SBUS
Riverside (SC)	2023	SBUS	Aggregate	Aggregate	Diesel	872.8772386	9040672.31	1177.993732	1177993.732		9040672.31			
Riverside (SC)	2023	UBUS	Aggregate	Aggregate	Gasoline	165.4254964	7616173.577	1224.574262	1224574.262	3317084.96	7616173.577	16469490.69	4.97	UBUS
Riverside (SC)	2023	UBUS	Aggregate	Aggregate	Diesel	0.141961099	3818.605614	0.410265377	410.2653772		3818.605614			
Riverside (SC)	2023	UBUS	Aggregate	Aggregate	Electricity	0.058469431	409.3068597	0	0		409.3068597			
Riverside (SC)	2023	UBUS	Aggregate	Aggregate	Natural Gas	206.2939379	8849089.206	2092.100433	2092100.433		8849089.206			